

NOTES:
 1. FENCES AS SHOWN
 2. SANITARY ESMT. AND USE AGREEMENT PER H.C.C.F. NO.(5) K029477

ALL BEARINGS BASED ON RECORDED PLAT
 FLOOD ZONE DETERMINED BY GRAPHIC PLOTTING ONLY. WE DO NOT ASSUME RESPONSIBILITY FOR EXACT DETERMINATION.
 THIS SURVEY HAS BEEN COMPILED IN ACCORDANCE WITH INFORMATION CONTAINED IN THE TITLE COMMITMENT REFERENCED IN GF NO.:

9634750

LOT: 2-7	BLOCK: 2	SECTION: 1	SUBDIVISION: VILLAGE OF NEW KENTUCKY	This lot <u>DOES NOT</u> lie in the 100 year flood plain and is in <u>ZONE X</u> as located by the Federal Insurance Administration designated Flood Hazard Area by Community Panel No. <u>48201C0035G</u> dated <u>9/28/90</u>
RECORDATION: VOL. 335, PG. 36 M.R.H.C.	COUNTY: HARRIS	STATE: TEXAS	SURVEY:	JOB NO. 9610318
LENDER: COUNTRYWIDE FUNDING	TITLE CO.: COMMONWEALTH LAND TITLE			
PURCHASER: KIRBY G. GRIFFIN AND WIFE, JOSEPHINE GRIFFIN	ADDRESS: 20231 NEW KENTUCKY VILLAGE, HOCKLEY, TEXAS, 77447			

FIELD WORK	11/12/96-B5
DRAFTED BY	11/13/96-JH
CHECKED BY	11/13/96-JH
KEY MAP NO.	285M
REVISIONS	

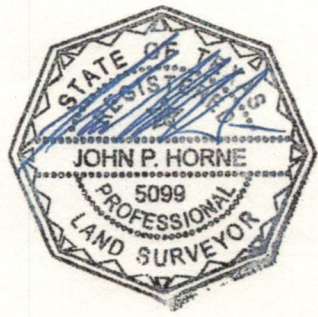

I, John P. Horne, a Registered Professional Surveyor in the State of Texas: hereby certify that this plat was made from an actual survey on the ground by me or under my direction; that no encroachments exist at the time of this survey unless reflected hereon; that said survey conforms to the current Texas Board of Professional Land Surveying Standards and Specifications.

HLS
Horne Land Surveying, L.L.C.
 16760 Hedgcroft, Suite 608
 Houston, Tx 77060
 (Office) 713 445-4100 (Fax) 713 445-4131