



Westside Inspections & Engineering Corp.

Texas P.E. Firm Registration F-3168

P.O. Box 1075
Katy, Texas 77492
Phone (281) 347-3585
westsideinspections.com

RE: FOUNDATION INSPECTION

DATE: January 28, 2020

238 SCHLEY
Richwood, Texas 77531

CLIENT: AAA Reliable Home Buyers

PURPOSE

In accordance with instructions, I made a visual only foundation inspection of the above referenced house following the installation of foundation repairs. This evaluation is based on the American Society of Civil Engineers Guidelines for the Evaluation and Repair of Residential Foundations (version 1), for a Level B investigation.

The foundation repairs were recently completed with this inspector providing a review of the final repair work by the Contractor. This inspection after repair work was provided on January 28, 2020. Please note that this inspector is independent from the Owner selected Repair Contractor.

The purpose of this inspection was to:

- 1) Review the final repair work plan and the completed foundation repairs, and provide any comments concerning the work.
- 2) Provide an opinion as to whether or not the repaired foundation is performing the intended and designed purpose, or if further repairs may be required.

From observations, the repairs inspected were provided by the selected Repair Contractor. In total, the work included the installation of perimeter exterior pilings and 2 interior pilings as summarized on the attached sketch, SK-1.

DESCRIPTION & DATA

The residence inspected had the following noted characteristics:

1. The residence is a single-family residence estimated to be approximately 43 years old.
2. Foundation appeared to be a reinforced concrete slab on grade type.
3. Residence is a one-story wood framed structure with primarily a brick exterior veneer with areas of wood type siding veneers.
4. Framed structure is primarily a gable and hip framing configuration with a roof that was covered with composition shingles.
5. Residence was a 3 bedroom and 2-bathroom layout with a 2-car attached garage.
6. Interior floors were partially covered with carpet and tile materials. Interior walls/ceilings were primarily painted and textured sheetrock materials.
7. Residence was occupied at the time of inspection with storage and personal items noted.
8. The weather conditions were cloudy skies with mild temperatures.

SUMMARY OF OBSERVATIONS

After the piling installations and foundation releveling were completed by the contractor, this inspector noted the following conditions:

1. Exterior reviews indicated no significant trim or siding separations.
2. No significant mortar cracks noted with minor width cracks only noted.
3. Interior conditions were reviewed. These reviews indicated sheetrock cracks and trim separations which are typical following foundation releveling work.

Included in the inspection was a random floor elevation survey, which was performed using a Compu level instrument, with the summary of this survey indicated on the attached sketch, SK-1. From these measurements the following was noted:

- 1) Elevations indicate proper floor levels have been provided.

CONCLUSIONS

From observations and measurements of these repairs on January 28, 2020 this inspector is of the opinion that the foundation repairs were satisfactorily completed by the Repair Contractor, and that the repaired foundation has been properly relevelled and is performing the intended and designed purpose, with no further foundation repairs needed.

CERTIFICATION

I hereby certify that I did the inspection of the foundation repairs of the residence located at 238 Schley; Richwood, Texas on January 28, 2020 and that I have properly reported my measurements and conclusions based upon my observations and my experience. I further certify that the information contained herein is based upon visible evidence only. This inspection, observations, findings, conclusions and recommendations applies to the foundation only. No responsibility is assumed for any other inspections and their subsequent possible adverse effects relative to this residence. Please note that this inspection is not a warranty of the work performed by the selected Contractor. Only the Repair Contractor can provide warranties for the work performed.

Very truly yours,

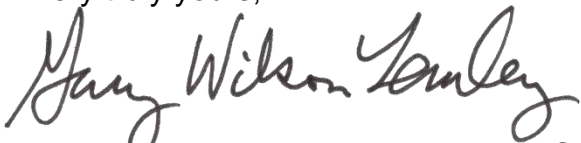

Westside Inspections & Engineering Corp
Gary Wilson Lemley
Licensed Professional Engineer
Texas License No. 45987
Firm F-3168



January 28, 2020

The seal appearing on this document was authorized by Gary Wilson Lemley, P.E. 45987 on January 28, 2020. Alteration of a sealed document without proper notification of the responsible engineer is an offense under the Texas Engineering Practice Act.

Attachment SK-1

- OR Compu Level zero elevation
- 0.7 Elevation Reading (inches)
- Installed Exterior Piling Location
- Installed Interior Piling Location

Note:
Information is intended to only show
summary of observations, and estimated
trends and conditions.

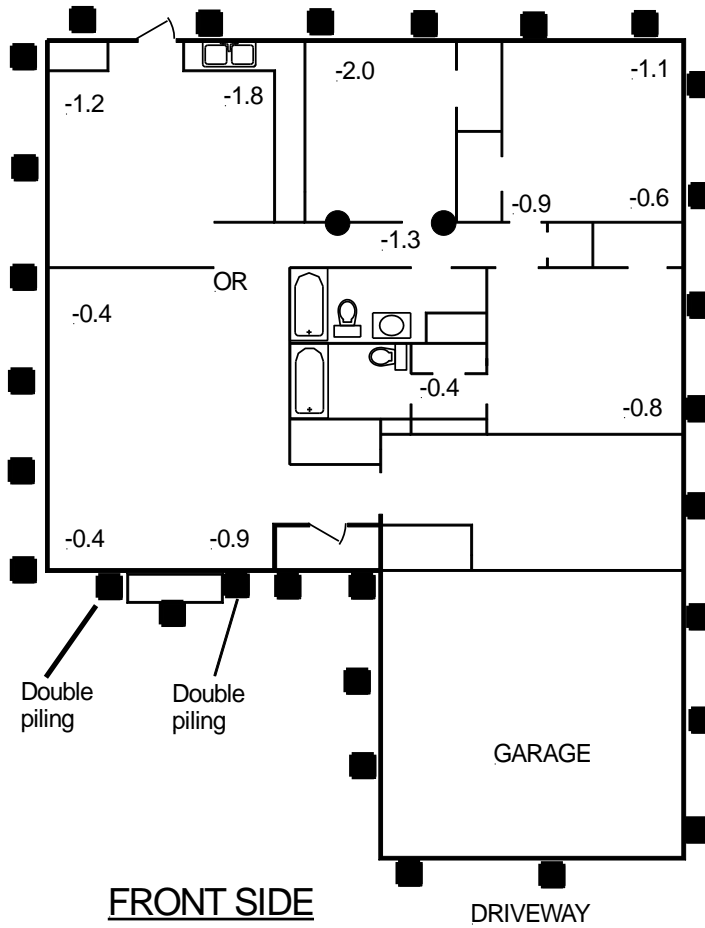

238 Schley	DATE: 1/28/20
Westside Inspections & Engineering Corp. P.O. BOX 1075 KATY, TX. 77492 (281)347-3585	SKETCH SK-1