

HIGH MEADOW RANCH
SECTION SEVENTEEN
CABINET U, SHEET 169
M.C.P.R.



BLOCK 4

LOT 2

LOT 1

8' UTILITY EASEMENT
W/7' AERIAL EASEMENT
PER PLAT

FND. 5/8" I.R.
W/MOYER CAP

N 16°45'28" W 141.23'

FND. 5/8" I.R.
W/MOYER CAP

10' BUILDING LINE
PER PLAT

8' BUILDING LINE
UTILITY EASEMENT
& AERIAL EASEMENT
PER PLAT

BLOCK 1

8' BUILDING LINE
UTILITY EASEMENT
& AERIAL EASEMENT
PER PLAT

N 73°14'32" E 320.00'

LOT 9

S 73°14'32" W 320.00'

LOT 8

LOT 7

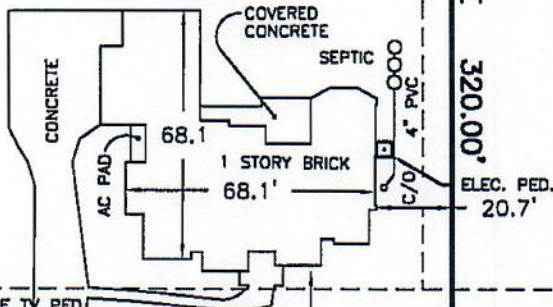

100' BUILDING LINE
PER PLAT

ELEC. PED. □ CABLE TV PED. □

10' UTILITY EASEMENT
PER PLAT

4' UTILITY EASEMENT
M.C.C.F. NO. 2005-087143

105.1'

10' UTILITY EASEMENT
PER PLAT

141.28' (141.23') FND. 5/8" I.R.
W/MOYER CAP

141.43' (141.23')

FND. 5/8" I.R.
W/MOYER CAP

MAILBOX □

S 16°45'28" E 141.23'

TRACT SUBJECT TO EASEMENT FOR UNDERGROUND
ELECTRICAL DISTRIBUTION, M.C.C.F. NO. 2005-093138

SHIRLEY MEADOW
(60' R.O.W.)

TRACT SUBJECT TO DRAINAGE EASEMENT 15 FEET WIDE ON
EACH SIDE OF THE CENTERLINE OF ALL NATURAL DRAINAGE
COURSES PER PLAT.

STEWART TITLE GUARANTY COMPANY
FILE NO. 1133930761
OCTOBER 11, 2011

PLAT OF SURVEY