

Building Sketch (Page - 1)

Borrower/Client	Anna Harrison						
Property Address	18203 Kitzman Rd						
City	Cypress	County	Harris	State	TX	Zip Code	77429
Lender							

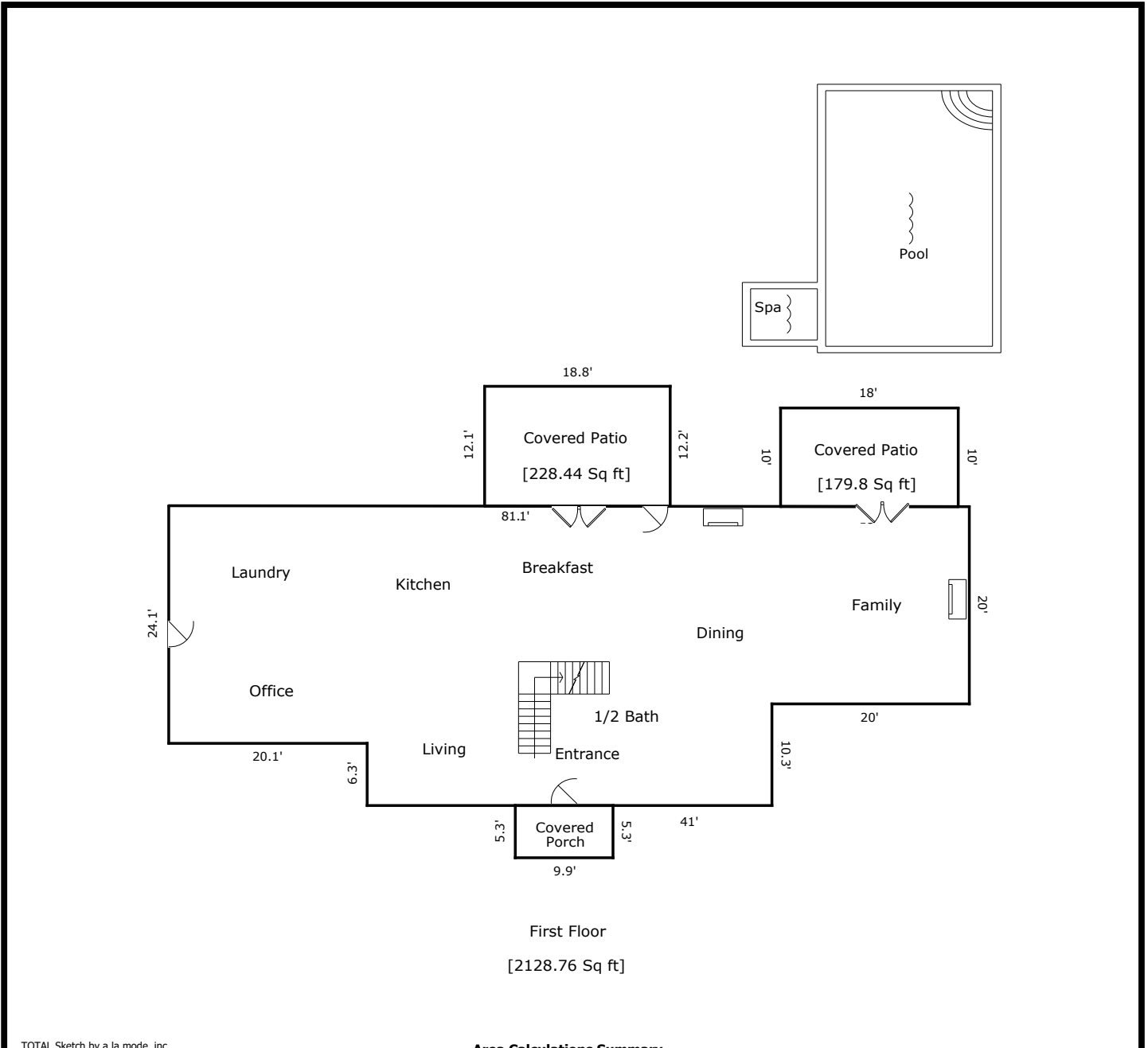

TOTAL Sketch by a la mode, inc.

Area Calculations Summary

Living Area	Calculation Details		
First Floor	2128.8 Sq ft	41×6.3	= 258.3
		61.1×4	= 244.4
		81.1×20	= 1622
		$0.5 \times 81.1 \times 0.1$	= 4.1
Total Living Area (Rounded):	2129 Sq ft		
Non-living Area			
Covered Porch	52.5 Sq ft	9.9×5.3	= 52.5
Covered Patio	228.4 Sq ft	$0.5 \times 18.8 \times 0$	= 0.2
		18.8×12.1	= 228.2
Covered Patio	179.8 Sq ft	18×10	= 179.6
		$0.5 \times 18 \times 0$	= 0.2

Building Sketch (Page - 2)

Borrower/Client	Anna Harrison						
Property Address	18203 Kitzman Rd						
City	Cypress	County	Harris	State	TX	Zip Code	77429
Lender							

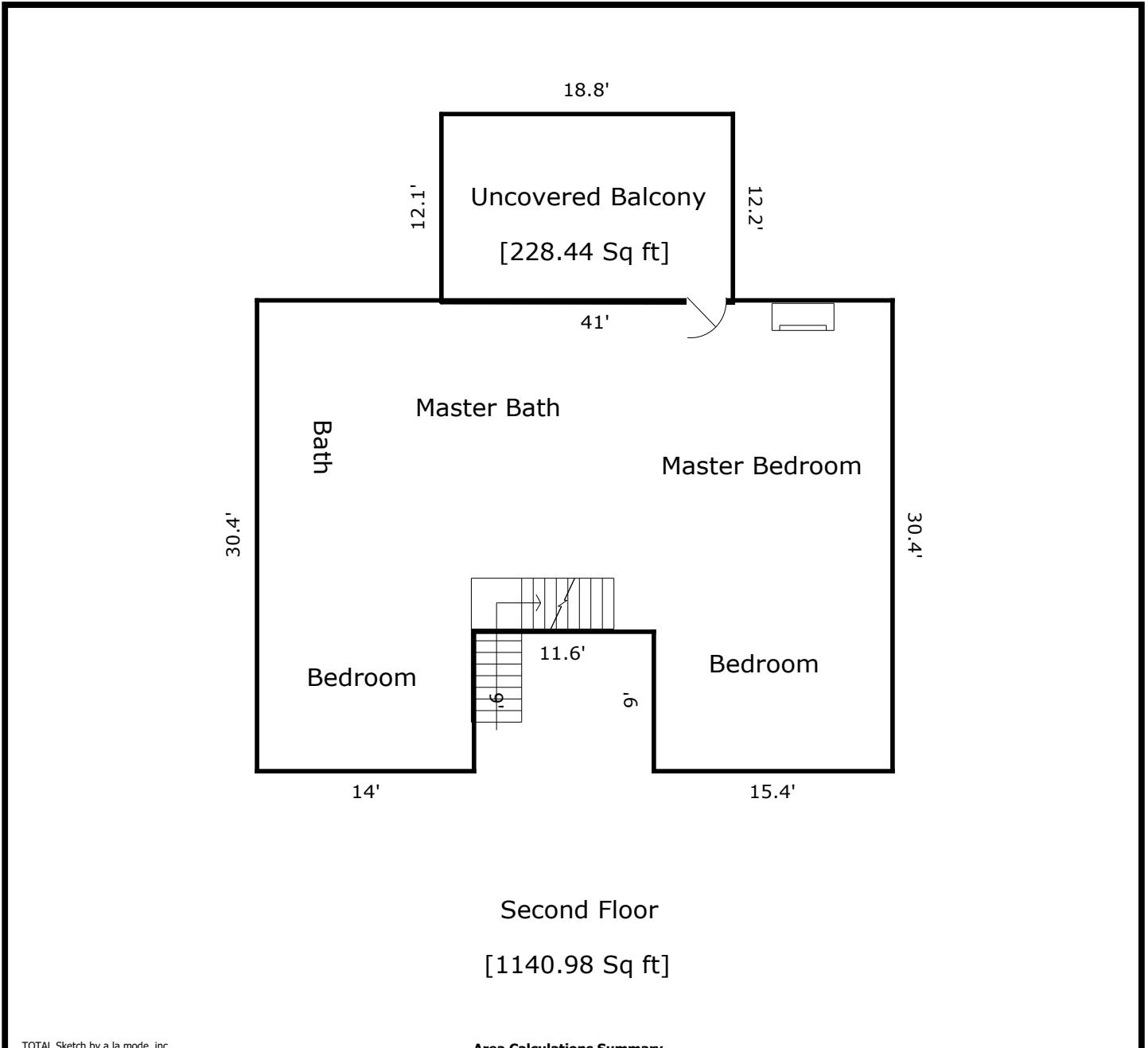

TOTAL Sketch by a la mode, inc.

Area Calculations Summary

Living Area	Calculation Details		
Second Floor	1141 Sq ft	41×21.4	= 876.4
		9×15.4	= 138.6
		9×14	= 126
Total Living Area (Rounded):	1141 Sq ft		
Non-living Area			
Uncovered Balcony	228.4 Sq ft	18.8×12.1	= 228.2
		$0.5 \times 18.8 \times 0$	= 0.2

Building Sketch (Page - 3)

Borrower/Client	Anna Harrison						
Property Address	18203 Kitzman Rd						
City	Cypress	County	Harris	State	TX	Zip Code	77429
Lender							

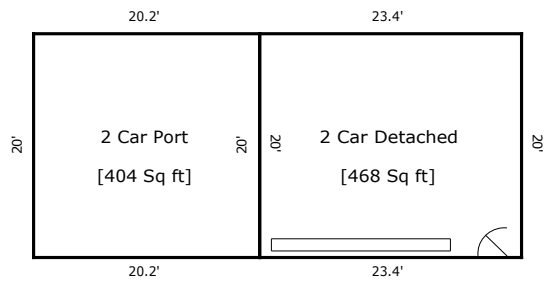
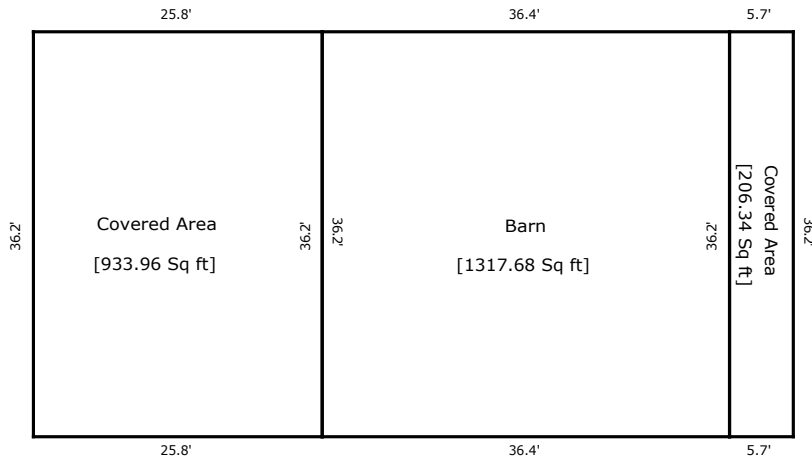

TOTAL Sketch by a la mode, inc.

Area Calculations Summary

Non-living Area		
Covered Area	206.3 Sq ft	$5.7 \times 36.2 = 206.3$
Covered Area	934 Sq ft	$25.8 \times 36.2 = 934$
2 Car Detached	468 Sq ft	$23.4 \times 20 = 468$
2 Car Port	404 Sq ft	$20 \times 20.2 = 404$
Barn	1317.7 Sq ft	$36.4 \times 36.2 = 1317.7$