

SKETCH ESTIMATE



**CERTIFIED
FOUNDATION
SPECIALIST**

411 Longview
Sugar Land, TX 77478
281-491-5389 Fax 281-494-1792
1-888-896-7214

Proposed Layout for:

NAME <i>Chris & Meredith Ellender</i>	
ADDRESS <i>3111 Windmill</i>	
<i>Sugar Land Tx 77478</i>	
PHONE NO. <i>281-242-2667</i>	
ESTIMATOR <i>Crabbs</i>	DATE <i>11-7-05</i>

Scale 1/4"= _____

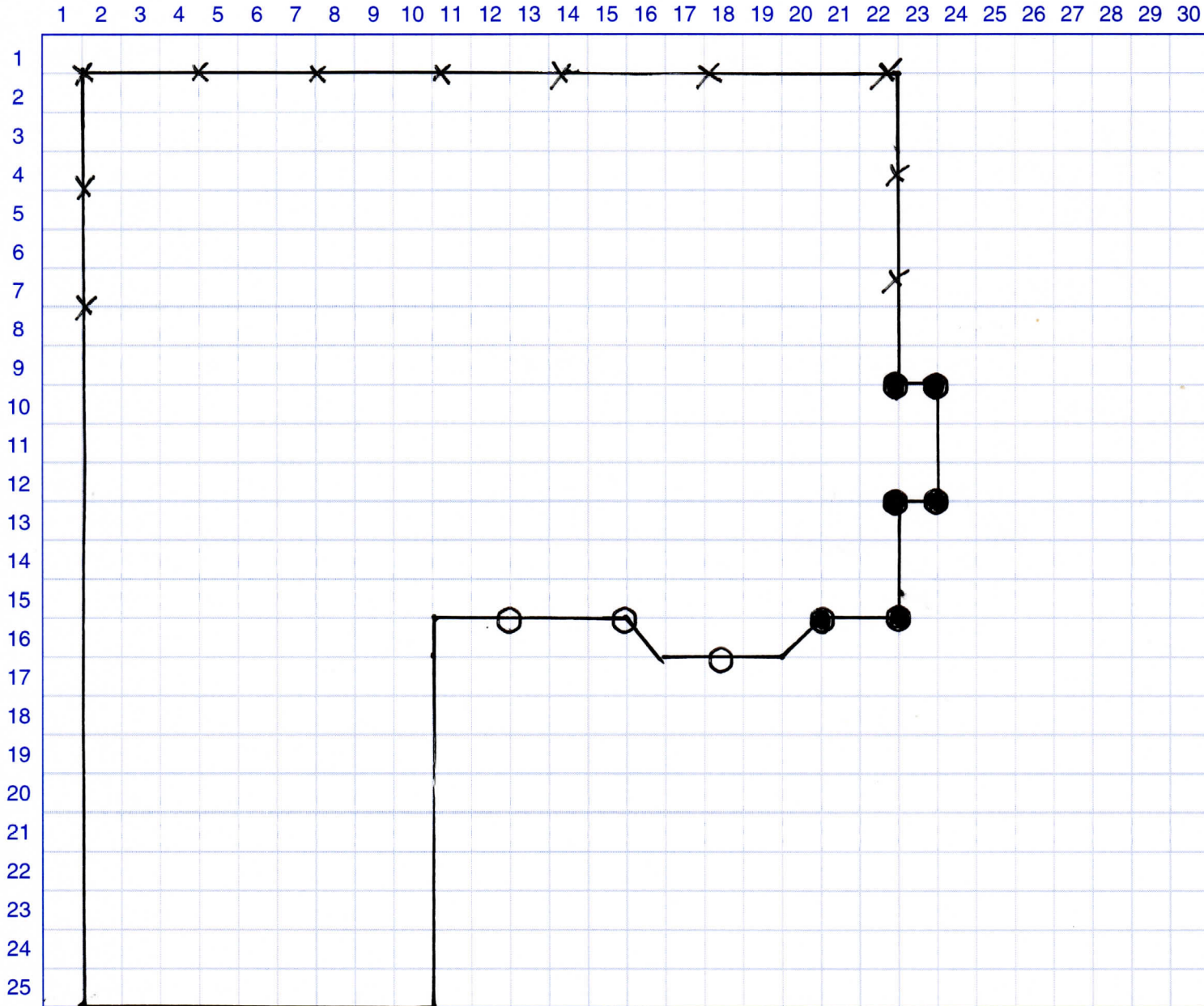

Notes	● = 6 Pressed Piles	Materials	
		Labor	
		Tax	
		Total	<i>1050</i>



**CERTIFIED
FOUNDATION
SPECIALIST**

411 Longview • Sugar Land, TX 77478
281-491-5389 FAX 281-494-1792
1-888-896-7214

PROPOSAL

PROPOSAL NO.
SHEET NO.
DATE <i>11.7.05</i>

PROPOSAL SUBMITTED TO:

WORK TO BE PERFORMED AT:

NAME <i>Chris & Meredith Ellendon</i>	ADDRESS <i>Same</i>
ADDRESS <i>3111 Windmill</i>	CITY, STATE
CITY, STATE <i>Sugar Land, Tx 77479</i>	DATE OF PLANS
PHONE NO. <i>281 242 2667</i>	ARCHITECT

We hereby propose to furnish the materials and perform the labor necessary for the completion of

6 Pressed Piles

Not Responsible For Driveway, Electrical, Plumbing, Back, Floor Coverings or Landscape

Lifetime Transferable Warranty

All material is guaranteed to be as specified, and the above work to be performed in accordance with the drawings and specifications submitted for above work and completed in a substantial workmanlike manner for the sum of:

One Thousand Fifty Dollars (\$ *1050.00*)

with payments to be as follows *IN FULL UPON COMPLETION*

Any alteration or deviation from above specifications involving extra costs will be executed only upon written order, and will become an extra charge over and above the estimate. All agreements contingent upon strikes, accidents, or delays beyond our control.

Respectfully submitted

Per

Note - This proposal may be withdrawn by us if not accepted within *30* days.

ACCEPTANCE OF PROPOSAL

The above prices, specifications and conditions are satisfactory and are hereby accepted. You are authorized to do the work specified. Payments will be made as outlined above.

SIGNATURE

SIGNATURE

DATE



CERTIFIED FOUNDATION SPECIALIST

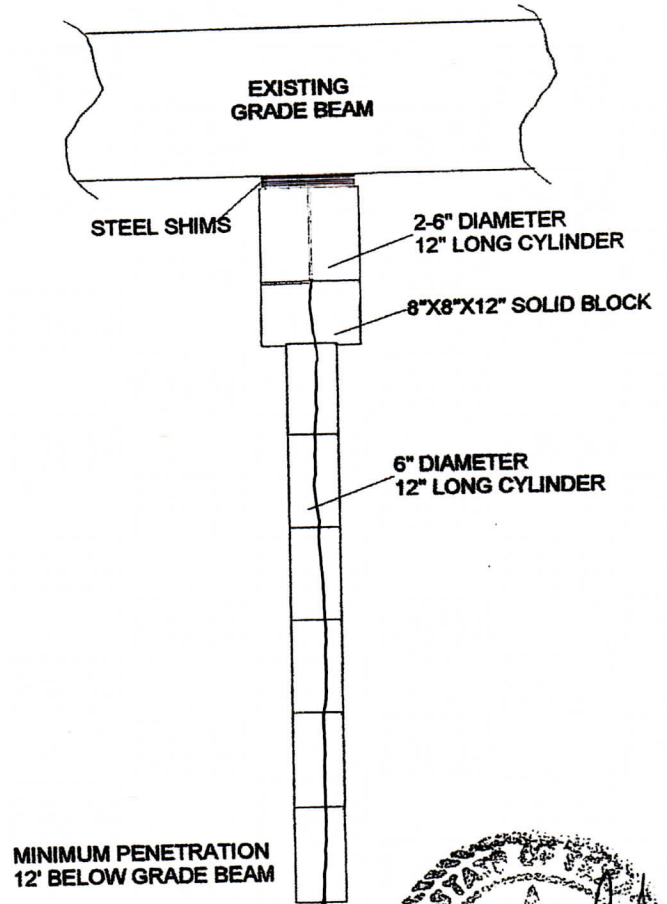
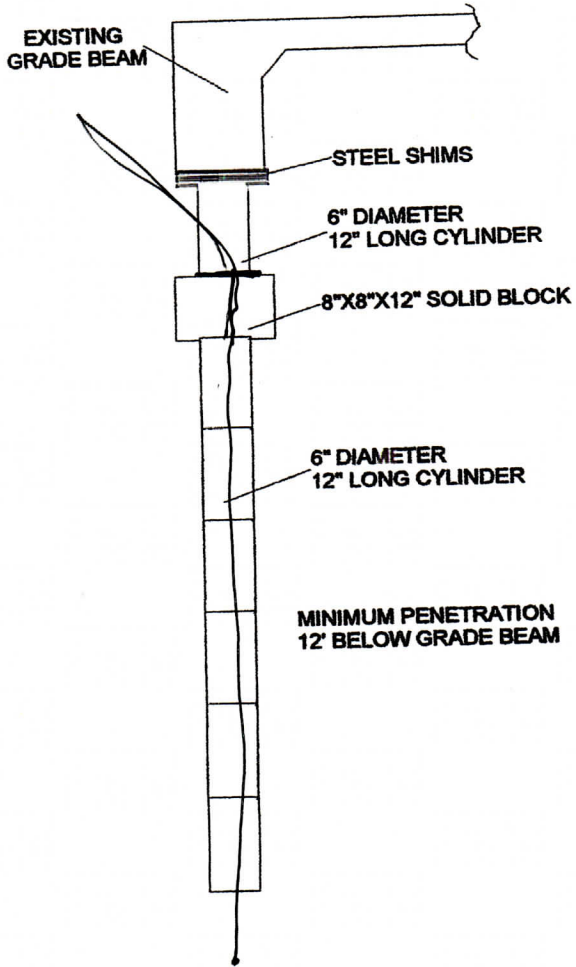

Nov 24, 03

J.T. CONSULTANTS		
SCALE: 1/2"	APPROVED BY: <i>[Signature]</i>	DRAWN BY: JS
DATE: 11/24/03	BY: <i>[Signature]</i>	REVISED:
PUSH PILE DIAGRAM		
		DRAWING NUMBER : 1

CERTIFIED FOUNDATION SPECIALIST
LIFE-TIME WARRANTY

Owner recognizes that soil conditions in this area are such that some future shifting of the soil may occur, particularly during periods of extended dry weather. If any re-raising of the area on which Contractor performed the work set forth herein is necessary due to such settling during the life of the structure after completion of project, Contractor will re-raise settled area where Contractor's piles have been installed, without cost to Owner. This agreement, and the provisions of this paragraph, does not extend to any portion of the structure other than the portion upon which Contractor actually performed work. Contractor guarantees that all materials furnished by him will be standard quality, free from defects, and will be installed in good and workmanlike manner. This warranty may be transferred to a subsequent Owner of the property. In order for the transfer to be affected, written notification must be furnished along with a \$100.00 fee payable to the Contractor within thirty (30) days of closing of sale by Owner, in person or by registered mail. This warranty remains in effect so long as the following provisions are satisfied:

- (1) Structure has not been altered or additions made to it without prior consultation with Contractor.
- (2) The structure has not suffered fire damage to any degree.
- (3) The structure has not been subjected to flood damage.
- (4) The structure is not located on an active fault.

This warranty is backed by a claim reserve account.

Upon completion of work contained herein, Owner agrees to sign a Notice of Completion. Contractor agrees, upon receipt of final payment, to release said work and property from any and all claims. Should Owner fail to execute Notice of Completion and promptly release final payment to Contractor upon final said completion, then Owner agrees to all reasonable cost incurred by Contractor as a result of any collection attempts.

This agreement shall become binding only upon the execution of same by Owner and an Officer or duly appointed representative of Contractor, and same shall constitute the entire contract and Notice of Completion between Contractor and Owner. Any subsequent amendment, modification, or agreement which operates to alter this contract, and which is signed or initialed by Contractor and Owner or representative of Contractor, shall be deemed a part of this contract and shall be controlling in case of conflict to the extent that it alters this contract. No oral representation thereof can change or modify this agreement.

OWNER:

DATE:

ADDRESS:

COMPLETION DATE:

CONTRACTOR:



CERTIFIED FOUNDATION SPECIALIST

1850 FM 1092 • Missouri City, TX 77459
OFFICE: (281) 491-5389 • FAX: (281) 494-1792
1-888-896-7214