

FULLER, MADDOX SURVEYING CO.
 74350 BLUEBERRY HILL, STE. #1, CORRAL, TEXAS 77385
 781-561-2052 FAX 781-292-9270

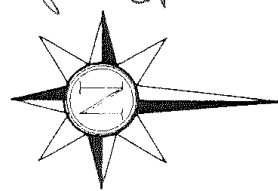
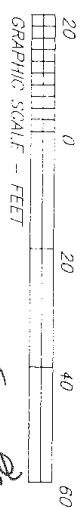
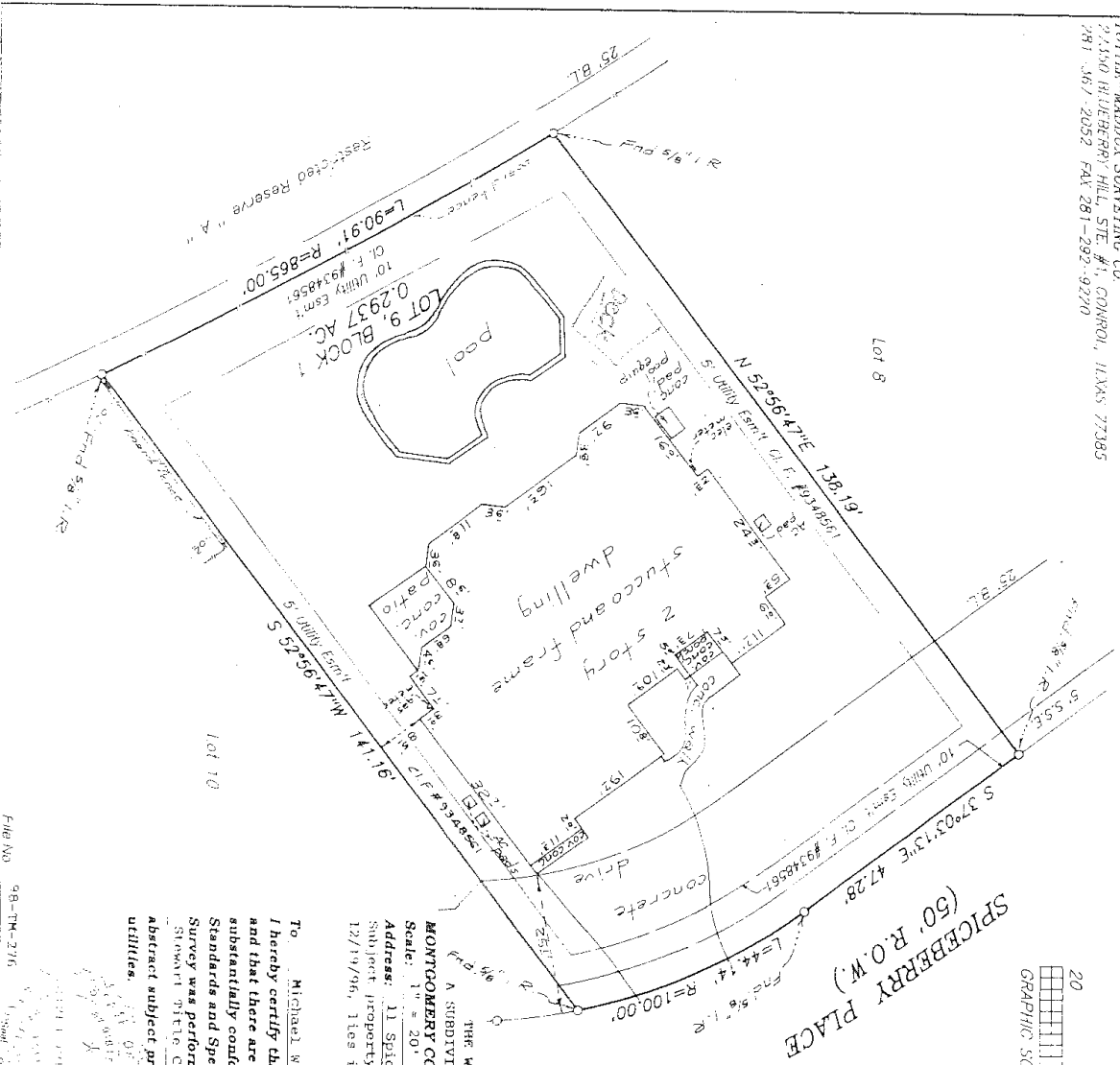

Basis of bearings is recorded plat.

SPICEBERRY PLACE
 (50' R.O.W.)

STANDARD LAND SURVEY

LOT 9, BLOCK 1
 THE WOODLANDS, VILLAGE OF ALDEN BRIDGE, SECTION 13
 A SUBDIVISION SITUATED IN THE A. M. SPRINGER SURVEY, A-490
 MONTGOMERY COUNTY, TEXAS REF. Exhibit H, Sheet 29-A through 31-B H&D Records
 Address: 11 Spiceberry Place, The Woodlands, Texas 77382
 Date: December 19, 1998
 Subject property, as graphically shown on F.E.M.A. Map #4839C0510E dated
 12/19/96, lies in Flood zone "X".

To: Michael W. Maxwell and Pamela R. Maxwell, Exclusively,
 I hereby certify that this survey was made on the ground under my supervision
 and that there are no visible encroachments except as shown. This Survey
 substantially conforms to the current Texas Society of Professional Surveyors
 Standards and Specifications for a Category I-B, Condition III Survey. This
 Survey was performed with the benefit of a Title Commitment prepared by
 Stewart Title Company G.F. No. 98405028. Surveyor did not
 abstract subject property. Surveyor did not locate underground improvements or
 utilities.

Robert E. Maddux, Jr.
 R.P.L.S. No. 4513

File No 98-TM-276

This survey is the property of Fuller, Maddox Surveying Co. and shall not be re-surveyed
 without the written consent of Fuller, Maddox Surveying Co. or its successors. The title
 of this survey is "STANDARD LAND SURVEY LOT 9, BLOCK 1, THE WOODLANDS, VILLAGE OF ALDEN BRIDGE,
 SECTION 13, A SUBDIVISION SITUATED IN THE A. M. SPRINGER SURVEY, A-490, MONTGOMERY COUNTY,
 TEXAS REF. Exhibit H, Sheet 29-A through 31-B H&D Records".