

LEGEND

	SET "X" IN CONC.		RIP RAP		WATER
	PEDESTAL		B.L. = BUILDING LINE		
	SANITARY MANHOLE		U.E. = UTILITY EASEMENT		
	SET 1/2" I.R. W/CAP MARKED		A.E. = AERIAL EASEMENT		
	WOOD BULKHEAD		APPROXIMATE HIGH BANK		

CURVE	RADIUS	LENGTH	CHORD BEARING	CHORD
C1	42.00'	5.26'	N 74°24'35" E	5.26'

NOTES:

- ALL BEARINGS SHOWN HEREON ARE REFERENCED TO THE SUBDIVISION PLAT NAMED BELOW, POINTS (A) AND (B) WERE HELD FOR HORIZONTAL CONTROL.
- ABSTRACT INFORMATION FOR THE SUBJECT TRACT WAS PROVIDED BY THE TITLE INSURANCE COMPANY LISTED BELOW.
- THIS SURVEY IS CERTIFIED TO THE TITLE INSURANCE COMPANY LISTED BELOW FOR THIS TRANSACTION ONLY, IT IS NOT TRANSFERABLE TO ADDITIONAL INSTITUTIONS OR SUBSEQUENT OWNERS.
- ALL EASEMENTS AND BUILDING LINES SHOWN ARE PER THE RECORDED PLAT UNLESS OTHERWISE NOTED.
- THERE ARE NO NATURAL DRAINAGE COURSES ON SUBJECT PROPERTY.
- SUBJECT TO THE RESTRICTIVE COVENANTS AS LISTED IN SCHEDULE B OF THE TITLE COMMITMENT ISSUED ON AUGUST 21, 2019, UNDER G.F. NO. 3031919-03285.

LEGAL DESCRIPTION: LOT 16 AND 16A, OF EDWARDS LANDING, A SUBDIVISION IN GALVESTON COUNTY, TEXAS, ACCORDING TO THE MAP OR PLAT THEREOF RECORDED IN VOLUME 17, PAGE 119 OF THE MAP RECORDS OF GALVESTON COUNTY, TEXAS.

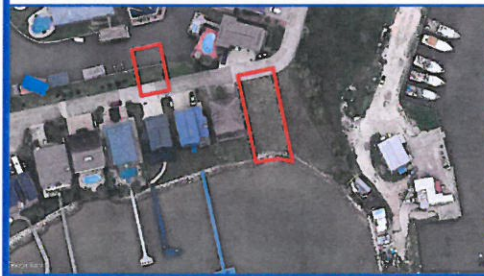

TITLE COMPANY:

AMERICAN
TITLE COMPANY

G.F. #: 3031919-03285 ISSUE DATE: AUGUST 21, 2019



STATE OF TEXAS
REGISTERED
RICHARD FUSSELL
4148
PROFESSIONAL
LAND SURVEYOR

SURVEYOR'S CERTIFICATE:
IN MY PROFESSIONAL OPINION, THIS PLAT REPRESENTS THE FACTS FOUND ON THE GROUND DURING THE COURSE OF A BOUNDARY SURVEY CONDUCTED UNDER MY SUPERVISION ON AUGUST 26, 2019 AND THAT THIS PLAT SUBSTANTIALLY COMPLIES WITH THE CURRENT STANDARDS AS ADOPTED BY THE TEXAS BOARD OF PROFESSIONAL LAND SURVEYING, AND THAT THERE ARE NO ENCROACHMENTS OR PROTRUSIONS EXCEPT AS SHOWN.

[Signature]
RICHARD FUSSELL
RPLS # 4148

CLIENT:
MATTHEW SHARP AND JENNIFER SHARP

ADDRESS:
16 EDWARDS DRIVE
www.survey1inc.com
survey1@survey1inc.com

Survey 1, Inc.
Your Land Survey Company
Firm Registration No. 100758-00
P.O. Box 2543 | Alvin, TX 77512 | (281)393-1382

FIELD CREW: JJ	TECH: EF
DRAFTER: ET	FINAL CHECK: EF
DATE: 8-30-19	
JOB# 8-76454-19	