

**NOTES:**

1. Restrictive Covenants recorded on Slide No(s). 1906/B and 1907/A of the Plat Records of Fort Bend County, Texas, and under F.B.C.C.C. No. 2000002528.
2. Agreement with H.L. & P. Co. (F.B.C.C.F. No. 1999100298).

PROPERTY ADDRESS:  
24902 North Pointe Place  
Katy, Texas, 77494

SURVEY FOR: MARK D. SWISHER and VIRGINIA A. SWISHER

Being: LOT 24, in BLOCK 1, of LAKE POINTE ESTATES, SECTION ONE, a subdivision in Fort Bend County, Texas, according to the map or plat thereof recorded under Slide No(s). 1906/B and 1907/A of the Plat Records of Fort Bend County, Texas.

**ROBINSON SURVEYING, INC.**

P.O. BOX 11925  
SPRING, TEXAS 77391-1925  
PHONE (281) 370-8211

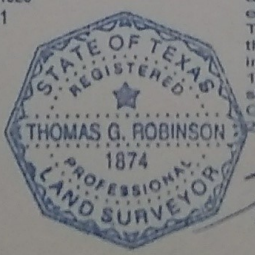

I, Thomas G. Robinson, certify that this survey was performed under my supervision on August 30, 2005; that there were no encroachments except as shown; that this survey conforms to T.S.P.S. Standards for a Category 1a, Condition III Survey; and that subject property is NOT in the 100 Year Flood Plain, and is in Zone "X" on F.I.R.M. Map # 48157C 0020 J dated January 3, 1997. This certifies only to easements and building lines shown on the recorded subdivision plat and on Commitment GF# 0405047291 of Startex Title Company dated August 23, 2005.

*Thomas G. Robinson*

Thomas G. Robinson, R.P.L.S. #1874  
JOB NO. 20714