

FLOORPLAN

Borrower: James Giese
 Property Address: 10207 Hondo Hill Rd
 City: Houston
 Lender: Citimortgage

File No.: 9591877
 Case No.: 1008055
 State: TX
 Zip: 77064

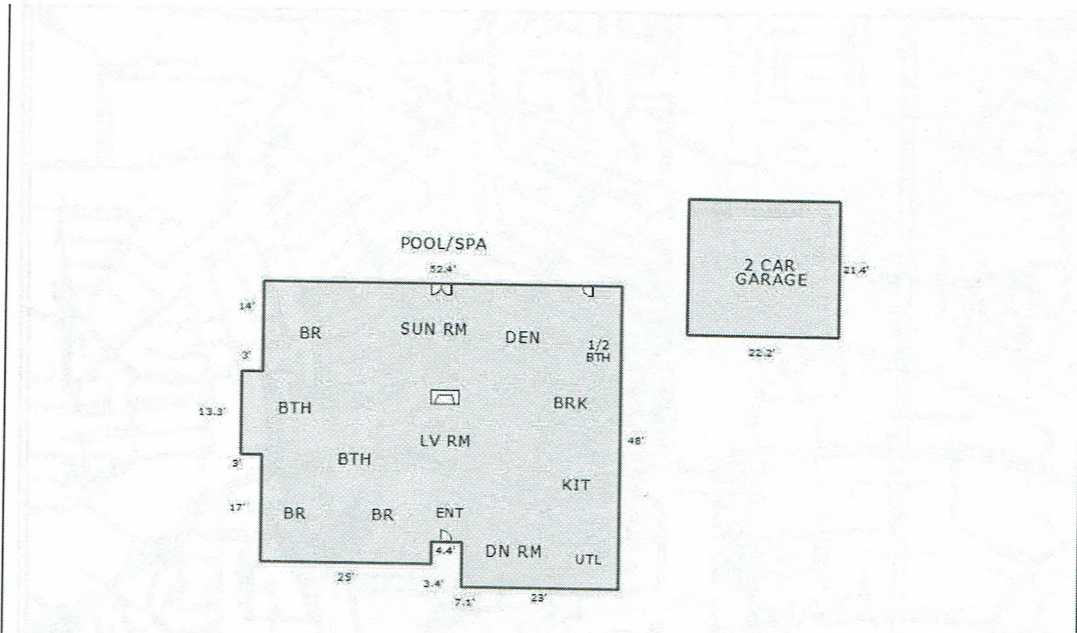

Search by Apex Media™
 Comments:

AREA CALCULATIONS SUMMARY			
Code	Description	Net Size	Net Totals
GLA1	First Floor	2431.4	2431.4
GAR	Garage	475.1	475.1
Net LIVABLE Area		(rounded)	2431

LIVING AREA BREAKDOWN		
Breakdown		Subtotals
First Floor		
25.0	x 3.4	85.0
52.4	x 13.6	712.6
7.1	x 23.0	163.3
14.0	x 52.4	733.6
13.3	x 55.4	736.8
5 Items	(rounded)	2431