

- NOTES:**
1. ALL BEARINGS SHOWN HEREON ARE REFERENCED TO THE SUBDIVISION PLAT NAMED BELOW, POINTS (A) AND (B) WERE HELD FOR HORIZONTAL CONTROL.
 2. ABSTRACT INFORMATION FOR THE SUBJECT TRACT WAS PROVIDED BY THE TITLE INSURANCE COMPANY LISTED BELOW.
 3. THIS SURVEY IS CERTIFIED TO THE TITLE INSURANCE COMPANY LISTED BELOW FOR THIS TRANSACTION ONLY, IT IS NOT TRANSFERABLE TO ADDITIONAL INSTITUTIONS OR SUBSEQUENT OWNERS.
 4. ALL EASEMENTS AND BUILDING LINES SHOWN ARE PER THE RECORDED PLAT UNLESS OTHERWISE NOTED.
 5. THERE ARE NO NATURAL DRAINAGE COURSES ON SUBJECT PROPERTY.
 6. SUBJECT TO THE RESTRICTIVE COVENANTS AS LISTED IN SCHEDULE B OF THE TITLE COMMITMENT ISSUED ON MAY 18, 2018, UNDER G.F. NO. 2324781.
 7. AN AGREEMENT FOR UNDERGROUND ELECTRIC SERVICE AS RECORDED IN C.F. NO. 04-004852.
 8. R.O.W. EASEMENT TO AMERICAN CANAL CO. AS RECORDED IN VOL. 638, PG. 127.

LEGEND

	CONCRETE		CENTERLINE
	COVERED AREA		B.L. = BUILDING LINE
	FENCE		U.E. = UTILITY EASEMENT
			A.E. = AERIAL EASEMENT
			WOOD

CURVE	RADIUS	LENGTH	CHORD BEARING	CHORD
C1	970.00'	61.18'	N 84°44'50" E	61.17'

BLOCK 2 - SOUTHFORK, SEC. 2-A, VOL. 22, PG. 363, M.R.B.C.

LEGAL DESCRIPTION: LOT 2, IN BLOCK 4, OF SOUTHFORK, SECTION 1-B, A SUBDIVISION IN BRAZORIA COUNTY, TEXAS, ACCORDING TO THE MAP OR PLAT THEREOF RECORDED IN VOLUME 23, PAGE 281 OF THE MAP RECORDS OF BRAZORIA COUNTY, TEXAS.



TITLE COMPANY:

First American Title
832-787-8128

G.F. #: 2324781 ISSUE DATE: 5-18-18

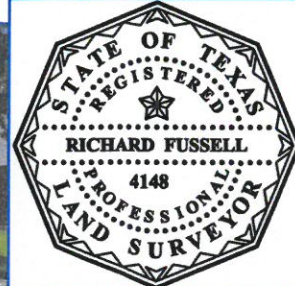

SURVEYORS CERTIFICATE:
IN MY PROFESSIONAL OPINION, THIS PLAT REPRESENTS THE FACTS FOUND ON THE GROUND DURING THE COURSE OF A BOUNDARY SURVEY CONDUCTED UNDER MY SUPERVISION ON MAY 28, 2018 AND THAT THIS PLAT SUBSTANTIALLY COMPLIES WITH THE CURRENT STANDARDS AS ADOPTED BY THE TEXAS BOARD OF PROFESSIONAL LAND SURVEYING, AND THAT THERE ARE NO ENCROACHMENTS OR PROTRUSIONS EXCEPT AS SHOWN.

Richard Fussell
RICHARD FUSSELL
RPLS# 4148

CLIENT: MATTHEW B. CLOUSE AND JENNIFER L. CLOUSE

ADDRESS: 3010 TEXAS TRAIL LANE

www.survey1inc.com
survey1@survey1inc.com

Survey 1, Inc.
Your Land Survey Company
Firm Registration No. 100758-00
P.O. Box 2543 | Alvin, TX 77512 | (281)393-1382

FIELD CREW: TB	TECH: MC
DRAFTER: MC	FINAL CHECK: EF
DATE: 5-29-18	
JOB#: 5-63677-18	