

**914 Cobble Gate Drive
Chase Wheaton**

Being all of Lot 17 (SEVENTEEN), WOODBRIDGE SUBDIVISION, SECTION 1, an addition in Washington County, Texas, according to the plat recorded in Plat Cabinet File No. 580B and 581A of the Plat Records of Washington County, Texas.

I, Paul Williams, Registered Professional Land Surveyor No. 5743 do hereby certify that this plat represents the results of a survey performed on the ground, under my supervision on August 30, 2009, and is true and correct to the best of my knowledge.

I further certify that no improvements on this property encroach on adjacent property, nor do any improvements on adjacent property encroach on to this property, except as shown. Part of this property does lie within a Special Flood Hazard Area as depicted on Flood Insurance Rate Map No. 4806480001B dated August 17, 1981.

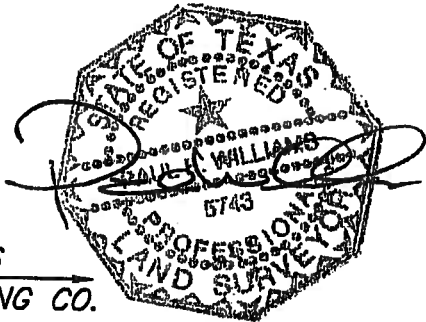
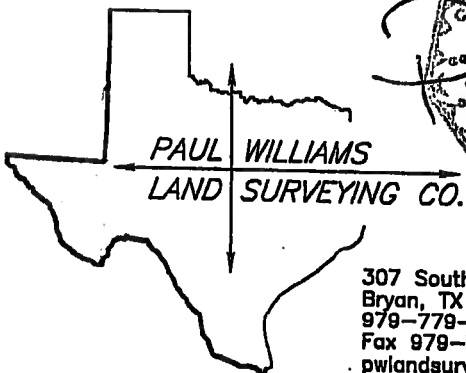

307 South Main Street, Ste. 206
Bryan, TX 77803
979-779-7670
Fax 979-779-7672
pwlandsurveying@earthlink.net

- Notes:**
 North orientation is based on rotating the south line to plat calls in Cabinet 580B and 581A.
 This survey was prepared with the benefit of Aggleland Title Company Commitment No. G.F. 25846 and is valid for this transaction only.
 The Following Easements appear to effect the parent tract of this property, however no above ground evidence was located on this survey:
 1) From Boyd Bradley Nutt to The City of Brenham In 904/677.
 2) Fifteen foot wide sewer easement from plat.
 3) Fifteen foot wide drainage easement from plat.
 4) Fifteen foot wide sewer easement along creek per plat.
 5) Electric line along Burseson Street.
 6) Subject to unabstracted aerial easement 5' by 20' above ground along all above ground utilities.