

NOTES:
 1.) SUBJECT TO ANY AND ALL RESTRICTIVE COVENANTS IN SLIDE NOS. 1182/B AND 1183/A F.B.C.P.R. AND VOL. 1938, PG. 340 AND VOL. 2509, PG. 2422 F.B.C.O.R.
 2.) SUBJECT TO THE CITY OF SUGAR LAND ZONING ORDINANCES
 3.) H.L. & P. AGREEMENT IN VOL. 2492, PG. 2234 F.B.C.O.R.

THE SURVEYOR HAS NOT ABSTRACTED THE SUBJECT PROPERTY.
 SUBJECT PROPERTY IS BASED ON TITLE COMMITMENT LISTED BELOW.
 ALL BEARINGS SHOWN ARE REFERENCED PER RECORDED PLAT OF SAID SUBDIVISION.

LOT : 5		BLOCK : 1	SUBDIVISION : BRIDGEWATER	SECTION : 2
COUNTY : FT. BEND	STATE : TEXAS	RECORDATION : SLIDE NOS. 1182/B AND 1183/A F.B.C.P.R.	SURVEY : FIELD WORK: 11-02-98/PD FINAL CHECK : 11-17-98/SB	SCALE: 1"=20'
PURCHASER: CLARK L. WEAVER AND CAROL A. WEAVER			DRAFTING : 11-17-98/AA	KEY MAP: 608 L
ADDRESS: 4407 DANBURY LANE , SUGAR LAND , TEXAS				

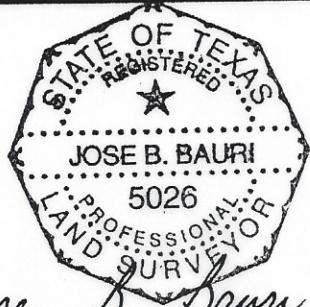

Jose B. Bauri

I DO HEREBY CERTIFY THAT THIS SURVEY WAS THIS DAY MADE ON THE GROUND OF THE PROPERTY LEGALLY DESCRIBED HEREON IS CORRECT AND THERE ARE NO ENCROACHMENTS EXCEPT AS SHOWN HEREON.

• Subject Property IS NOT Located in a Federal Insurance Administration Designated Flood Hazard Area. ZONE 'X' (SHADED)
 As per map 480228
 Panel 265 J Dated 01-03-97
 • THIS INFORMATION IS BASED ON GRAPHIC PLOTTING ONLY. WE DO NOT ASSUME RESPONSIBILITY FOR EXACT DETERMINATION

MORT. CO.	FIRST TEXAS RES.
TITLE CO.	TITLE ONE
G.F. NO.	98 TO 101795-B
JOB NO.	98-11697

ALLTEX
 REALTY SERVICES
 REAL ESTATE SURVEY DIVISION
 9525 KATY FREEWAY, SUITE 420
 HOUSTON, TEXAS 77024
 TFI : (713) 468-7707