

LINE	BEARING	DISTANCE
L 1	N 73° 58' 25" E	40 00'
L 2	S 73° 58' 25" W	40 00'
L 3	S 73° 58' 25" W	80 00'

This property lies within ZONE X on SCALED from FEMA Map Panel Number 48339C0355-F dated December 19, 1996.

This determination is made strictly according to the FEMA Maps and does not reflect actual on ground flood conditions. Furthermore, this company takes no responsibility for such

Notes

1. Base of Interest: Recorded Plat
2. Encumbrances and building lines as shown are per the recorded plat unless otherwise stated
3. Subject to terms, conditions, and stipulations contained in deed reserving appropriate easements as recorded in Volume 997 Page 372 D.R.N.C.T.

X Jan J Bailey

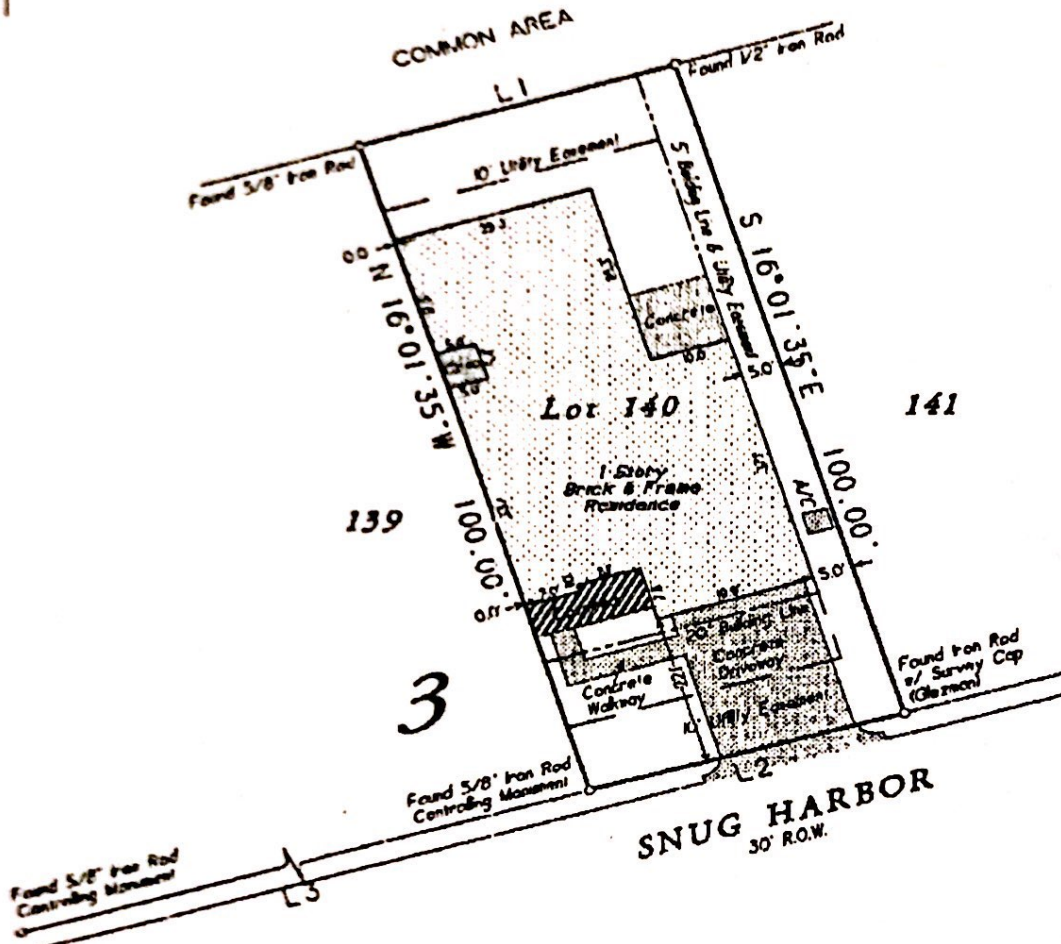

Lot One Hundred Forty (140), Block Three (3), of APRIL SOUND, Section Nine (9), a subdivision in Montgomery County, Texas, according to the map or plat thereof, recorded in Cabinet B, Sheet 54-A, of the Map Records of Montgomery County, Texas.

Date: May 11, 2005	GP No: 0541253
Job No: 04-0227	Scale: 1" = 20'
Address: 877 Snug Harbor Drive	Drawn By: J4
City: Montgomery, Texas	Zip: 77358

C & C Surveying, Inc.
 7434 P.M. 1488, Suite A, Magnolia, Texas 77354
 Office: 281-259-4977 Metro: 281-356-5172
 Fax: 281-356-1935

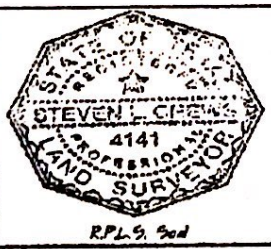

Certified To: Stewart Title Company & Prudential Mortgage Company
 Client: James T. Stephens & Joann Stephens

I HEREBY CERTIFY THAT SURVEY WAS MADE ON THE INTEREST, AND THAT THIS PLAT CORRECTLY REPRESENTS THE FACTS FOUND AT THE TIME OF SURVEY AND THAT I AM A PROFESSIONAL SURVEYOR CONFORMING TO THE TEXAS SOCIETY OF PROFESSIONAL SURVEYORS STANDARDS AND SPECIFICATIONS FOR A CATEGORY IIIA, CONDITION III SURVEY, AND THAT THERE ARE NO ENCUMBRANCES EXCEPT AS SHOWN.

Steven L. Cross
 Steven L. Cross R.P.L.S. # 4141