

Robert E. Lee, II

Kailey Lee

BEARINGS BASED ON SUBDIVISION PLAT  
 DCM = DIRECTIONAL CONTROL MONUMENT  
 B.L. = BUILDING LINE  
 U.E. = UTILITY EASEMENT  
 A.E. = AERIAL EASEMENT  
 S.S.E. = SANITARY SEWER EASEMENT  
 STM.S.E. = STORM SEWER EASEMENT

Unobstructed Easement per instrument (X488715)  
 Agreement for electric service (X348124)

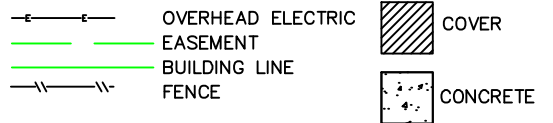

REALTOR:



Judy Sin  
 GF No. 1972299-H090

LENDER:

N/A

SURVEYOR INFORMATION:

LAPLANT SURVEYORS, INC.  
 17150 BUTTE CREEK 135  
 Houston, Texas 77060  
 281-440-8890  
 FAX 281-440-8510

JOB NUMBER: 140861

CERTIFIED TO:

Robert E. Lee, II  
 Kailey Lee

LEGAL DESCRIPTION:

Lot 46, Block 1, Section 8  
 Windrose West  
 Film Code No. 531192  
 Map Records of Harris County  
 6810 Summer Trace Court  
 Spring, Texas 77379

CERTIFICATION

The undersigned does hereby certify that this survey was this day made, on the ground of the property, legally described hereon and correct; and that there are no discrepancies, conflicts, shortages in area, boundary line conflicts, visible encroachments overlapping of improvements, easements or apparent rights-of-way, except as shown hereon, and said property has access to and from dedicated roadway, except as shown hereon.

NOTES

FLOOD ZONE

SUBJECT PROPERTY SHOWN HEREON APPEARS TO BE LOCATED IN FLOOD ZONE "X", AREA OF MINIMAL FLOODING, PER F.I.R.M. PANEL NUMBER 48291C-0298M, LAST REVISION DATE 10-16-13. THIS SURVEYOR MAKES NO GUARANTEES AS TO THE ACCURACY OF THE ABOVE INFORMATION. THE LOCAL F.E.M.A. AGENT SHOULD BE CONTACTED FOR VERIFICATION.

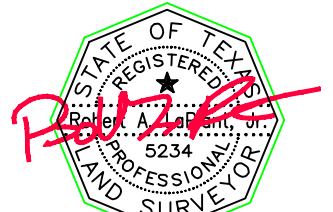

THIS SURVEY IS BASED ON TITLE COMMITMENT AS PROVIDED BY TITLE COMPANY, AND IS CERTIFIED FOR THE ABOVE DESCRIBED TRANSACTION ONLY AND NOT VALID FOR ANY OTHER TRANSACTIONS NOT DATED HEREON. SURVEYOR SHALL HAVE NO LIABILITY FOR ANY SUCH USE.

SURVEYOR'S NAME  
 NOT VALID WITHOUT AN AUTHENTICATED SIGNATURE AND AUTHENTICATED SEAL

DATED: 9-30-2014

FIRM No. 10145800