

30 0 30 60 90 Feet
SCALE: 1"=30'

R=40.00'
D=55°28'09"
[39.37'] L=38.72'
(S 25°24'18"W
37.23')

R=40.00'
D=20°22'04"
[14.29'] L=14.22'
(S 12°30'48"W
14.14')

plat: [S 87°34'55" E 140.00']
S 87°34'55" E
140.81'

5

3/4" IR
3' W'y
(disturbed)

60d nail
flagged

AUGUSTA PLACE
N 28°32'02" E
52.00'

water meter
tele box
3/4" IR

old 1/2" IR
(2' deep)
25' building line

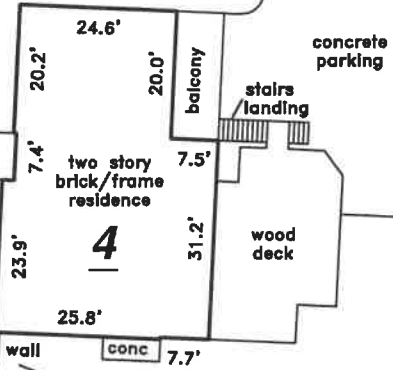

15' building line

S 113.97'
S 22°30'00" W
[S 22°30'00" W 114.94']

GOLF COURSE

3
N 129.83'
N 67°38'18" W
[N 67°07'00" W 129.41']

**WATERWOOD
COUNTRY CLUB ESTATES
BLOCK 4, UNIT 1**

S 22°25'21" W
92.1' 3/4" IR

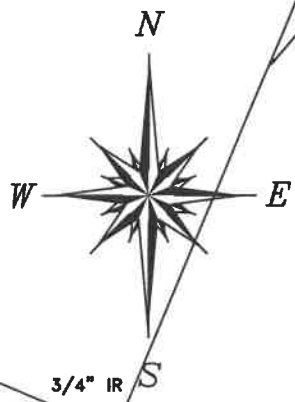

LAND TITLE SURVEY
FOR: MARGARET KISZKIEL
22412 AUGUSTA PLACE
HUNTSVILLE, TEXAS 77320

LOT FOUR (4), BLOCK FOUR (4), UNIT ONE (1)
of WATERWOOD COUNTRY CLUB ESTATES, a
subdivision in San Jacinto County, Texas,
according to the map or plat thereof recorded
in Volume 4, Page 24 of the Plat Records of
San Jacinto County, Texas.

Covenants of Record:
140/697, 140/706, 141/813 DR;
CF 04-1617 P 7287 OPR

I hereby certify that this survey was made
on the ground under my supervision and that this
drawing correctly represents the facts found
24 January 2020

QUADRANT SOLUTIONS
P.O. BOX 1343 WILLIS, TEXAS 77378
(936) 856-8989
PROJECT NO.: 503920

Michael C. Warren
Registered Professional Land Surveyor No. 4935