

GF NO. 1868769-H045 FIRST AMERICAN TITLE  
 ADDRESS: 1515 SAXONY LANE  
 HOUSTON, TEXAS 77058  
 BORROWER: SETH D. SCHROEDER AND  
 MACIE A. SCHROEDER

SCALE: 1" = 30'

**LOT 41, BLOCK 4  
 NASSAU BAY, SECTION 1**  
 AN ADDITION IN HARRIS COUNTY, TEXAS  
 ACCORDING TO THE MAP OR PLAT THEREOF RECORDED  
 IN VOLUME 96, PAGE 51, OF THE MAP RECORDS  
 OF HARRIS COUNTY, TEXAS



NOTE: AN AGREEMENT FOR CABLE TELEVISION SERVICES AND INSTALLATION AS PER VOL. 5316, PG. 50.  
 NOTE: AGREEMENT BY AND BETWEEN DEVELOPER AND H. L. & P. FOR INSTALLATION OF OVERHEAD/UNDERGROUND ELECTRICAL DISTRIBUTION SYSTEM CF NOS. B836030, B735448, B701892 & C239768.

THIS PROPERTY DOES NOT LIE WITHIN THE 100 YEAR FLOOD PLAIN AS PER FIRM PANEL NO. 48201C 1090 L MAP REVISION: 06/18/07 ZONE X BASED ONLY ON VISUAL EXAMINATION OF MAPS. INACCURACIES OF FEMA MAPS PREVENT EXACT DETERMINATION WITHOUT DETAILED FIELD STUDY

A SUBSURFACE INVESTIGATION WAS BEYOND THE SCOPE OF THIS SURVEY

D.C.L. = DIRECTIONAL CONTROL LINE RECORD BEARING: VOL. 96, PG. 51, H.C.M.R.

DRAWN BY: BR

I HEREBY CERTIFY THAT THIS SURVEY WAS MADE ON THE GROUND, THAT THIS PLAT CORRECTLY REPRESENTS THE FACTS FOUND AT THE TIME OF SURVEY AND THAT THERE ARE NO ENCROACHMENTS APPARENT ON THE GROUND, EXCEPT AS SHOWN HEREON. THIS SURVEY IS CERTIFIED FOR THIS TRANSACTION ONLY AND ABSTRACTING PROVIDED IN THE ABOVE REFERENCED TITLE COMMITMENT WAS RELIED UPON IN PREPARATION OF THIS SURVEY.

JIMMY RAY JANECEK  
 PROFESSIONAL LAND SURVEYOR  
 No. 5868  
 JOB NO. 13-11409  
 OCTOBER 03, 2013

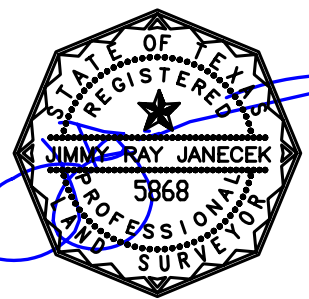

**PRECISION**  
 surveyors

1-800-LANDSURVEY  
 www.precisionurveyors.com  
 281-496-1586 FAX 281-496-1867 210-829-4941 FAX 210-829-1555  
 950 THREADNEEDLE STREET SUITE 150 HOUSTON, TEXAS 77079 1777 NE LOOP 410 SUITE 600 SAN ANTONIO, TEXAS 78217  
 FIRM NO. 10063700