

# 3302 Village Falls Ct, Kingwood, TX 77339-1894, Harris County



MLS Beds	3	MLS Sq Ft	2,183	Lot Sq Ft	6,850	MLS Sale Price	\$175,000
MLS Baths	2	Yr Built	1983	Type	SFR	MLS Sale Date	08/24/2012

## OWNER INFORMATION

Owner Name	Masdon Earl C III	Tax Billing Address	3302 Village Falls Ct
Owner Name 2	Masdon Marilyn M	Tax Billing City & State	Kingwood, TX
Owner Occupied	Yes	Tax Billing Zip	77339
Carrier Route	R006	Tax Billing Zip+4	1894

## LOCATION INFORMATION

Subdivision	Winchester Country Sec 06	Key Map	296z
School District Name	Humble ISD	Waterfront Influence	Neighborhood
Neighborhood Code	Village Falls-2354.01	Topography	Flat/Level
Township	Houston	Census Tract	2513.00
MLS Area	32	Map Facet	296-Z
Market Area	KINGWOOD WEST	Traffic	Paved

## TAX INFORMATION

Parcel ID	115-239-002-0022	Exemption(s)	Homestead
Parcel ID	1152390020022	Tax Area	040
Block #	2	Water Tax Dist	041
% Improved	88%		
Legal Description	TR 22 BLK 2 VILLAGE FALLS		

## ASSESSMENT & TAX

Assessment Year	2019	2018	2017
Assessed Value - Total	\$239,033	\$219,964	\$219,964
Assessed Value - Land	\$27,892	\$27,892	\$27,892
Assessed Value - Improved	\$211,141	\$192,072	\$192,072
YOY Assessed Change (\$)	\$19,069	\$0	
YOY Assessed Change (%)	8.67%	0%	
Market Value - Total	\$239,033	\$219,964	\$219,964
Market Value - Land	\$27,892	\$27,892	\$27,892
Market Value - Improved	\$211,141	\$192,072	\$192,072
Tax Year	Total Tax	Change (\$)	Change (%)
2017	\$6,263		
2018	\$6,272	\$9	0.14%
2019	\$6,480	\$208	3.31%

Jurisdiction	Tax Rate	Tax Amount
Humble ISD	1.41835	\$3,390.32
Harris County	.40713	\$973.18
Hc Flood Control Dist	.02792	\$66.74
Port Of Houston Authority	.01074	\$25.67
Hc Hospital Dist	.16591	\$396.58
Hc Department Of Education	.005	\$11.95
Lone Star College Sys	.1078	\$257.68
Houston City Of	.56792	\$1,357.52
Total Estimated Tax Rate	2.7108	

## CHARACTERISTICS

Land Use - CoreLogic	SFR	MLS Total Baths	2
Land Use - County	Res Imprvd Table Val	Full Baths	2

Land Use - State	Resid Single Family	Fireplace	Y
Lot Acres	0.1573	Fireplaces	1
Lot Sq Ft	6,850	Elec Svs Type	Y
# of Buildings	1	Cooling Type	Central
Building Type	Single Family	Heat Type	Central
Bldg Class	R	Porch	Open Frame Porch
Building Sq Ft	Tax: 2,453 MLS: 2,183	Porch Sq Ft	60
Gross Sq Ft	Tax: 2,937 MLS: 2,183	Parking Type	Attached Masonry Garage
Above Gnd Sq Ft	2,453	No. Parking Spaces	MLS: 2
Ground Floor Sq Ft	2,453	Garage Type	Attached Garage
Stories	1	Garage Capacity	MLS: 2
Condition	Average	Garage Sq Ft	484
Quality	Average	Foundation	Slab
Total Rooms	6	Exterior	Brick Veneer
Bedrooms	3	Year Built	1983
Total Baths	2	Effective Year Built	1983

**FEATURES**

Feature Type	Unit	Size/Qty
Base Area Pri	S	2,183
One Story Frame Pri	S	270
Mas/Brk Garage Pri	S	484
Open Frame Porch Pri	S	60

Building Description	Building Size
Fireplace: Wood	1
Fixtures: Total	8
Room: Bedroom	3
Room: Full Bath	2
Room: Total	6
Story Height Index	1

**SELL SCORE**

Rating	High	Value As Of	2020-06-17 23:07:45
Sell Score	726		

**LISTING INFORMATION**

MLS Listing Number	67208542	MLS Pending Date	08/03/2012
MLS Status	Sold	MLS Sale Date	08/24/2012
Listing Area	32	MLS Sale/Close Price	\$175,000
MLS D.O.M	23	Listing Agent	Suzbrowm-Susan Brown
MLS Listing Date	07/11/2012	Listing Broker	KELLER WILLIAMS REALTY NORT HEAST
MLS Current List Price	\$182,500	Selling Agent	Orrick-Phillis Orrick
MLS Original List Price	\$182,500	Selling Broker	RE/MAX ASSOCIATES NORTHEAS T
MLS Status Change Date	08/27/2012		
MLS Listing #	59768749	18684074	
MLS Status	Expired	Expired	
MLS Listing Date	02/28/2012	11/14/2002	
MLS Listing Price	\$185,000	\$156,000	
MLS Orig Listing Price	\$195,000	\$159,000	

**LAST MARKET SALE & SALES HISTORY**

Recording Date	08/31/2012		
Nominal		Y	Y
Buyer Name	Masdon Earl C III & Marilyn M	Moore Elizabeth J	
Buyer Name 2	Masdon Marilyn M		
Seller Name	Moore Elizabeth J		
Document Number	401961		

MORTGAGE HISTORY	
Mortgage Date	08/31/2012
Mortgage Amount	\$140,000
Mortgage Lender	Wells Fargo Bk Na
Mortgage Code	Conventional
Borrower Name	Masdon Earl C III
Borrower Name 2	Masdon Marilyn M

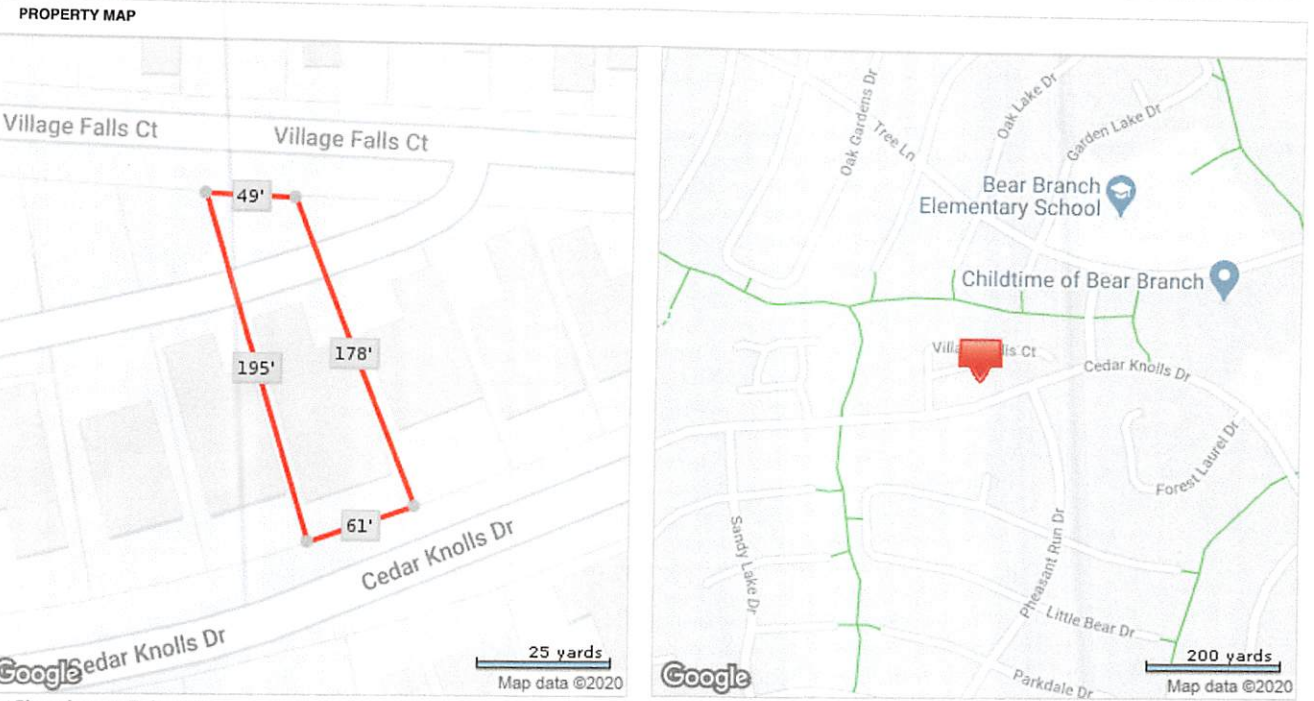

\*Lot Dimensions are Estimated