

PRIVATE R/I

N11°47' BASIS

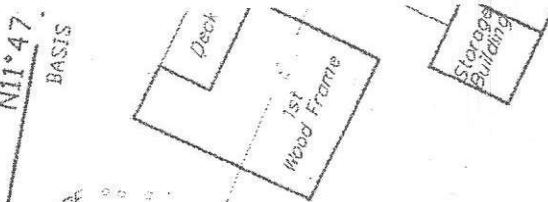

0.547 AC.

N05°02'30"W
14.67'

3/8" IRF
Point of Beginning

N80°30'25"W 244.64'

BEATRICE JOHNSON
VOL. 2045, PG. 19



Set I.R. with
cop stamped
"Honey 6082"

LEGEND

- FOUND IRON ROD
SIZE NOTED
- OVERHEAD ELECTRIC LINE
- PLATTED LOT LINES

NOTES:

1. This property is not within an incorporated city limits.
2. This Plat does not constitute the following:
 - A. Wet Lands determination
 - B. Sub surface determinations
 - C. Environmental assessments
3. No Flood Zone determination was made.

I, ROBERT E. HANEY, REGISTERED PROFESSIONAL LAND SURVEYOR NO. 6082, OF THE STATE OF TEXAS, DO HEREBY CERTIFY THAT THIS PLAT IS TRUE AND CORRECT TO THE BEST OF MY KNOWLEDGE AND BELIEF AND REPRESENTS THE RESULTS OF A SURVEY MADE ON THE GROUND BY MYSELF. THERE ARE NO APPARENT CONFLICTS, DISCREPANCIES, VISIBLE BOUNDARY LINE CONFLICTS, VISIBLE INTRUSIONS, VISIBLE PROTRUSIONS OF IMPROVEMENTS, OR VISIBLE EASEMENTS OR RIGHT-OF-WAYS, EXCEPT AS SHOWN HEREON.

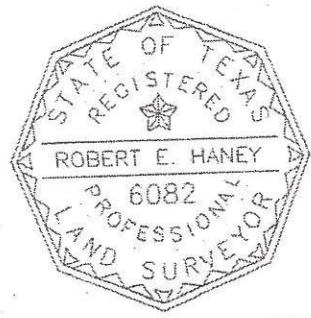

WITNESSED BY MY HAND AND SEAL THIS THE 26TH DAY OF DECEMBER, 2012.

Robert E. Haney 12/26/12
ROBERT E. HANEY, REGISTERED PROFESSIONAL LAND SURVEYOR, NO. 6082

HANEY'S ENGINEERING AND LAND SURVEYING	
P.O. BOX 1564 156 GLENROSE DRIVE HAWKINS, TEXAS	
PHONE (903) 769-9364	CELL (903) 363-8852
SCALE: 1" = 40'	DATE: DECEMBER 26, 2012
JOB # HE0322	D. NAME: HE0322BH2-18

EXHIBIT A

Page 1 of 1 pages

Being all of that certain lot, tract or parcel of land situated in the S.H. Davis Survey, Abstract No. 173, being all of Lot 18 and part of Lots 17 and 19, Block A of Brookhaven in the Pines, Section 2, plat recorded in Volume 4, Page 1, Plat Records of Wood County, Texas, said lot, tract, or parcel of land being more particularly described as follows:

Beginning at a found 3/8" iron rod at the northwest corner of said Lot 19, also being the southwest corner of said Lot 18;

Thence along West line of said Lot 18, North 05 degrees 02 minutes 30 seconds West, a distance of 14.67 feet to a found 1/2" iron rod at an angle point in said West line;

Thence continue along said West line, North 11 degrees 47 minutes 00 seconds East, at 103.36 feet pass a found 1/2" iron rod at the northwest corner of said Lot 18, also being the southwest corner of said Lot 17, continue along the West line of said Lot 17 a total distance of 121.66 to an angle point in West line of said Lot 17;

Thence continue along West line of said Lot 17, North 28 degrees 12 minutes 40 seconds East, a distance of 2.68 feet to a found 1/2" iron rod at the southwest corner of a tract of land conveyed to W.L. Pepsis according to a deed recorded in Volume 2260, Page 519 Real Property Records, Wood County, Texas (RPRWCT);

Thence along South line of said Pepsis tract and crossing said Lot 17, South 61 degrees 37 minutes 41 seconds East, a distance of 251.60 feet to a found 1/2" iron rod at the southeast corner of said Pepsis tract;

Thence along the East line of said Lot 17, South 04 degrees 55 minutes 50 seconds West, at 21.64 feet pass a found 1/2" iron rod at the northeast corner of said Lot 18, at 37.03 feet pass a found 1/2" iron rod at the southeast corner of said Lot 18, continue a total distance of 57.07 feet to a set 1/2" iron rod with cap stamped "Haney 6082" at the northeast corner of a tract of land conveyed to Beatrice Johnson according to a deed recorded in Volume 2045, Page 19 RPRWCT;

Thence along the North line of said Johnson tract and crossing said Lot 19, North 80 degrees 30 minutes 25 seconds West, a distance of 244.64 feet to the POINT OF BEGINNING and containing 0.547 acres of land more or less.