

(1915) CAROLINE DRIVE
(60' ROW)

SCALE
1:50

Found 1" Iron Pipe At P.O.B.

Found 1" Iron Pipe

N 01°02'00"W

150.00'

S 01°02'00"E
466.00'

P.O.C.

V-2743, P-791

290.40'

290.40'

- A= 12' X 12' Frame Shed On Conc
- B= 10' X 16' Metal Shed On Blocks

V-2985, P-108

009-68-2304

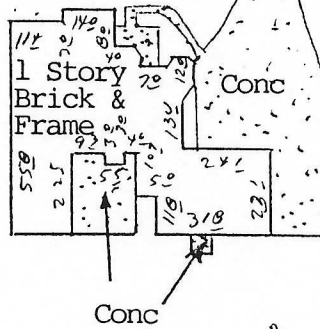

S 88°58'00"W

N 88°58'00"E

S 01°02'00"E

150.00'

Found 1" Iron Pipe

Found 1" Iron Pipe

009-68-2304

Marvin L. Hunter

Barbara K. Hunter

- x-x- = 4' Wire Fence
- // - = 5' Chain Link Fence

BUYER Marvin L. Hunter and,
Barbara K. Hunter

1915 Caroline Drive

DESCRIBED PROPERTY Being a tract or parcel of land out of and a part of the P.G. Merritt Survey, A-155, Galveston County, Texas, as being more particularly described by metes and bounds as attached.