

A plat of a 10.8788 acre tract of land in the Abraham Roberts Survey, Abstract No. 63, in Harris County, Texas, out of and a part of that certain 83.5558 acre tract of land described in deed recorded under Clerk's File No. N323025 of the Official Public Records of Real Property of Harris County, Texas, (OPRRPHCoTx). Said 10.8788 acres also being that same tract of land described in deed to Greg and Darlene Sharp recorded under Clerk's File No. P797944 (OPRRPHCoTx).

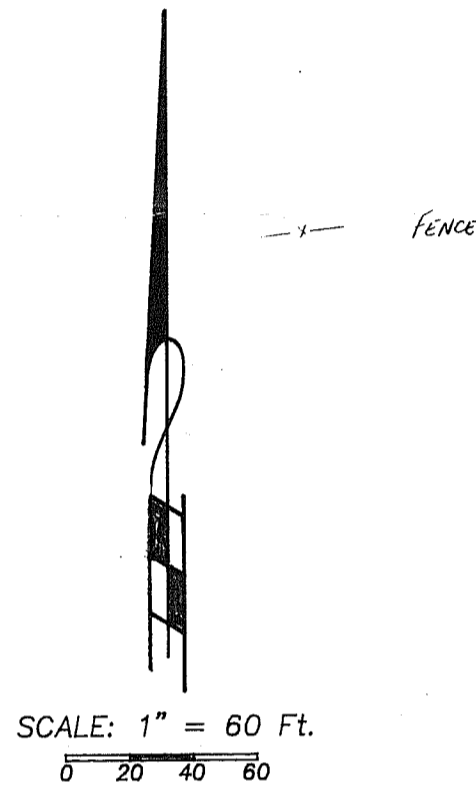

ADDRESS: 21110 BAUER ROAD  
HOCKLEY, TX 77447

G.F.N. 97311071 / FIRST SOUTHWESTERN TITLE COMPANY of TEXAS

LENDER: GULF STATES MORTGAGE

BUYERS: GREG SHARP and DARLENE SHARP

\*-1 PER HCCFN# R859399

\*-2 PER HCCFN# P804752 AND RELOCATED UNDER HCCFN# S166449 & S185417

NOTE #1: Field Notes have also been submitted in conjunction with this plat.

NOTE #2: PIPELINE RECORDED IN VOL. 1112, PG. 206 (HCDR) DOES NOT AFFECT THIS PROPERTY

FLOOD INFORMATION: According to Flood Insurance Rate Map No. 48201C0035 G (Dated Sept. 28, 1990), this property is in Zone "X" and not in the 100-Year Flood Zone.

I do hereby certify that this survey was made by me on the ground of the property described and depicted above and is correct in all that it implies. All improvements are shown and there are no conflicts, discrepancies, shortages in area or boundary lines, or any overlapping of improvements except as shown hereon. All visible easements and rights-of-way are shown.

Signed, stamped, and dated this  
3<sup>RD</sup> day of JUNE, 1996.

**UPDATES/ADDITIONS/REVISIONS:**

- ① JULY 1<sup>ST</sup>, 1996 - UPDATED TO REFLECT RESULTS OF SLAB SURVEY
- ② FEBRUARY 6, 1997 - UPDATED TO REFLECT RESULTS OF "FINAL" SURVEY.

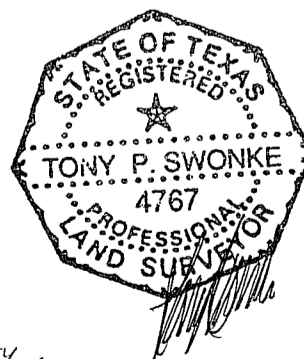

*Darlene Sharp*

Prepared by  
Tony Swonke Land Surveying  
700 Kane St.  
Tomball, TX 77375  
713 351-SRVY 7789

