

LEE BROWN STERLING, JR.
TRUSTEE
CALLED 201.863 ACRES
VOL. 1513, PG. 327

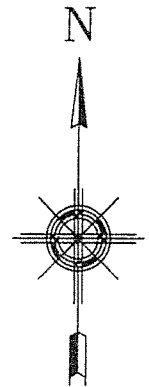

SCALE: 1" = 200'

LEGEND

FOUND

- IRF 1/2" Iron Rod
- IPF 1/2" Iron Pipe
- CMF Concrete Monument
- Barbed Wire Fence
- Chain Link Fence
- Board Fence
- Overhead Electric Line

SET

- IRS 1/2" Iron Rod
- IPS 1/2" Iron Pipe

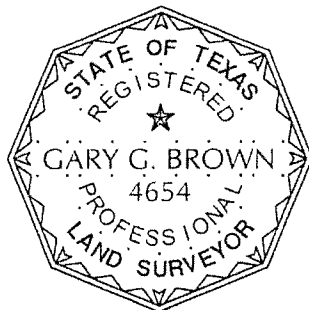

GOODWIN-LASITER, INC.

[Handwritten Signature]
Gary G. Brown
Lufkin, Texas

R.P.L.S. 4654
July 22, 2006

G-L GOODWIN-LASITER, INC.
ENGINEERS - ARCHITECTS
SURVEYORS
1609 S. CHESTNUT ST., SUITE 202 • LUFKIN, TEXAS 75901 • (936) 637-4900 • admin@goodwinlasiter.com
1509 EMERALD PKWY., SUITE 101 • COLLEGE STATION, TEXAS 77845 • (979) 696-6767 • clev@goodwinlasiter.com

DATE 7-22-06	DRAWN BY: KHL	APPROV BY: GGB	SCALE 1"=200'	JOB NUMBER 255312
BOUNDARY SURVEY TRACT 3 - 10.159 ACRES I.D. THOMAS SURVEY, A-74 POLK COUNTY, TEXAS				SHEET NO.

TRACT 3
FIELDNOTE DESCRIPTION OF 10.159 ACRES
I. D. THOMAS SURVEY, ABSTRACT NO. 74
POLK COUNTY, TEXAS

BEING 10.159 acres, more or less, located in the I. D. Thomas Survey, Abstract No. 74 in Polk County, Texas, being part of the called 201.863 acre tract described in a Deed from Copper Station Holdings, LLC to Lee Brown Sterling, Jr., Trustee dated June 9, 2006 and recorded in Volume 1513, Page 327 of the Official Public Records of Polk County, Texas and being more particularly described as follows:

BEGINNING at a 1/2-inch iron rod set in the southwesterly right of way of Farm to Market Highway No. 942 (80 foot right of way) for the northerly corner of the herein described 10.159 acre tract, same being the easterly corner of a 10.179 acre tract created this same day. From said corner, a nail in the center of the said highway for the most northerly corner of the said 201.863 acre tract bears N 41° 43' 47" W 981.71 feet;

THENCE S 43° 31' 13" E 250.00 feet along the said southwesterly right of way to a 1/2-inch iron rod set for the most easterly corner of the said 10.159 acre tract, same being the northerly corner of a 10.320 acre tract created this same day,

THENCE S 42° 30' 07" W 1492.28 feet with the common line of the said 10.159 acre tract and the said 10.320 acre tract to a 1/2-inch iron rod set for the westerly common corner of the said 10.159 acre tract and the said 10.320 acre tract;

THENCE N 20° 33' 49" W 416.00 feet to a 1/2-inch iron rod set for the westerly common corner of the said 10.159 acre tract and the said 10.179 acre tract ;

THENCE N 47° 45' 19" E 1326.76 feet with the common line of the said 10.159 acre tract and the said 10.179 acre tract to the PLACE OF BEGINNING, and containing 10.159 acres, more or less, as shown on the accompanying plat of even date herewith.

This survey was made on the ground under my supervision.

GOODWIN-LASITER, INC.

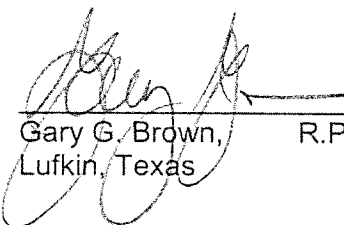

Gary G. Brown, R.P.L.S. No. 4654
Lufkin, Texas July 22, 2006

