

CONSTRUCTION

SPECIFICATIONS

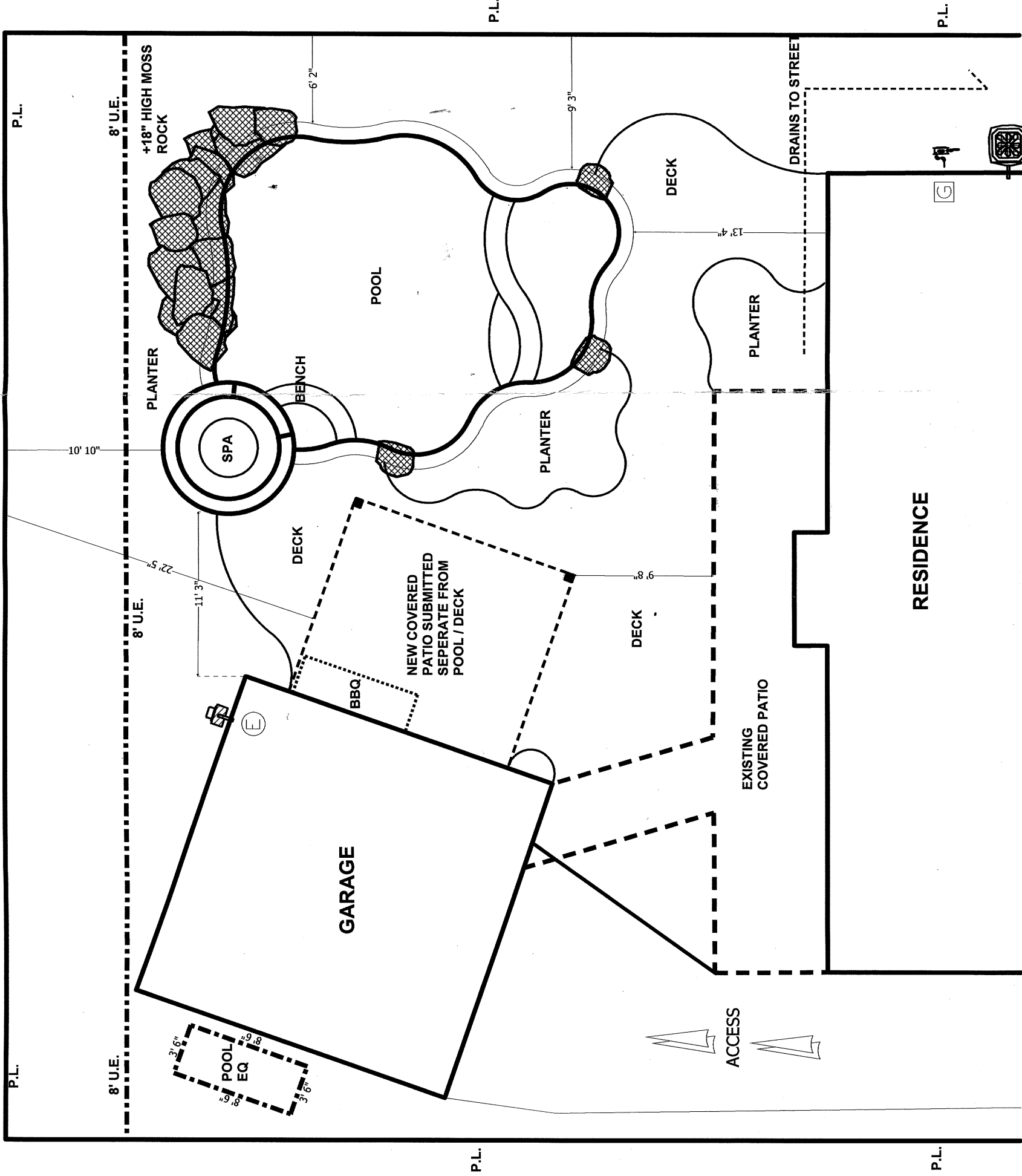

POOL SPECS
 SIZE: 30' X 22'
 PERIMETER: 99' 454 SQ. FT.
 DEPTH: 3.5' - 5'

DECK
 DECK TYPE: ALL STAMPED STAMPED CONC.
 TOTAL DECK SQFT: 901 SQ. FT.
 REINFORCEMENT: 3/8" REBAR AT 15" O.C.
 CAP PATIO: 300 SQ. FT. CONC. REMOVAL: 350 SQ. FT.
 DRAINS: 225' OF 4" HEADS: 11

TILE, COPING and PLASTER
 COPING: FLAGSTONE
 SELECTION: STANDARD TILE
 TILE: STANDARD TILE
 SELECTION: PEBBLE SHEEN (CAT. #1)
 PLASTER: PEBBLE SHEEN (CAT. #1)

EQUIPMENT
 FILTER: PENTAIR CARTRIDGE 420 SQ. FT.
 FILTER PUMP: INTELLI FLO VS3050
 CLEANER: LEGEND PLATINUM
 CHLORINATOR: OZONE ECZ AND INLINE
 HEATER: MASTERTEMP 400K BTU
 GAS LINE: 1/10" WITH REGULATOR

CONTROLS and ELECTRIC
 CONTROL SYSTEM: EASY TOUCH 8
 LIGHTS IN POOL: 500W HALOGEN (2)
 LIGHTS IN SPA: 100W HALOGEN (1)
 LIGHTS IN FALLS: NONE
 ELECTRIC RUNS: 150' WITH JBOX

SPA SPECS
 SIZE: 7' DIAMETER
 RAISED HEIGHT: +18" SIDES: SPLIT FACE TRAVERTINE
 JETS: 6 WATERWAY
 SPILLWAY: TILE OPENING
 FOUNTAIN: NONE AIR: 3 VENTURRI

HYDRAULICS
 RETURNS: 6 SKIMMERS: 2 AUTO
 POOL RUN: 70' SPA RUN: 48'

WATERFEATURES
 #1: 20' LONG / 3 TON MOSS ROCK WEERING WALL
 BOOSTER PUMP: 1.5 HP WHISPERLO
 WATER FEATURE SUCTION: 60' OF 2" RETURN: 75' OF 2"
 #2: NONE
 BOOSTER PUMP: NONE

MISCELLANEOUS
 #1: LANDSCAPE (PKG. 1) + IRRIG. REPAIR & RE-ROUTE
 #2: BBO - 8' / 10 LANDSCAPE LIGHTS W/ 600W TRANS.

Sunset Pools Inc.
 3510 Greenbusch Rd., Katy, TX. 77494
 281-693-4896
 www.sunsetpoolsinc.com

Designed For:
SANDERS FAMILY
 22450 BUCKTROUT LANE.
 Katy, TX. 77449

Key Map
 445 Z

281-347-4251 H
 713-202-0494 DC