

JOHN S. CRAFT SURVEY, A-125

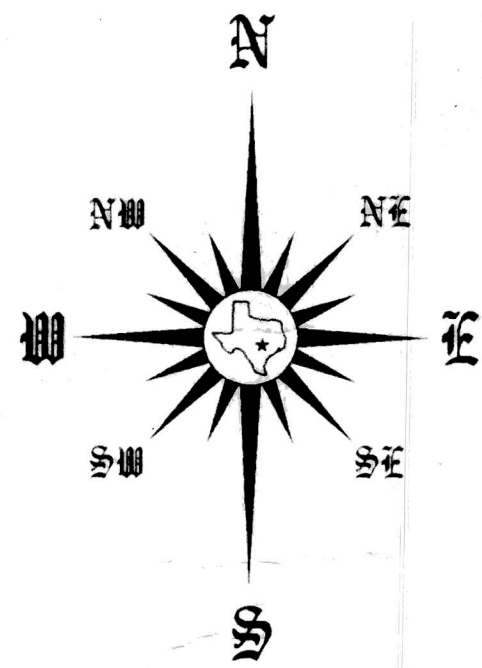

SCALE: 1" = 200'

- IRON ROD FOUND
- IRON PIPE FOUND
- 5/8 IRON ROD SET
- ▲ FENCE POST
- UTILITY POLE
- WATER METER
- WATER WELL
- FENCE LINE
- ELECTRIC LINE

EDGAR H. LEONHARDT, et al
92.2 AC. TR.
Second Tract
179/524 BCDR

Residue of
RANDALL G. SEGAL, et al
92.2 AC. TR.
822/522 BCDR

DARRELL M. WANECK
262.266 AC. TR.
Tract 1
714/331 BCDR

JOE J. RABEL
135 AC. TR.
83/13 BCDR

NO portion of this tract lies within a SPECIAL FLOOD HAZARD AREA designated as such by the Department of Housing and Urban Development, Federal Insurance Administration, as shown on FIRM Number: 48021C 0175C for BASTROP COUNTY, TEXAS.
Effective Date 08/19/91
This Tract lies in Zone(s) X
Base Flood Elevation: None

WARNING:
This Flood Statement, as determined by a H.U.D.-F.I.A. FLOOD HAZARD BOUNDARY MAP, DOES NOT IMPLY that the Property or the Improvements thereon will be free from Flooding or Flood Damage. On rare occasions, Greater Floods Can and Will Occur, and Flood Heights may increase by Man-Made or Natural Causes. THIS STATEMENT SHALL NOT CREATE LIABILITY ON THE PART OF THE SURVEYOR

13.095 ACRES

COUNTY ROAD 238

GEOR. HUFF, et al
34.315 AC. TR.
320/400 BCDR

DELBERT THIESSEN, et al
54.77 AC. TR.
175/755 BCDR

The undersigned does hereby certify to the Title Agency, Underwriter, Lender, Mortgage Co. and/or Purchaser, that this survey was, this day, made on the ground, on the property legally described hereon, and is correct, and there are no discrepancies, conflicts, shortages in area, boundary line conflicts, encroachments, overlapping of improvements, visible utility lines, or roads in place, except as shown hereon, and that said property has access to and from a dedicated road way, except as shown hereon.

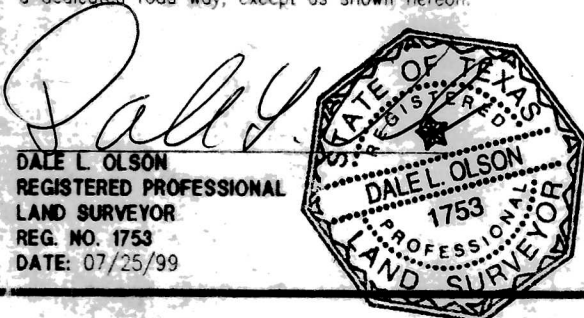

DALE L. OLSON	
REGISTERED PROFESSIONAL LAND SURVEYOR	
711 WATER STREET (512) 321-5476 BASTROP, TEXAS	
SURVEY PLAT	
of a 13.095 ACRE TRACT in the JOHN S. CRAFT SURVEY, A-125, BASTROP COUNTY, TEXAS.	
SCALE: 1" = 200'	GREG HASTING
DRAFTSMAN: D. BAGGETT	DATE: 25 JUL 99
DATE: 25 JUL 99	DISK-FILE 168-21 A ORDER # 116600
	PLAT FILE # 2702 M A