

SCHIVENER HOUSE LANE
(60' R.O.W.)

- NOTES :
- 1.) SUBJECT TO APPLICABLE RESTRICTIVE COVENANTS LISTED IN SCHEDULE B, ITEM NO. 1 OF TITLE COMMITMENT ISSUED BY CHICAGO TITLE CO. UNDER G.F. NO. 264788
 - 2.) H.L. & P. AGREEMENT IN C.F. NO. J617250

- IF CONSTRUCTION UPON OR A DIVISION OF SUBJECT TRACT IS PROPOSED AND IF TRACT LIES IN THE CITY OF HOUSTON OR ITS EXTRATERRITORIAL JURISDICTION, PLATTING AND OTHER REQUIREMENTS MAY APPLY PER CITY OF HOUSTON ORDINANCES.
- ABSTRACTING BY TITLE COMPANY.
- ALL BEARINGS SHOWN ARE REFERENCED PER RECORDED PLAT OF SAID SUBDIVISION.

LOT: 25		BLOCK: 26	SUBDIVISION: WILLIAMSBURG HAMLET		SECTION: 4
COUNTY: HARRIS	STATE: TEXAS	RECORDATION: VOL. 322, PG. 144 H.C.M.R.	SURVEY: -	SCALE: 1"=20'	
PURCHASER: SAMUEL AARON VICKERS			FIELD WORK: 11-22-00/GG	FINAL CHECK: -	
ADDRESS: 24306 SCHIVENER HOUSE LANE, KATY, TEXAS			DRAFTING: 11-27-00/RISSA	KEY MAP: 445 S	



ALLTEX
REALTY SERVICES
REAL ESTATE SURVEY DIVISION
9810 LONGPOINT, SUITE 150
HOUSTON, TEXAS, 77055
TEL: (713) 468-7707
FAX: (713) 468-8815

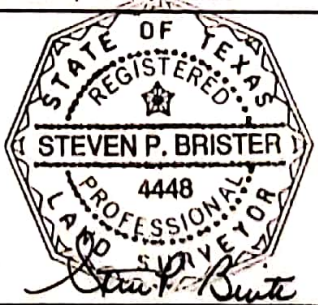

I DO HEREBY CERTIFY THAT THIS PLAT REPRESENTS THE RESULT OF A SURVEY MADE ON THE PROPERTY DESCRIBED HEREON.

* SUBJECT PROPERTY IS NOT LOCATED IN A FEDERAL INSURANCE ADMINISTRATION DESIGNATED FLOOD HAZARD AREA & IS IN ZONE "X"
AS PER MAP 480287
PANEL 0595 DATED NOV. 08, 1996

* THIS INFORMATION IS BASED ON GRAPHIC PLOTTING ONLY. WE DO NOT ASSUME RESPONSIBILITY FOR EXACT DETERMINATION.

MORT. CO.	WELLS FARGO
TITLE CO.	CHICAGO TITLE CO.
G.F. NO.	264788
JOB NO.	00 - 34766
REV. DATE	-