

TUBA CITY DRIVE (60' R.O.W.)

BOUNDARY SURVEY OF 2502 TUBA CITY DRIVE

- NOTES:**
1. Found or set iron rods at all corners, unless noted otherwise.
 2. Bearings, easements and building lines shown are by record and unless noted otherwise.
 3. Lot subject to restrictions as recorded under instrument no. 2016055269 of the Map Records and under Clerk's File No.(s) 2008043489, 2008063662, 2009003687, 2011015379, 2011020178, 2011064853, 2013060286, 2016009344, 2016059373, 2016059808, 2016059613, 2016059808, 2017021301 and 2017021302.
 4. Easement for certain utilities as recorded under County Clerk's file no. 2016038486.
 5. An easement or right-of-way granted to White Oil Pipe Line Company as recorded in Volume 321, Page 512 of the Deed Records of Galveston County, Texas. (No evidence of pipeline across this lot)
 6. An easement or right-of-way granted to Standish Pipe Line Company, as recorded in Volume 591, Page 273 of the Deed Records of Galveston County, Texas. (No evidence of pipeline across this lot)
 7. An easement granted to Galveston County Municipal Utility District No. 14 and No. 15, as recorded under Clerk's File No. 8835074. (Does not affect this lot)
 8. A drainage easement granted to the City of League City, Texas as recorded under Clerk's File No. 2008011046. (Does not affect this lot)

CERTIFICATION
SHANKS ENGINEERING & SURVEYING, INC.
 FIRM F13467
 1446 PIRATES COVE 281-488-1486
 HOUSTON, TX 77058 FAX 281-231-2500

THIS PLAT IS AN ACCURATE REPRESENTATION OF THAT SURVEY MADE ON THE GROUND UNDER MY SUPERVISION. THERE ARE NO APPARENT ENCROACHMENTS OR CONFLICTS ACROSS PROPERTY LINES AT THE TIME OF THIS SURVEY, EXCEPT AS SHOWN HEREON.

PROPERTY INFORMATION
 LOT 1 BLOCK 11
 SUBDIVISION SEDONA SECTION 5
 RECORDING INSTRUMENT NO. 2016055269 G.C.M.R.

FLOOD INFORMATION
 F.I.R.M. NO. 4854890030 E DATED 11/22/99 ZONE X
 Flood information provided hereon is based on scaling the location of the subject tract on the flood insurance rate maps. The information should be used to determine flood insurance rates only and is not intended to identify specific flooding conditions. We are not responsible for the F.I.R.M.'s accuracy.

DRAWING INFORMATION
 DATE: 11/22/17
 REVISED:
 SURVEY BY: T.S.
 DRAWN BY: T.S.
 FOR: Excel Title
 GF#17000112CDR
 PURCHASER:

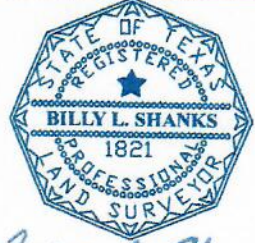

Billy L. Shanks