

Building Sketch (Page - 1)

Borrower/Client				
Property Address 1005 S Shepherd Dr Apt 211				
City	Houston	County	State	TX
		Zip Code	77019	
Lender				

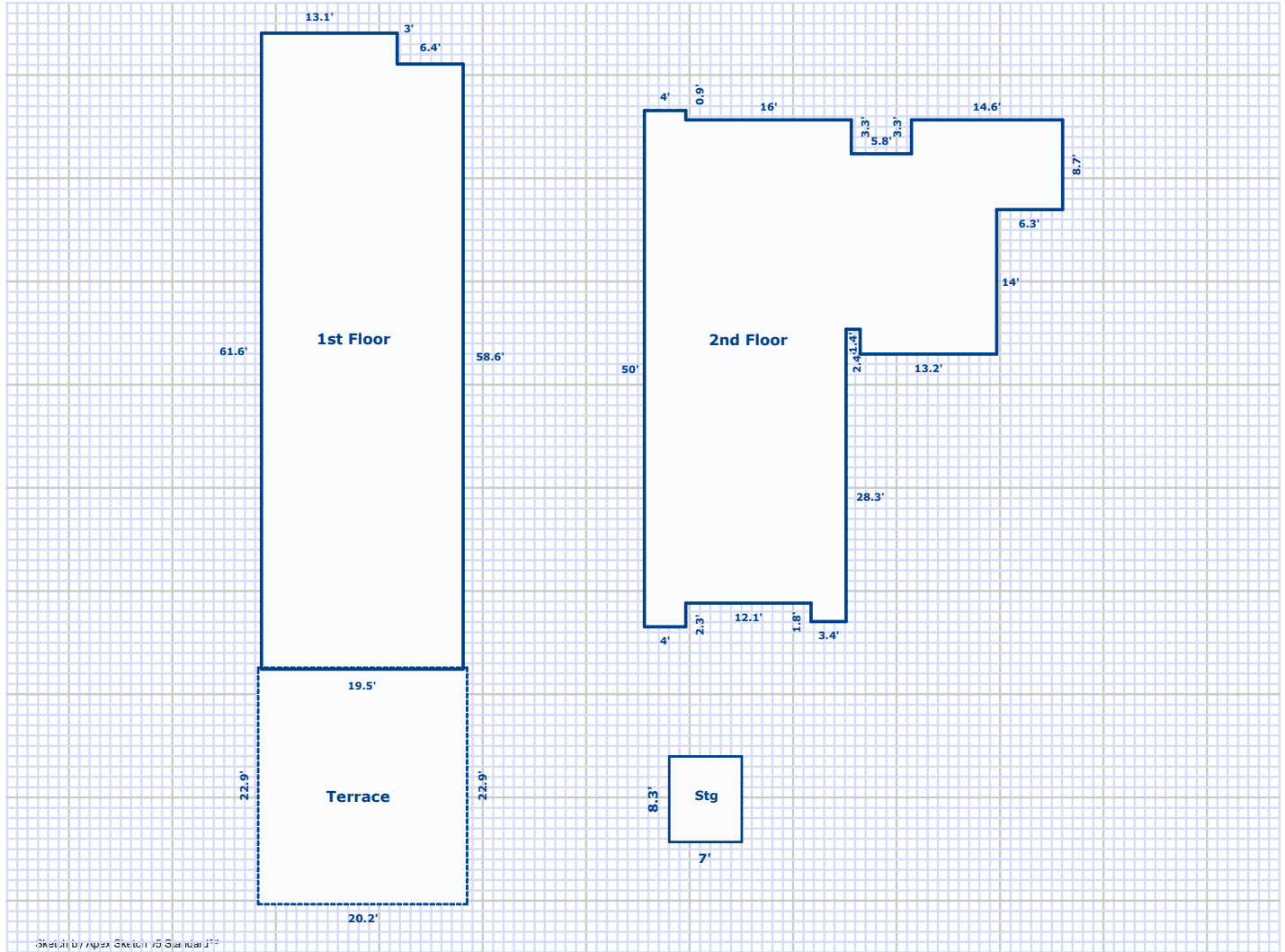

Comments: Per Fannie Mae: The sketch of the unit includes the interior perimeter unit dimensions rather than exterior building dimensions. However, there are some condominium developments in which the areas of individual condo units reported by the condominium association and by the assessing authority include the units' pro rata share of all areas not simply the sum of the interior dimensions of living areas measured. Fannie Mae Selling Guide: Estimates for gross living areashown in the condo documents are acceptable.

AREA CALCULATIONS SUMMARY			
Code	Description	Net Size	Net Totals
GLA1	First Floor	1182.12	1182.12
GLA2	Second Floor	1294.79	1294.79
P/P	Terrace	462.58	462.58
OTH	Storage	58.10	58.10
Net LIVABLE Area		(rounded)	2477

LIVING AREA BREAKDOWN			
Breakdown			Subtotals
First Floor			
19.5	x	58.6	1142.70
3.0	x	13.1	39.42
Second Floor			
3.4	x	1.8	6.12
19.5	x	26.5	516.75
2.3	x	4.0	9.20
0.9	x	4.0	3.60
3.3	x	20.0	66.00
3.3	x	14.6	48.18
5.4	x	40.4	218.16
2.4	x	13.2	31.68
11.6	x	34.1	395.10
11 Items		(rounded)	2477

Building Sketch (Page - 2)

Borrower/Client				
Property Address 1005 S Shepherd Dr Apt 211				
City	Houston	County	State	TX Zip Code 77019
Lender				

<p>First Floor</p> <p>19.5 x 58.6 = 1142.70 3.0 x 13.1 = 39.42</p>	<p style="text-align: right;">GLA1</p>
--	---

<p>Second Floor</p> <p>3.4 x 1.8 = 6.12 19.5 x 26.5 = 516.75 2.3 x 4.0 = 9.20 0.9 x 4.0 = 3.60 3.3 x 20.0 = 66.00 3.3 x 14.6 = 48.18 5.4 x 40.4 = 218.16 2.4 x 13.2 = 31.68 11.6 x 34.1 = 395.10</p>	<p style="text-align: right;">GLA2</p>
---	---

Area total (rounded) = 1182

Area total (rounded) = 1295

<p>Terrace</p> <p>0.5 x 0.0 x 22.9 = 0.00 0.5 x 20.2 x 0.0 = 0.00 20.2 x 22.9 = 462.58</p>	<p style="text-align: right;">P/P</p>
---	--

<p>Storage</p> <p>8.3 x 7.0 = 58.10</p>	<p style="text-align: right;">OTH</p>
--	--

Area total (rounded) = 463

Area total (rounded) = 58