

### Building Sketch

Borrower/Client	Christine Moore			
Property Address	2827 Misty Health Lane			
City	Houston	County	Harris	State TX Zip Code 77082
Lender	N/A			

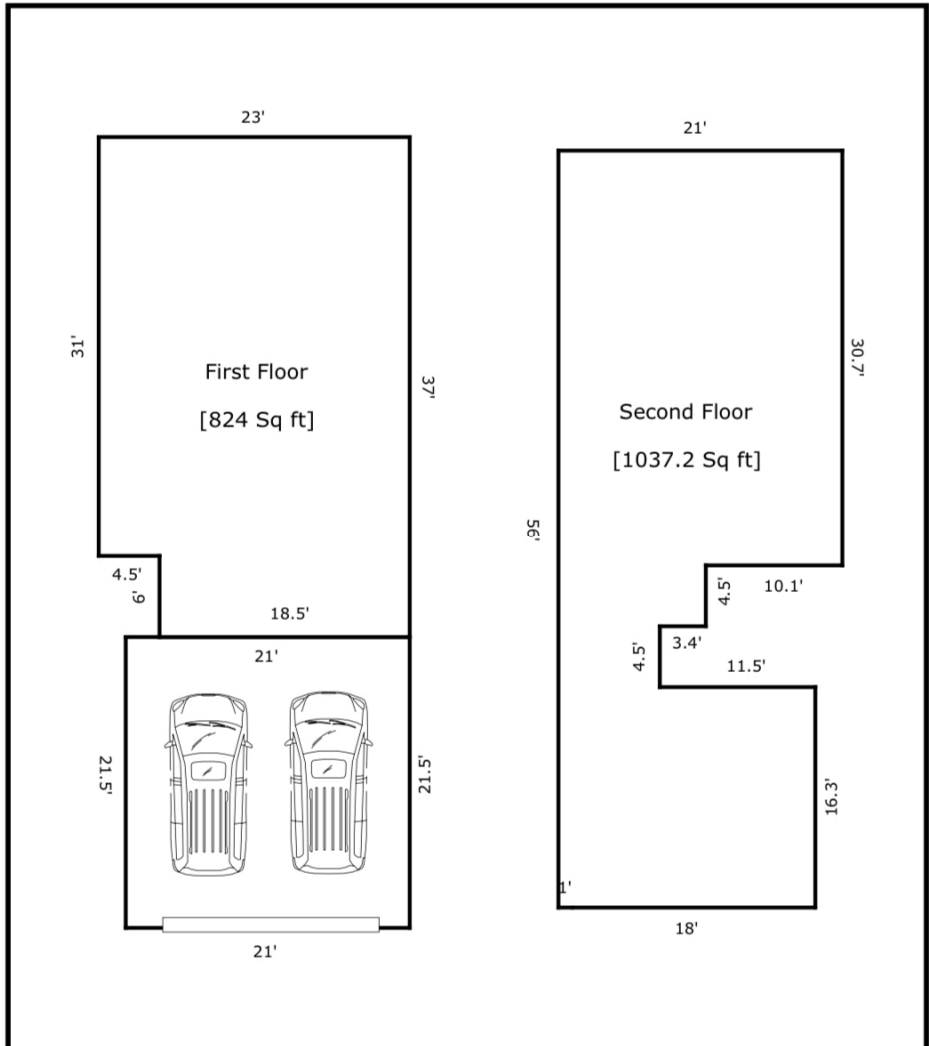

TOTAL Sketch by a la mode, inc.

#### Area Calculations Summary

Living Area	Area	Calculation Details
First Floor	824 Sq ft	$23 \times 31 = 713$ $6 \times 18.5 = 111$
Second Floor	1037.2 Sq ft	$19 \times 16.3 = 309.7$ $7.5 \times 4.5 = 33.75$ $10.9 \times 4.5 = 49.05$ $30.7 \times 21 = 644.7$
<b>Total Living Area (Rounded):</b>	<b>1861 Sq ft</b>	
<b>Non-living Area</b>		
2 Car Attached	451.5 Sq ft	$21.5 \times 21 = 451.5$