

Building Sketch

Borrower	N/A			
Property Address	19014 Shay Ln			
City	Humble	County Harris	State TX	Zip Code 77346
Lender/Client	Christopher and Christine Rayburn			

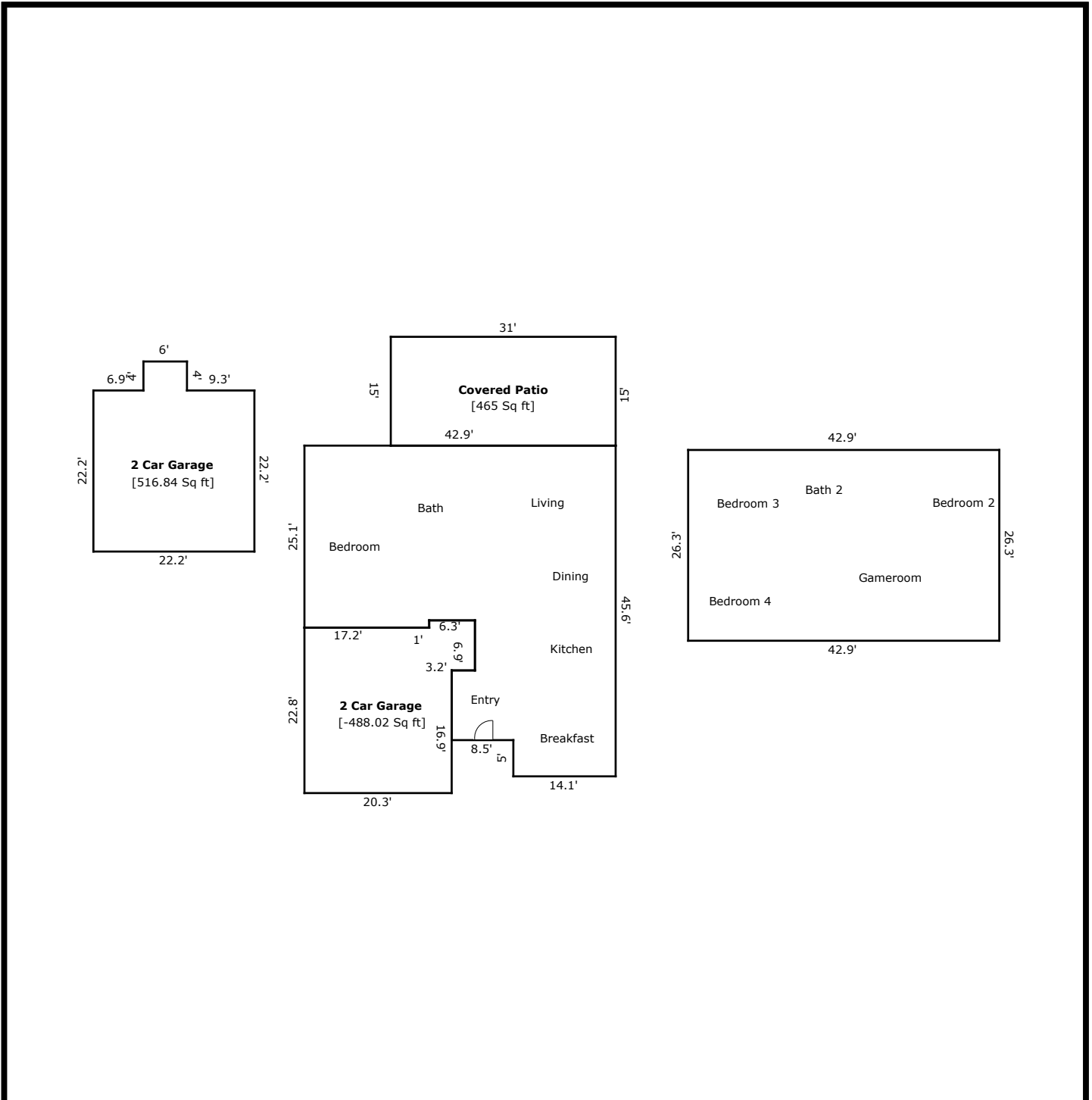

TOTAL Sketch by a la mode, inc.

Area Calculations Summary

Living Area	Calculation Details	
First Floor	1472.41 Sq ft	$25.1 \times 17.2 = 431.72$ $25.7 \times 24.1 = 619.37$ $21.5 \times 14.1 = 303.15$ $8.5 \times 9.6 = 81.6$ $5.3 \times 6.9 = 36.57$
2 Car Garage	-488.02 Sq ft	$20.3 \times 16.9 = 343.07$ $6.9 \times 6.3 = 43.47$ $5.9 \times 17.2 = 101.48$
Second Floor	1128.27 Sq ft	$26.3 \times 42.9 = 1128.27$
Total Living Area (Rounded):	2601 Sq ft	
Non-living Area		
2 Car Garage	516.84 Sq ft	$6 \times 4 = 24$ $22.2 \times 22.2 = 492.84$
Covered Patio	465 Sq ft	$31 \times 15 = 465$