

- NOTES :
- 1.) RESTRICTIVE COVENANTS AS SET OUT IN H.C.M.R. VOL. 291 PG. 58; H.C.C.F. J-943856
 - 2.) 5' HLP ESMT. H.C.C.F. J265692
 - 3.) HLP AGREEMENT H.C.C.F. H238806
 - 4.) CABLE TV AGREEMENT H.C.C.F. G962962

SURVEYOR HAS NOT ABSTRACTED SUBJECT PROPERTY. SURVEY IS BASED ON TITLE COMMITMENT LISTED BELOW. ALL BEARINGS SHOWN ARE REFERENCED PER RECORDED PLAT OF SAID SUBDIVISION. THIS SURVEY IS CERTIFIED FOR THIS TRANSACTION ONLY. IT IS NOT TRANSFERABLE TO ADDITIONAL INSTITUTIONS OR SUBSEQUENT OWNERS.

HOLLY BRANCH DRIVE

LOT	BLOCK	SUBDIVISION	SECTION
513	16	WILLOW FOREST SUBDIVISION	2
COUNTY	STATE	RECORDED	SCALE: 1" = 30'
HARRIS	TEXAS	VOLUME 291 PAGE 58 H.C.M.R.	
PURCHASER: JONATHAN UNGER AND NIFI D. UNGER		ADDRESS: 22527 HOLLY BRANCH DRIVE, TOMBALL, TEXAS 77375	

QUALIFIED REAL ESTATE SERVICES

9800 RICHMOND AVENUE
SUITE 490
HOUSTON, TEXAS 77042
TEL: (713) 266-2990
FAX: (713) 266-3080

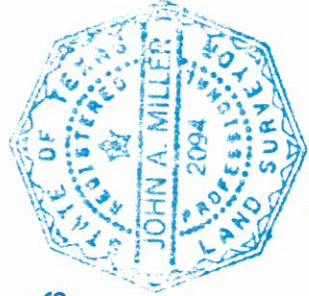

John A. Miller
JOHN A. MILLER
R.P.L.S. NO. 2094

DATED	BY
6-12-96	SB
6-12-96	BB
290J	

I DO HEREBY CERTIFY THAT THIS SURVEY WAS THIS DAY MADE ON THE GROUND OF THE PROPERTY LEGALLY DESCRIBED HEREON AND IS CORRECT, AND THERE ARE NO ENCROACHMENTS UNLESS SHOWN HEREON.

MORT. CO.	MORTGAGES DIRECT
TITLE CO.	TEXAS AMERICAN
G.F. NO.	475-06-4157
JOB NO.	96-06064
REV. DATE	

Subject Property - 18 - Located in
Federal Insurance Administration Designated Flood
Hazard Area. ZONE - AE
As per map 480287
Panel 0045H Dated 9-30-92
* THIS INFORMATION IS BASED ON GRAPHIC PLOTTING ONLY. WE DO NOT ASSUME RESPONSIBILITY FOR EXACT DETERMINATION.