

NOTES:

1. ALL BEARINGS SHOWN HEREON ARE BASED ON THE RECORDED PLAT.
2. SUBJECT TO APPLICABLE RESTRICTIVE COVENANTS LISTED IN ITEM No.1, SCHEDULE "B" OF TITLE COMMITMENT ISSUED BY WFG NATIONAL TITLE INSURANCE Co. UNDER G.F. No. PT1647129.

© 2016, ALLPOINTS SERVICES, CORP., All Rights Reserved. This original work is protected under copyrights laws, Title 17 U.S. Code Sections 101 & 102. All violators will be prosecuted to the extent of the law. This survey is being provided solely for the use of the recipients and no license has been created, express or implied, to copy the survey except as is necessary in conjunction with the original transaction, which shall take place within ninety (90) days from the date adjacent to the signature line herein.

FLOOD MAP:
 THIS PROPERTY LIES IN ZONE "X"
 AS DEPICTED ON COMMUNITY PANEL
 No. 48339 C 0600 G, DATED: 08-18-14
 *THIS INFORMATION IS BASED ON GRAPHIC PLOTTING.
 WE DO NOT ASSUME RESPONSIBILITY FOR EXACT
 DETERMINATION*

PLAT OF SURVEY
 SCALE: 1" = 20'

FOR: CHASE A. DUPLANTIS
 MANIEKA S. GOLDEN
 ADDRESS: 18203 CUSHMAN
 DRIVE
 ALLPOINTS JOB #: LL116205DM
 G.F.: PT1647129



ALLPOINTS
 SERVICES CORP
 PHONE: 713-468-7707
 T.B.P.L.S. No. 10122600

LOT 7, BLOCK 3,
 TAVOLA, SECTION 5,
 CAB. Z, SHTS. 3143-3145, MAP RECORDS,
 MONTGOMERY COUNTY, TEXAS

I HEREBY CERTIFY THAT THIS PLAT REPRESENTS THE
 RESULTS OF A SURVEY MADE ON THE GROUND, ON THE 31ST
 DAY OF AUGUST, 2016.

Steven P. Brister

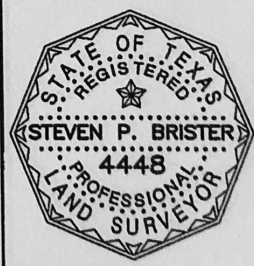

CD 1160