

DESIGNER INFORMATION



BUYER NAME	SHOWCASE
ADDRESS	9130 ESKESON DRIVE
COMMUNITY	BRIDGE CREEK 45
DESIGNER	JULIE COLEMAN
Q#	Q-44659
DATE	4/1/2020
NOTES	

Division: Texas Houston - Homebuilding

Community: Bridge Creek 45s (TM)

Lot Number: LOT #07 (040107)

Quote Number: Q-44659

Model: Jasmine (Elevation: C)

Buyer(s):

Co-Buyer:

Address: 9130 Eskesen Drive, Cypress, TX, 77433

Swing: Right

Date Printed: 04/01/2020

Product Code	Name	Qty	List Unit Price	Total Price
(Order #: To Be Approved)				
<i>Category: 10 Kitchen/Bar - Sinks</i>				
PK209UMSS	Sink - 9" - SS - 50/50 Undermount Mirado 209	1.00	\$0.00	\$0.00
<i>Category: 10 Light Fixtures</i>				
LFIN0001089	Light Fix Pkg - Jolie Brushed Nickel	1.00	\$0.00	\$0.00
<i>Category: 10 Non Standard</i>				
CUST1014	Custom Interior Specialties 52" Starkk LED - Int Ceiling Fan 330174 NI - Reversible Silver/Walnut Blades 3-speeds - MSTR BDRM	1.00	\$375.00	\$375.00
CUST1013	Custom Interior Specialties Kitchen Fixture-Align-5923 Chrome	1.00	\$155.00	\$155.00
CUST1012	Custom Interior Specialties Hatteras Bay Pendant 2666PN polished Nickel. Fixture only. Includes bulbs..	2.00	\$250.00	\$500.00
CTOP0001	Countertop Pre-Bill SEE BUYER SELECTION REPORT AND REDLINE FOR DETAILS	1.00	\$4,271.00	\$4,271.00
CUST1011	Custom Interior Specialties TL LEVEL 1 DOOR STYLE: TAHOE COLOR: EMBER GLAZE PREMIUM FINISH. KITCHEN - \$390. iSLAND - \$70. MSTR BATH \$60, BATH 2 - \$40	1.00	\$560.00	\$560.00

CUST1010	Custom Interior Specialties <i>PULL OUT TRASH DRAWER GWST0001C</i>	1.00	\$450.00	\$450.00
CUST9620	Custom Wall Tile <i>SEE BUYER SELECTION REPORT AND REDLINE FOR DETAILS</i>	1.00	\$528.00	\$528.00
CUST9615	Custom Tile B/S <i>SEE BUYER SELECTION REPORT AND REDLINE FOR DETAILS</i>	1.00	\$1,628.00	\$1,628.00

Category: 10 Paint

PTSC00000	Paint-Base- Whole House Interior Walls, Ceilings, doors and trim *Latex Flat* <i>SW 7646 FIRST STAR</i>	1.00	\$0.00	\$0.00
PTSC00005	Paint-Base Trim Color <i>SW 7006 EXTRA WHITE</i>	1.00	\$0.00	\$0.00

Category: 12 Ceiling Fans

CFIN0001550	52" Starkk LED - Int Ceiling Fan 330174 NI - Reversible Silver/Walnut Blades 3-speeds <i>FAM ROOM</i>	1.00	\$0.00	\$0.00
-------------	--	------	--------	--------

Category: 14 Outlet, Switches, and Cans

ELOP00000	note: Switch Plate Cover Color <i>WHITE</i>	1.00	\$0.00	\$0.00
-----------	--	------	--------	--------

Category: 16 Dishwasher

APDW00SS03	GSD3360KSS - Built-In Dishwasher w/ Front Control	1.00	\$0.00	\$0.00
------------	---	------	--------	--------

Category: 18 Interior Door Upgrades

TRIDALL00ST	Interior Door Style <i>CAIMAN SMOOTH</i>	1.00	\$0.00	\$0.00
-------------	---	------	--------	--------

Category: 18 Micro Hood

APMH00SS07	JVM3162RJSS - 1.6 cuft Over the Range Microwave	1.00	\$0.00	\$0.00
------------	---	------	--------	--------

Category: 20 Baths - Fixtures/Faucets

PB4925CH4	Lavatory - Chateau - Centerset - 4925 <i>BATH 2</i>	1.00	\$0.00	\$0.00
PB4945CH8	Lavatory - Chateau- Widespread - 4945 <i>MSTR AND 1/2 BATH</i>	1.00	\$0.00	\$0.00

Category: 20 Range

APRG00SSG06	JGB635REKSS 30" Free-Standing Gas Range SS	1.00	\$0.00	\$0.00
-------------	--	------	--------	--------

Category: 22 Baths - Shwr Fixt Upgrade:

PB182CH0	Shower-Chateau-TL182+2520 MSTR SHOWER	1.00	\$0.00	\$0.00
----------	--	------	--------	--------

PB183CH0	Tub/Shower-Chateau - TL183+2520 BATH 2	1.00	\$0.00	\$0.00
----------	---	------	--------	--------

Category: 22 Door Hardware

TRHW2234INT	Interior Knobs-Plymouth (replace Stratus)	1.00	\$0.00	\$0.00
-------------	---	------	--------	--------

TRHW2168EXT	Handleset-Plymouth - (replaces Barcelona)	1.00	\$0.00	\$0.00
-------------	---	------	--------	--------

TRHWC100PKG	Taymor Bath Hardware CHROME - TA7924 - TOWEL BAR 1 PER BATH, TA7908 PAPER HOLDER- 1 PER BATH, TA7904 - 2 IN MSTR AND 1 PER SECONDARY	1.00	\$0.00	\$0.00
-------------	--	------	--------	--------

(Order #: 1 - 2/10/2020)

Category: 12 Garage Accessories / Styles

GAACGARA01	Garage Door Opener (per door)	1.00	\$0.00	\$0.00
------------	-------------------------------	------	--------	--------

GAACGARK00	Garage Door Key Pad	1.00	\$0.00	\$0.00
------------	---------------------	------	--------	--------

Category: 14 Landscape

LNPk0000	Irrigation Sprinkler System - oversized and corner	1.00	\$0.00	\$0.00
----------	--	------	--------	--------

LNSO0000	Backyard Sod	1.00	\$0.00	\$0.00
----------	--------------	------	--------	--------

Category: 18 Rooms/Baths

OC1BAYA00	Bay Window at Owner's Suite	1.00	\$3,860.00	\$3,860.00
-----------	-----------------------------	------	------------	------------

OC1MEDA00	Media Room upstairs - includes - (1) universal provider combo outlet (1 cat5e x 1 rg6), (1) projector conduit, (1) room of 5.1 surround sound prewire only	1.00	\$9,950.00	\$9,950.00
-----------	--	------	------------	------------

OC1OBTA01ST	Shower 1 / Mud-set at Owner's Bath	1.00	\$1,550.00	\$1,550.00
-------------	------------------------------------	------	------------	------------

Category: 20 Outdoor Living

OC1ODLA01	Covered Outdoor Living #1	1.00	\$0.00	\$0.00
-----------	---------------------------	------	--------	--------

Category: Light Fixtures

LFPNCAN0342	Hatteras Bay Pendant 2665PN Existing Circuit	1.00	\$0.00	\$0.00
-------------	--	------	--------	--------

Category: Low Voltage

LVPK1002C	LOW-VOLT PKG 2 SECURITY & AUTOMATION READY TM1002	1.00	\$0.00	\$0.00
-----------	--	------	--------	--------

Category: Plumbing

OC2000G00C	Gas Stub Out - Canvas	2.00	\$0.00	\$0.00
------------	-----------------------	------	--------	--------

(Order #: 2 - 3/27/2020)**Category: 10 Exterior Color Packages**

OCEXCLT700	Color Palette - Traditional T6 Trim - Gutters(Per ext color coded elevation) - Pussywillow - SW7643 Trim - Garage, Cedar Accents,Gutters(Per elev - Dove Trail - SW7018 Shutters - Iron Ore - SW7069 Roof - Weathered Wood, Metal Roof (Per Plan) - Slate GrayBrick - Merdian - Summer Ash - Mortar Grey Window - Sandsto	1.00	\$0.00	\$0.00
------------	---	------	--------	--------

Category: 10 Non Standard

CARP0001	Carpet Pre-Bill <i>SEE BUYER SELECTION REPORT AND REDLINE FOR DETAILS</i>	3540.00	\$0.00	\$0.00
WOOD0001	Wood Pre-Bill <i>SEE BUYER SELECTION REPORT AND REDLINE FOR DETAILS</i>	8980.00	\$0.00	\$0.00
TILE0001	Tile Pre-Bill <i>SEE BUYER SELECTION REPORT AND REDLINE FOR DETAILS</i>	2417.00	\$0.00	\$0.00

Category: 10 Stone/Brick

EXBRR000	Brick rear ilo of siding	1.00	\$0.00	\$0.00
EXBRR100	Brick Rear - 1st Floor	1.00	\$0.00	\$0.00
EXBRS100	Brick Sides - 1st Floor	1.00	\$0.00	\$0.00

Category: 14 Outlet, Switches, and Cans

ELCFPE0001	Lighting Prewire - Interior on Existing Switch up to 50 pound fixture	2.00	\$0.00	\$0.00
ELFM0T000	1-6" LED Flush Mount with addtl 3 way switch. 43846WHLED30. White finish.	4.00	\$0.00	\$0.00
ELSU00000	Electrical Panel in Garage	1.00	\$0.00	\$0.00

Sub Total	\$23,827.00
Lot Premium	\$0.00
Base Price	\$0.00
Option Total	\$23,827.00
Incentive Given	\$0.00
Total Purchase Price	\$23,827.00

CANCELLED OPTIONS

Product Code	Date Cancelled in NSE	Name	Qty	List Unit Price	Total Price
--------------	--------------------------	------	-----	--------------------	-------------

Category: 10 Non Standard

CTOP0001	Not cancelled in NSE	Countertop Pre-Bill <i>SEE BUYER SELECTION REPORT FOR DETAILS.</i>	5712.00	\$0.00	\$0.00
----------	-------------------------	---	---------	--------	--------

Category: 10 Paint

PTSC00005	Not cancelled in NSE	Paint-Base Trim Color	1.00	\$0.00	\$0.00
PTSC00000	Not cancelled in NSE	Paint-Base- Whole House Interior Walls, Ceilings, doors and trim *Latex Flat*	1.00	\$0.00	\$0.00

Category: 14 Outlet, Switches, and Cans

ELDS0000	Not cancelled in NSE	Decor Switches	1.00	\$0.00	\$0.00
----------	-------------------------	----------------	------	--------	--------

Category: 22 Door Hardware

TRHWC100PKG	Not cancelled in NSE	Taymor Bath Hardware	1.00	\$0.00	\$0.00
-------------	-------------------------	----------------------	------	--------	--------

This system-generated *Proposal* is provided to a prospective buyer and/or its Broker/Agent outside of and not made a part of the Purchase Agreement: (1) all information as of the date indicated remains subject to change at any time without notice or obligation; and (2) is for illustrative and informational purposes only for preliminary discussions for prospective buyer's convenience. No guarantee or representation is made or implied as to availability, manufacturer, style, size, color, number, pricing and other factors installed in the completed home and/or subject to applicable incentives (if any) affecting pricing, all of which Seller reserves the right to modify. Refer to the final executed: Purchase Agreement and its attached Addenda (inclusive of any post-purchase amendments thereto) and the specific Community's Standard Features List for complete details. Equal Housing Builder.

BUYER: spec 9130 E	DESIGNER: Julie Coleman	SALES COUNSELOR: Other/Unknown	CATALOGDATE: 3/31/2020 5:04:52 PM	JOB NUMBER: Q-44659	
ADDRESS: 9130 ESKESON DRIVE	LOT/BLOCK:	COMMUNITY: Bridge Creek 45	SERIES: Aspire	PLAN: Jasmine	ELEV: NA

Appliances

DISHWASHERS

GSD3360KSS DISHWASHER

Vendor: GE

Price: \$0.00 (x) 1

Extended Price: \$0.00

DISHWASHERS SUBTOTAL: \$0.00

MICROWAVES

JVM3162RJSS MICROWAVE

Vendor: GE

Price: \$0.00 (x) 1

Extended Price: \$0.00

MICROWAVES SUBTOTAL: \$0.00

RANGES

JGB635REKSS RANGE

Vendor: GE

Price: \$0.00 (x) 1

Extended Price: \$0.00

RANGES SUBTOTAL: \$0.00

Appliances Total: \$0.00

Cabinets

CABINETS

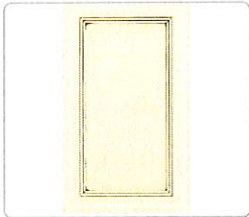

PHOTO ONLY. PRICE AND LOCATION ON THE ORA

Area: ALL CABINETS

Price: \$0.00 (x) 1

Extended Price: \$0.00

CABINETS SUBTOTAL: \$0.00

Cabinets Total: \$0.00

Countertops

FABRICATED CTOPS

- Bath 2 Vanity
- Owners Bath Vanity

Marlana Level 2



Countertop Color:
1.6cm Fin Marlana - Symphony
Id: OPF1.6CM/13



Countertop Edge:
Laminated Square Edge (11) -
Engineered Marble 3.2c
Id: SEM2

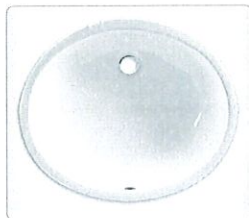

Sink:
Mirado China Bowl 1519 - White
Id: OMRDOCHINA/1

Area Subtotal(s)

Bath 2 Vanity: \$120.00
Owners Bath Vanity: \$210.00

- Kitchen w/Range/Island

Level 5 Granite, Omegastone, Artisan and Specilaty Stone

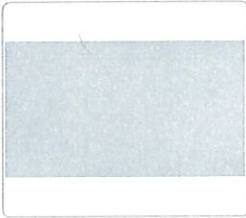

Countertop Color:
2cm Fin Omega Stone-Zebrino
Id: OOMS2CM/BO



Countertop Edge:
Square Edge - 1 1/2" - Stone (41)
Id: SES3



Sink:
Mirado 209 - Stainless Steel U/M Sink
Id: OPION802-9/1

Area Subtotal(s)

Kitchen w/Range/Island: **\$3,826.67**

- Master Bath Shower Window Sill

Marlana Level 2



Countertop Color:
1.6cm Fin Marlana - Symphony
Id: OPF1.6CM/13



Countertop Edge:
Laminated Square Edge (11) -
Engineered Marble 3.2c
Id: SEM2

Area Subtotal(s)

Master Bath Shower Window Sill: **\$115.00**

FABRICATED CTOPS SUBTOTAL: **\$4,271.67**

Countertops Total: \$4,271.67

Doors

INTERIOR DOORS



CAIMAN SMOOTH
 Vendor: Jeldwen
 Price: \$0.00 (x) 1
 Extended Price: \$0.00

INTERIOR DOORS SUBTOTAL: \$0.00

Doors Total: \$0.00

Flooring

CARPET

- All Carpeted Areas w/Opt Media Room -A,B,C,D
- Gathering Room Credit
- Opt Bay Window at Owners Suite
- Study/Opt Flex Room Credit

Carpet Level 5



Carpet Color:
 Notable - 719 Dewkist
 Id: 1BP80B/719



Carpet Cushion:
 Stainmaster Deluxe (.450) 8 lb Pad
 Id: 1Stainmaster/1

Area Subtotal(s)

All Carpeted Areas w/Opt Media Room -A,B,C,D: \$4,137.75
 Gathering Room Credit: (\$478.86)
 Opt Bay Window at Owners Suite: \$158.89
 Study/Opt Flex Room Credit: (\$278.07)

CARPET SUBTOTAL: \$3,539.71

TILE

- Bath 2
- Half Bath
- Laundry

Floor Tile Level 1



Tile Color:
Belclaire 12x12 - BL44 Beige
 Id: 6BEL12/BL44

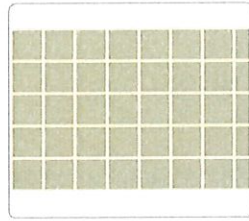

Pattern:
Straight Lay
 Id: 6

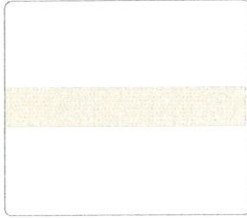

Grout Color:
TEC Power Grout - #909 Sterling
 Id: TTECPG/909

Area Subtotal(s)

Bath 2: **\$0.00**
 Half Bath: **\$0.00**
 Laundry: **\$0.00**

- Owners Bath
- Owners Bath Shower Floor

Floor Tile Level 4



Tile Color:
Cabris 18x18 - Cs20 Buff
 Id: 6CBR18/CS20

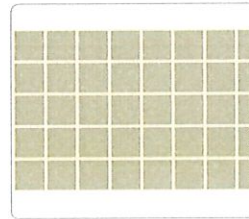

Pattern:
Straight Lay
 Id: 6

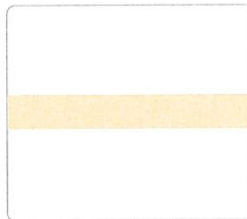

Grout Color:
TEC Power Grout - #988 Pearl
 Id: TTECPG/988

Owners Bath Shower Floor

↳  **CUT DOWN TO 4X4**

Area Subtotal(s)

Owners Bath: **\$252.00**
 Owners Bath Shower Floor: **\$51.69**

TILE SUBTOTAL: \$303.69

WOOD

- Foyer
- Gathering Room
- Hall to Owners
- Kitchen/Dining
- Study

Wood Level 3



Wood Color:
Pioneer Retreat Hickory 5" - Dust Path
 Id: 332586/52

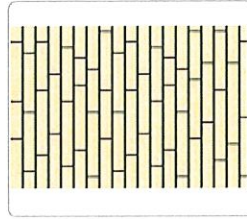

Pattern:
Wood Front to Back
 Id: 719

Area Subtotal(s)

Foyer: **\$1,528.67**
 Gathering Room: **\$3,691.91**
 Hall to Owners: **\$186.67**
 Kitchen/Dining: **\$2,334.34**
 Study: **\$1,238.74**

WOOD SUBTOTAL: \$8,980.33

Flooring Total: \$12,823.73

Hardware

INTERIOR DOOR HARDWARE

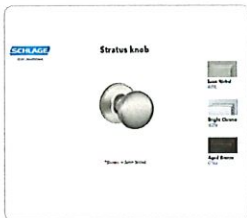

INTERIOR KNOBS-STRATUS
 Vendor: Schlage
 Id: INTERIOR KNOBS-STRATUS
 Price: **\$0.00** (x) 1
 Extended Price: **\$0.00**

INTERIOR DOOR HARDWARE SUBTOTAL: \$0.00

Hardware Total: \$0.00

Lighting

LIGHTING PACKAGES



LIGHT FIX PKG - JOLIE BRUSHED NICKEL *NOT A ZERO PRICE - PLEASE SEE DC FOR PRICING*

Id: LTFX1002

Price: \$0.00 (x) 1

Extended Price: \$0.00

LIGHTING PACKAGES SUBTOTAL: \$0.00

PENDANTS



HATTERAS BAY PENDANT 2665PN EXISTING CIRCUIT SWITCH (Does NOT Include Cost of Wiring) *Switch & Wire MUST be Purchased Separately*

Vendor: Kichler

Id: LTPE0173

Price: \$0.00 (x) 2

Extended Price: \$0.00

↳ Does NOT Include Cost of Wiring - PHOTO ONLY - COST AND LOCATION ON ORA

PENDANTS SUBTOTAL: \$0.00

Lighting Total: \$0.00

Paint

INTERIOR PAINT



PHOTO ONLY

Area: BASE WHOLE HOUSE

Price: \$0.00 (x) 1

Extended Price: \$0.00

SW 7006
Extra White
Interior / Exterior
Location Number: 257-C1

PHOTO ONLY
Area: TRIM
Price: \$0.00 (x) 1
Extended Price: \$0.00

INTERIOR PAINT SUBTOTAL: \$0.00

Paint Total: \$0.00

Plumbing

BATH FIXTURES



Centerset Chateau Chrome 4925
Vendor: Moen
Price: \$0.00 (x) 1
Extended Price: \$0.00
↳ PHOTO ONLY - LOCATION ON ORA



8" Widespread Chateau Chrome 4945
Vendor: Moen
Price: \$0.00 (x) 1
Extended Price: \$0.00
↳ PHOTO ONLY - LOCATION ON ORA

BATH FIXTURES SUBTOTAL: \$0.00

BATH HARDWARE

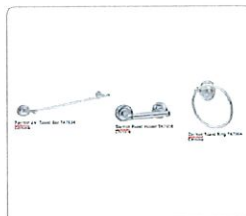

PHOTO ONLY
Area: ALL
Price: \$0.00 (x) 1
Extended Price: \$0.00

BATH HARDWARE SUBTOTAL: \$0.00

KITCHEN FIXTURES



Align Chrome 5923
 Vendor: Moen
 Id: KTFX0122
 Price: \$0.00 (x) 1
 Extended Price: \$0.00

KITCHEN FIXTURES SUBTOTAL: \$0.00

OTHER



PEDASTAL SINK
 Area: HALF BATH
 Price: \$0.00 (x) 1
 Extended Price: \$0.00

OTHER SUBTOTAL: \$0.00

SHOWER FIXTURES



Shower Only Chateau Chrome TL182
 Vendor: Moen
 Price: \$0.00 (x) 1
 Extended Price: \$0.00

SHOWER FIXTURES SUBTOTAL: \$0.00

TUB/SHOWER FIXTURES



Tub/Shower Chateau Chrome TL183
 Vendor: Moen
 Price: \$0.00 (x) 1
 Extended Price: \$0.00

TUB/SHOWER FIXTURES SUBTOTAL: \$0.00

Plumbing Total: \$0.00

Walls

ADDRESS: 9130 ESKESON DRIVE

EFFECTIVE DATE: 2/21/2020

BUYER: spec 9130 E

INITIAL:

INITIAL:

PAGE: 9 of 11

TILE

• Bath 2 Tub Splash

Wall Tile Level 1



Tile Color:
Belclaire 12x12 - BL44 Beige
Id: 6BEL12/BL44

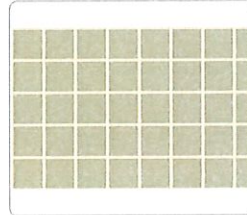

Pattern:
Straight Lay
Id: 54

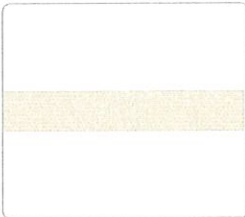

Grout Color:
TEC Power Grout - #909 Sterling
Id: TTECPG/909

Area Subtotal(s)

Bath 2 Tub Splash: \$0.00

• Kitchen Back Splash

Wall Tile Level 20



Tile Color:
Modern Formation Mixed Chevron
Mosaic (12x13 Mesh) - MF03 Canyon
Taupe
Id: 6MFC/MF03

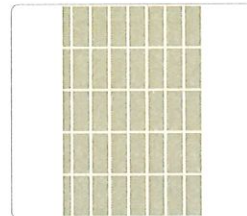

Pattern:
Straight Lay Rectangle Vertical
Id: 739

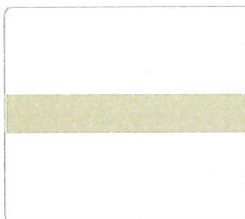

Grout Color:
TEC Power Grout - #940 Antique
White
Id: TTECPG/940

Area Subtotal(s)

Kitchen Back Splash: \$1,628.67

• Owners Bath Shower Stall to Clg w/Opt Shwr 1/Seat

Wall Tile Level 4



Tile Color:
Cabris 18x18 - Cs20 Buff
 Id: 6CBR18/CS20

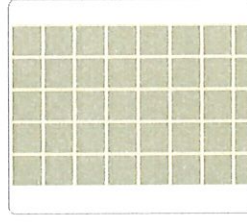

Pattern:
Straight Lay
 Id: 54

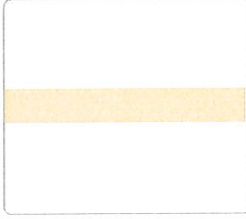

Grout Color:
TEC Power Grout - #988 Pearl
 Id: TTECPG/988

Area Subtotal(s)

Owners Bath Shower Stall to Clg w/Opt Shwr 1/Seat: **\$528.00**

TILE SUBTOTAL: \$2,156.67

Walls Total: \$2,156.67

Window Coverings

BLINDS & SHUTTERS

- Front Elevation C
- Owners Suite w/Opt Bay Window
- Sides & Rear

Cordless Capri

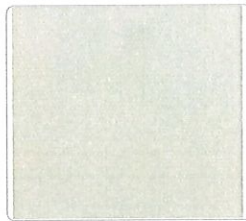

Blind Color:
Cordless 2" Capri - Designer White
 Id: BCordless02/DW

Area Subtotal(s)

Front Elevation C: **\$340.08**

Owners Suite w/Opt Bay Window: **\$296.80**

Sides & Rear: **\$1,456.18**

BLINDS & SHUTTERS SUBTOTAL: \$2,093.06

Window Coverings Total: \$2,093.06

Flooring

TILE

- Bath 2
- Half Bath
- Laundry



Tile Color: Belclaire 12x12 - BL44 Beige
Id: 6BEL12/BL44

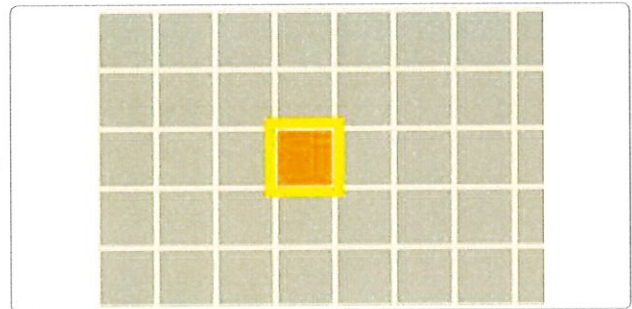

Pattern: Straight Lay

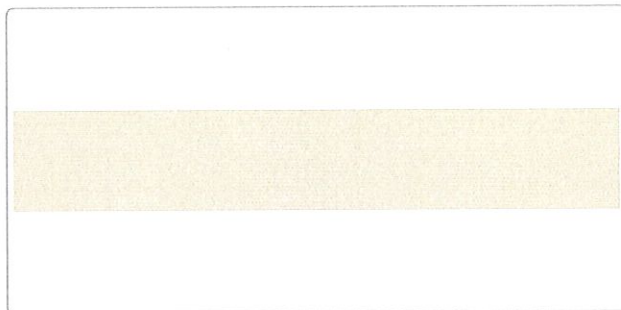

Grout Color: TEC Power Grout - #909 Sterling
Id: TTECPG/909

- Owners Bath
- Owners Bath Shower Floor

↳  CUT DOWN TO 4X4



Tile Color: Cabris 18x18 - Cs20 Buff
Id: 6CBR18/CS20

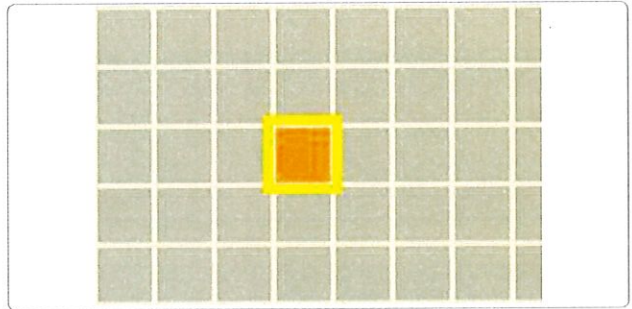

Pattern: Straight Lay

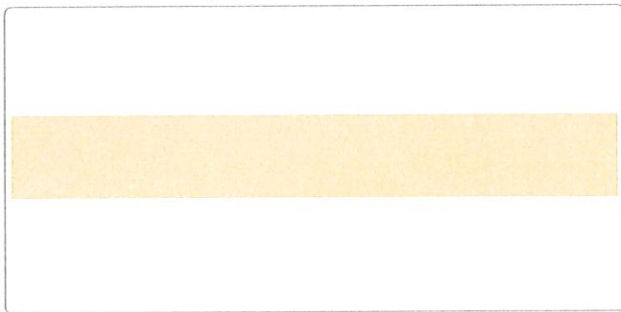

Grout Color: TEC Power Grout - #988 Pearl
Id: TTECPG/988

WOOD

- Foyer
- Gathering Room
- Hall to Owners
- Kitchen/Dining
- Study



Wood Color: Pioneer Retreat Hickory 5" - Dust Path
Id: 332586/52

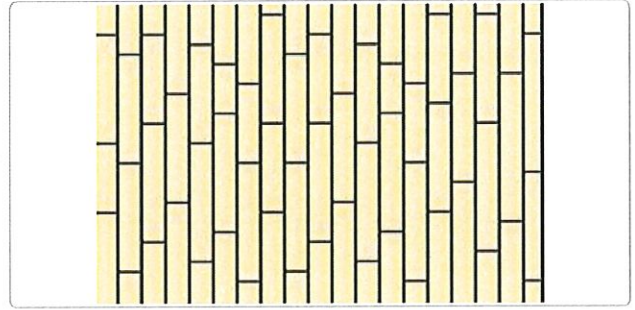

Pattern: Wood Front to Back

• Bath 2 Tub Splash

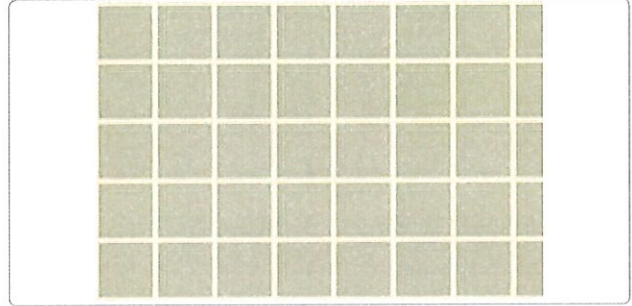

Tile Color: Belclaire 12x12 - BL44 Beige
Id: 6BEL12/BL44

Pattern: Straight Lay

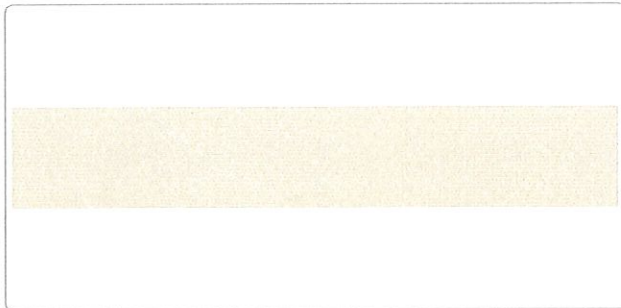

Grout Color: TEC Power Grout - #909 Sterling
Id: TTECPG/909

• Kitchen Back Splash

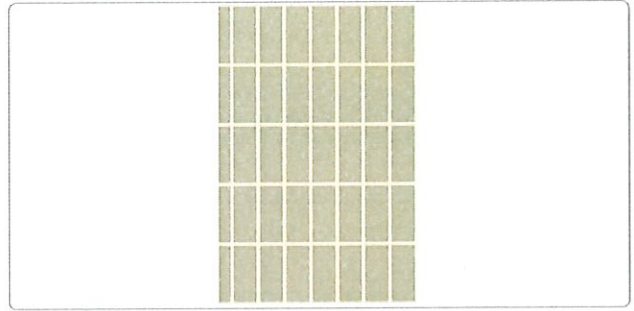

Tile Color: Modern Formation Mixed Chevron Mosaic (12x13 Mesh) - MF03 Canyon Taupe
Id: 6MFC/MF03

Pattern: Straight Lay Rectangle Vertical



Grout Color: TEC Power Grout - #940 Antique White
Id: TTECPG/940

• Owners Bath Shower Stall to Clg w/Opt Shwr 1/Seat

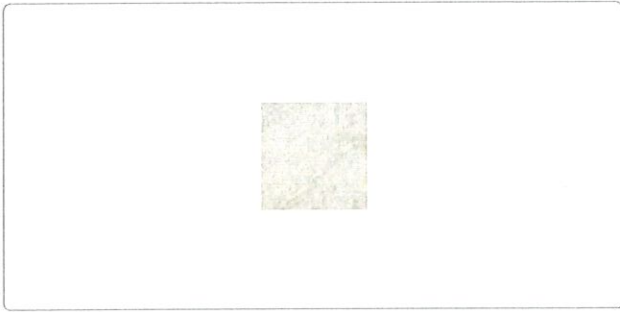

Tile Color: Cabris 18x18 - Cs20 Buff
Id: 6CBR18/CS20

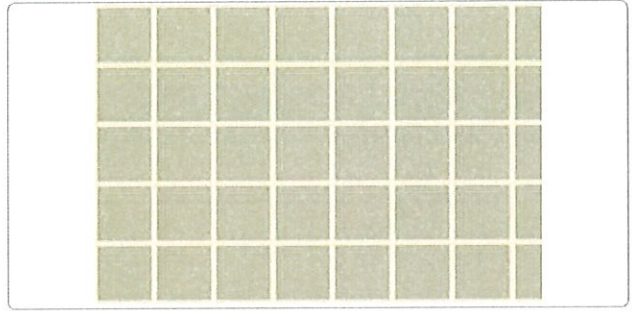

Pattern: Straight Lay

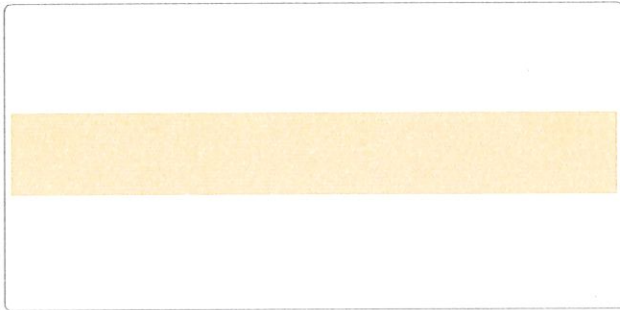

Grout Color: TEC Power Grout - #988 Pearl
Id: TTECPG/988



Buyer Selections Summary

Taylor Morrison - Houston - 4/1/2020 1:00:03 PM

BUYER: spec 9130 E	DESIGNER: Julie Coleman	SALES COUNSELOR: Other/Unknown	CATALOG DATE: 3/31/2020 5:04:52 PM	JOB NUMBER: Q-44659	
ADDRESS: 9130 ESKESON DRIVE	LOT / BLOCK:	COMMUNITY: Bridge Creek 45	SERIES: Aspire	PLAN: Jasmine	ELEV: NA

SELECTIONS SUMMARY	TOTAL: \$21,345.13
---------------------------	---------------------------

Appliances	\$0.00
Cabinets	\$0.00
Countertops	\$4,271.67
Doors	\$0.00
Flooring	
↳ Carpet	\$3,539.71
↳ Tile	\$303.69
↳ Wood	\$8,980.33
Hardware	\$0.00
Lighting	\$0.00
Paint	\$0.00
Plumbing	\$0.00
Walls	\$2,156.67
Window Coverings	\$2,093.06

Printed Name: _____ Signature: _____ Date: _____

Printed Name: _____ Signature: _____ Date: _____

Flooring Redline Report

TAYLOR MORRISON HOU

Plan: Jasmine

Revision: 04/23/18 (02/09/18)

9130 Eskesen Drive
Q-44659

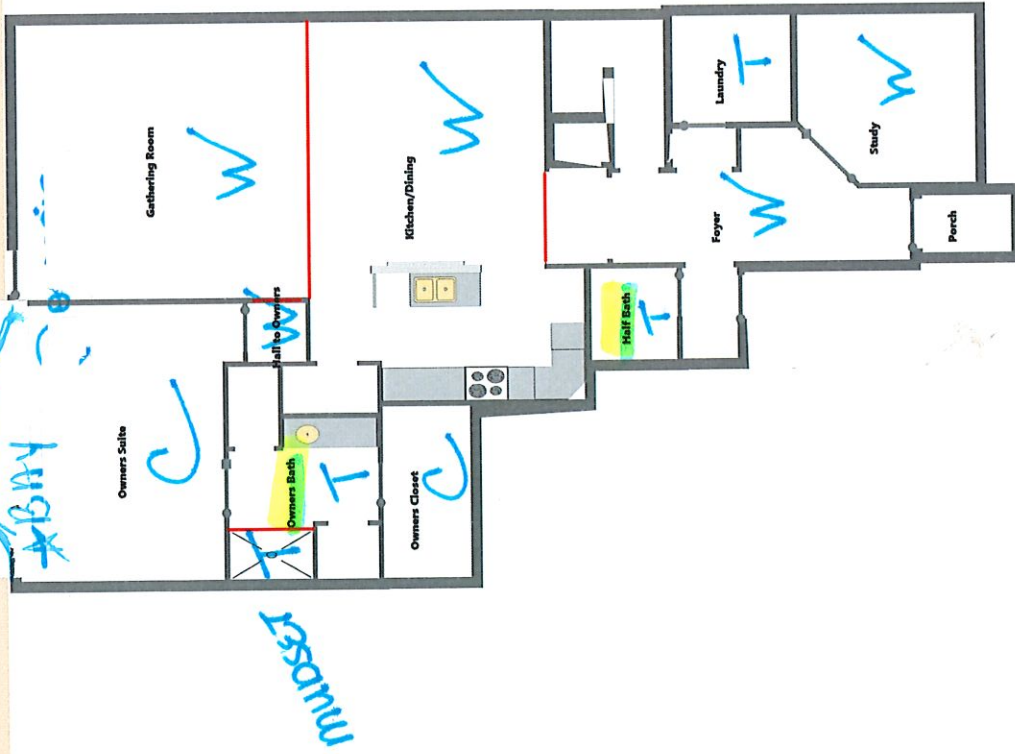

C = CPT
T = TILE
W = WOOD

Accepted By: _____

Date: _____

9130 Eskesen Dr
Q-44659

TAYLOR MORRISON - HOUSTON
SERIES 4 - PLAN JASMINE
D34204005 (2019-01)
STD 42" KITCHEN
- SLIDE IN RANGE

ISLAND
DOOR STYLE: _____
PARTS:
1-DWR3
1-SM8 BLD
1-BTK8 PRT
2-SHM8 BLD
4-KNOBS (FOL)

**IF GLAZE FINISH ADD
(EXCEPT PAINTED MAPLE)
2-BEP34 WD

FILL ALL VOIDS & GAPS

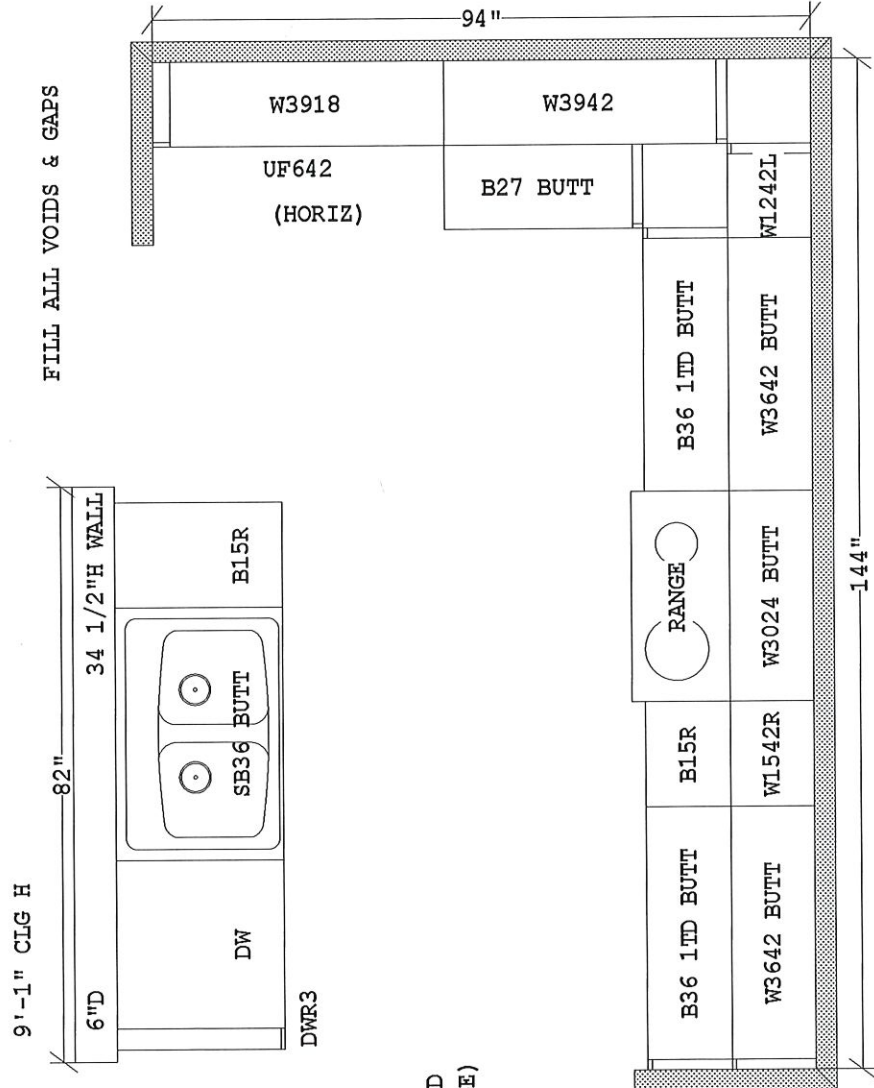

AS / REV
G - R

DOORSTYLE: _____

PARTS:

- 4-UF3
- 3-UF342
- 1-UF642 (HORIZ)
- 3-TCCM8 WD
- 3-HWC 1X2X96
- 3-SM8 BLD (SCRIBE)
- 2-BTK8 PRT
- 2-SHM8 BLD
- 1-FL36 (VOIDS)
- 1-COVER CAP TAN
- 28-KNOBS (FOL)

**IF GLAZE FINISH ADD
(EXCEPT PAINTED MAPLE)
1-BEP34 WD
2-WEP42 WD (SPLIT)

This is an original design and must not be released or copied unless job order placed.

FSR: _____ DATE: _____

Page _____ of _____

TIMBERLAKE
CABINETS

All dimensions size designations given are subject to verification on job site and adjustment to fit job conditions.

Designer: AZ

CABS # _____

Designed: 01/02/19
Printed: 01/02/19

REV 1

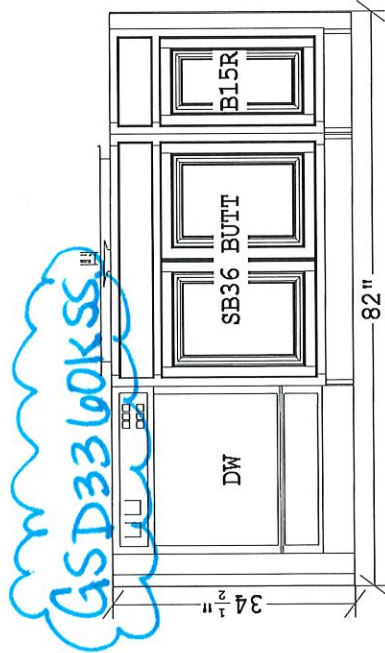
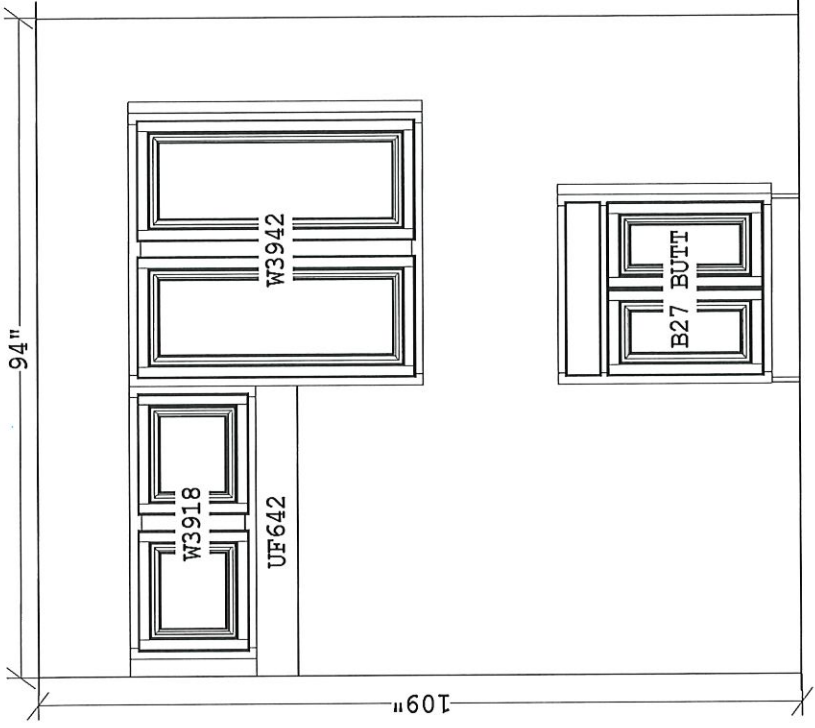
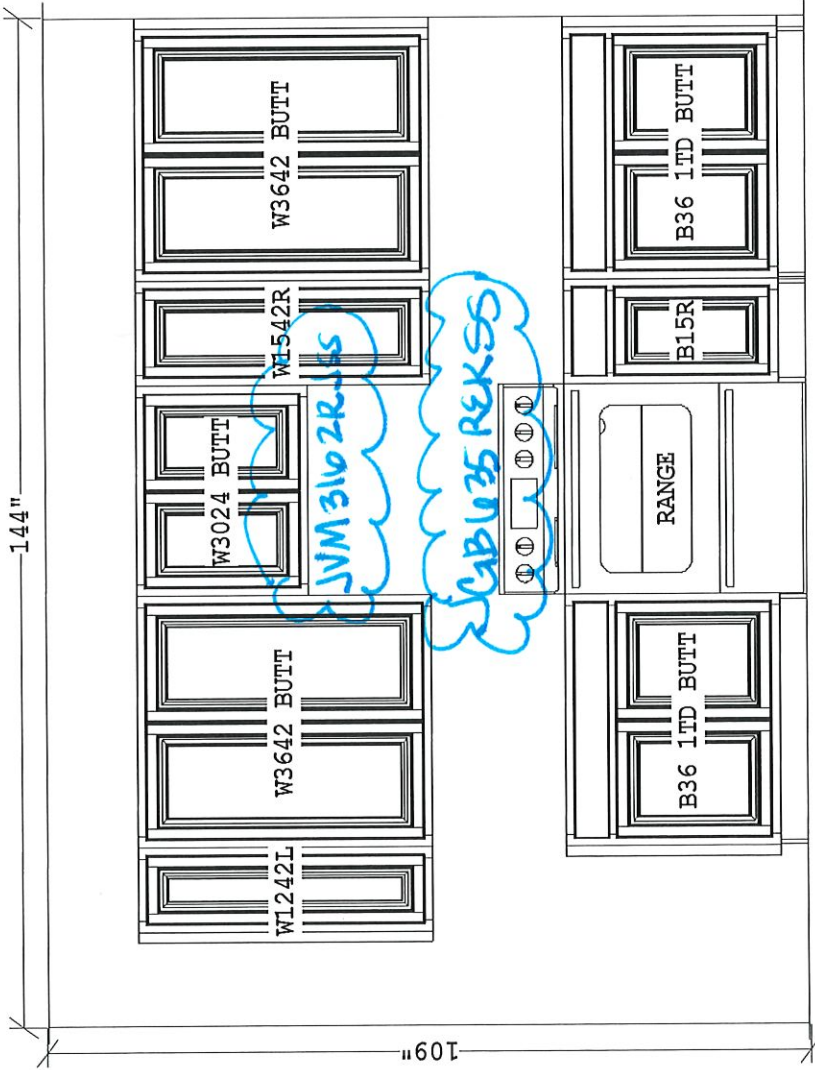

This is an original design and must not be released or copied unless job order placed.

FSR: _____ DATE: _____

Page _____ of _____

All dimensions, size designations given are subject to verification on job site and adjustment to fit job conditions.

Designer: AZ CABS # _____

Designed: 01/02/19
Printed: 01/02/19

TIMBERLAKE
CABINETS

REV 1

TAYLOR MORRISON - HOUSTON
 SERIES 4 - PLAN JASMINE
 D34204005 (2019-01)
OWNER'S BATH

AS / REV
 G - R

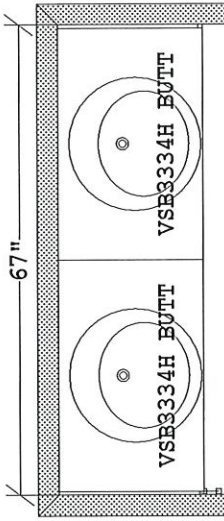
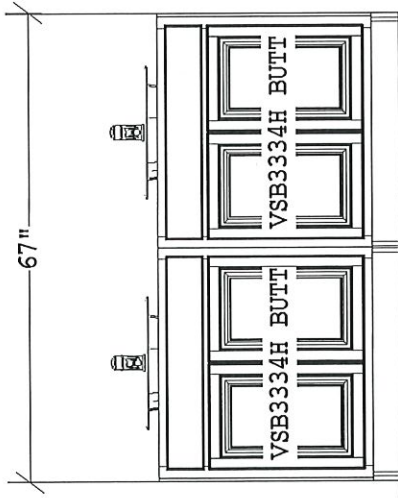

- OWNER'S BATH
- OPT SHOWER W/BENCH
- OPT TUB & SHOWER
- OPT MUD SET SHOWER

DOORSTYLE: _____

PARTS:

- 2-UF3
- 1-SHM8 BLD
- 1-BTK8 PRT
- 1-SM8 BLD
- 4-KNOBS

- OWNER'S BATH
- OWNER'S BATH OPT - SHOWER W/BENCH
- OWNER'S BATH OPT - TUB & SHOWER
- OWNER'S BATH OPT - MUD SET SHOWER

LINEN CLOSET INCL

This is an original design and must not be released or copied unless job order placed.

FSR: _____ DATE: _____

Page _____ of _____

All dimensions size designations given are subject to verification on job site and adjustment to fit job conditions.

Designer: AZ CABS # _____

Designed: 01/02/19
 Printed: 01/02/19

REV 1

TIMBERLAKE
CABINETS

TAYLOR MORRISON - HOUSTON
 SERIES 4 - PLAN JASMINE
 D34204005 (2019-01)
 SECONDARY BATHS

AS / REV
 G - R

-BATH 2
 -BATH 2 OPT - MEDIA RM

DOORSTYLE: _____

- PARTS:
- 1-UF3
 - 1-SHM8 BLD
 - 1-BTK8 PRT
 - 1-SM8 BLD
 - 2-KNOBS
 - ** IF GLAZE
 - (EXCEPT PAINTED MAPLE)
 - 1-BEP34 WD

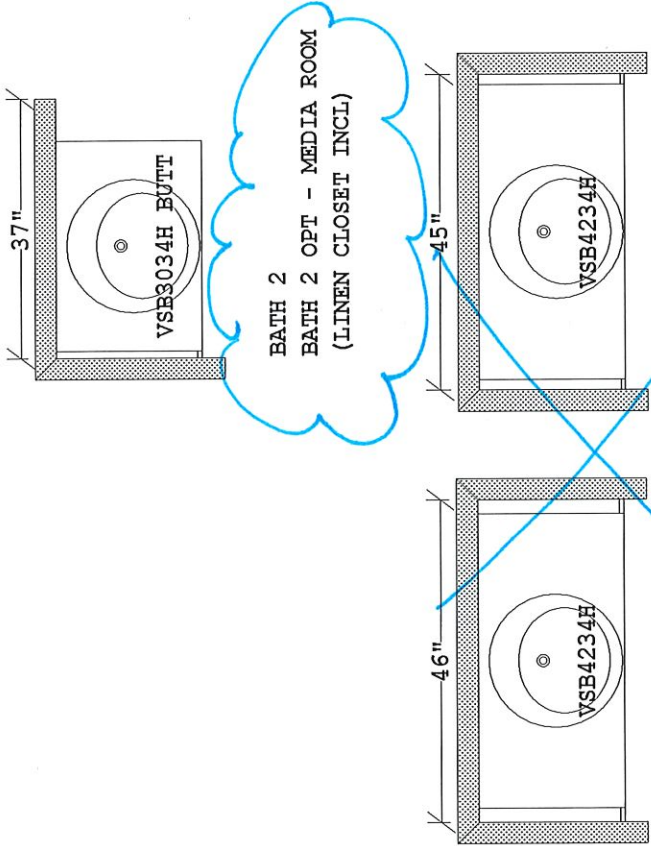

BATH 2 OPT - BDRM 4
 (LINEN CLOSET INCL)

-BATH 3
 -BATH 3 OPT - BDRM W/BATH 3

- DOORSTYLE: _____
- PARTS:
- 1-UF3
 - 1-SHM8 BLD
 - 1-BTK8 PRT
 - 1-SM8 BLD
 - 1-TCCM8 WD
 - 1-HWC 1X2X96
 - 4-KNOBS
 - ** IF GLAZE
 - (EXCEPT PAINTED MAPLE)
 - 1-BEP34 WD
 - 2-WEP30 WD

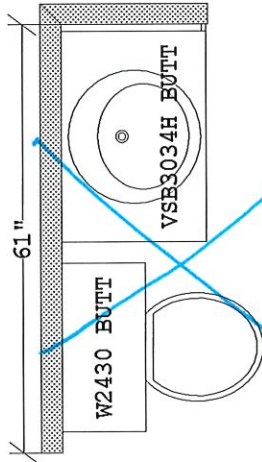

BATH 3
 BATH 3 OPT - BDRM W- BATH 3
 (NO LINEN CLOSET, NEEDS HK)

-BATH 2 OPT BDRM 4

DOORSTYLE: _____

- PARTS:
- 4-UF3
 - 1-SHM8 BLD
 - 1-BTK8 PRT
 - 2-SM8 BLD
 - 4-KNOBS

This is an original design and must not be released or copied unless job order placed.

FSR: _____ DATE: _____

Page _____ of _____

All dimensions size designations given are subject to verification on job site and adjustment to fit job conditions.

Designer: AZ CABS # _____

Designed: 01/02/19
 Printed: 01/02/19

TIMBERLAKE
 CABINETRY

REV 1

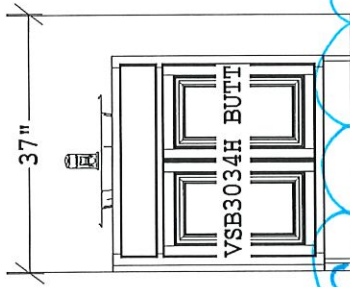

BATH 2
 BATH 2 OPT - MEDIA ROOM
 (LINEN CLOSET INCL)

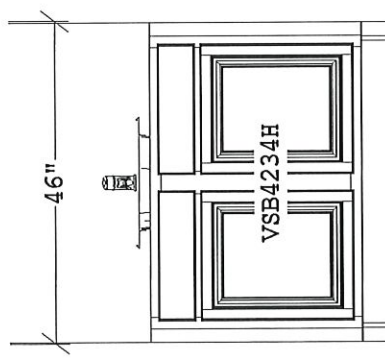

BATH 2 OPT - BDRM 4
 (LINEN CLOSET INCL)

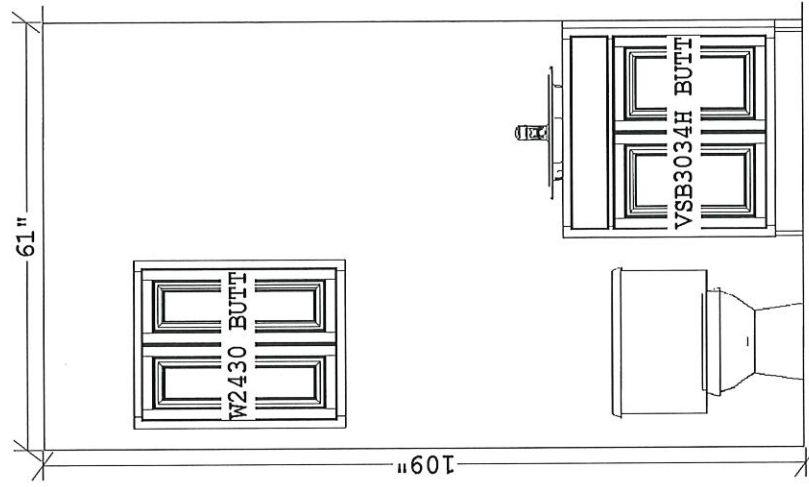
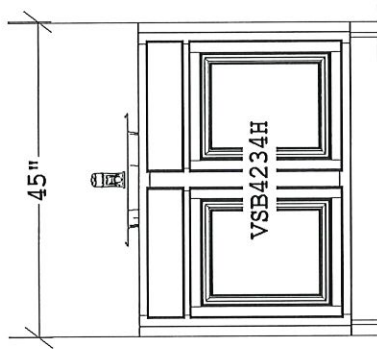

BATH 3
 BATH 3 OPT - BDRM W- BATH 3
 (NO LINEN CLOSET, NEEDS HK)

This is an original design and must not be released or copied unless job order placed.

FSR: _____ DATE: _____
 Page _____ of _____

TIMBERLAKE
 CABINETS

All dimensions .size designations given are subject to verification on job site and adjustment to fit job conditions.

Designer: AZ CABS # _____

Designed: 01/02/19
 Printed: 01/02/19

REV 1

FAX:

PHONE:

ADDRESS: 9130 Eskesen Dr.

BUILDER: TAY-MO



WISENBAKER
FALLON, NEVADA, INC.

Builder Signature: _____

Put an "X" in each hole you DO NOT want.

Mirado 1519

BATH

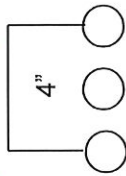

MSTR

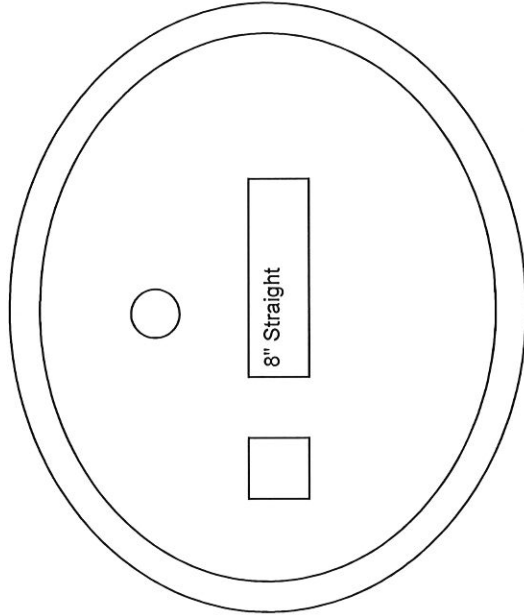
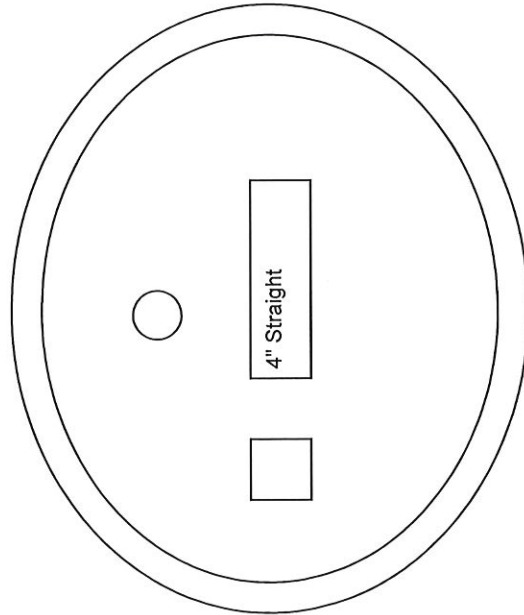
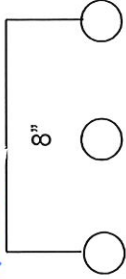

All Faucet Holes are drilled to 4" centers, unless otherwise specified.



FAX: _____
PHONE: _____
ADDRESS: 9130 ESKESON DRIVE
BUILDER: TAYMO

Builder Signature: _____ Put an "X" in each hole you DO NOT want.

Mirado 209

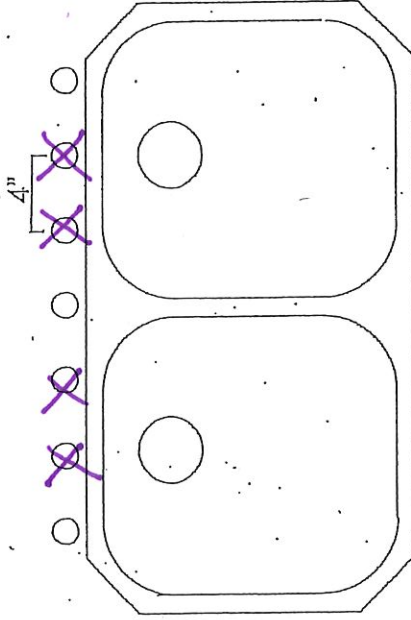

All Faucet Holes are drilled to 4" centers, unless otherwise specified.



Bridge Creek 45

~~GRAND VISTA 45~~

ASPIRE STANDARD SPECIFICATIONS SERIES

DATE: _____

PURCHASER: _____

ADDRESS: _____

Lot: _____ Block: _____ Section: _____

PLAN: _____

ELEVATION:

GRAND VISTA 45

ASPIRE STANDARD SPECIFICATIONS SERIES

FOUNDATION

SOILS TESTING	Soils Test Performed by Engineer
FOUNDATION DESIGN	Engineered Post-Tension Slab Designed per Soils Report
FOUNDATION POLY TAPE	Polyken 757 or Equal

FLATWORK

DRIVEWAY	Picture framed / Broom finish concrete; 4" 3000 psi See Developer/Community Guidelines for Additional Enhancements
DRIVEWAY INTURN	Per Developer/Community Guidelines
PUBLIC SIDEWALK	Per Developer/Community Guidelines
FRONT PORCH (es)	Broom finish concrete
LEADWALK	4 ft. Picture framed / Broom finish concrete; 4" 3000 psi - Per Developer Guidelines
PATIOS	Broom finish concrete; incorporated as part of the Engineered Post-Tension Slab
COURTYARD/BREEZEWAY/LOGGIA	Broom finish concrete (Per Plan)

FRAMING / CORNICE

STUDS	FJ/Stud 16" On-Center - Fir
STUDS - SOLID	24" On-Center Non load bearing walls
SOLE PLATE	2x Treated YP R/L
DOUBLE TOP PLATE	2x YP R/L
FLOOR JOISTS	Engineered I-Joist Floor System or 2x YP (Per Plan)
SUB FLOOR	3/4" OSB- Tongue & Groove- L.P. , Top Notch 350, Glue and Screw Down Sub-Floor
RAFTERS / CEILING JOISTS	24" O.C. #2 YP or FIR per length, #3 if under 6' span ; Engineered Layout and Design Per Plan
ROOF DECK	7/16" YP Plywood
CORNER FRAMING	Corner blocks / "California T's"
LATERAL BRACING	Engineered Per Plan
SHEATHING	Thermoply - Brick/Sliding Elevations OSB Materials - Stucco Elevations
FASCIA	L.P. Smart Side - Textured
SUB FASCIA	Utility SPF 2x4
FRIEZE / WINDOW TRIM	L.P. Smart Side - Textured
SOFFIT	L.P. Smart Side - Textured
SOFFIT VENTS	LP Soffit / LP Perforated Soffit - Per Requirements
SOFFIT JOINTS	Vinyl H-Mould on Porch/Patio/Balcony
COLUMNS / WINDOW HEADERS / GARAGE HEADERS	L.P. Smart Side Trim- Textured (Double on Window Headers for Stucco Elevations)
EXTERIOR ARCHITECTURAL DETAILS	Window Headers, Nogging and Wrapped Beams will be composite material. Decorative Soffit Brackets and Corbels will be synthetic material or cedar per plan details.
SIDING	L.P. Smart Side - Per Plan / developer requirement
WINDSTORM REQUIREMENT	Per Engineered Plans

ROOFING

COMPOSITION ROOF - CERTAIN TEED	Shingles - 30 Year Laminate - Algae Resistant, Per Exterior Color Palette Underlayment - Synthetic Felt Valleys - Double Layer UL30 Drip Edge - 1.5" x 1.5" Galvanized Drip Edge Attic Ventilation - Air Hawks in non-insulated attic areas
TILE ROOF	N/A
BAY WINDOW BONNETS	Composition Shingle or Galvanized Metal (Finish per color scheme) - Per Plan / Elevation

GUTTERS

COVERAGE	On Front Elevation - Color similar to Fascia Trim Per Exterior Selection Palette. Diverter at HVAC unit.
TYPE / SIZE	Aluminum - 5" w/ 3"x4" Downspouts - Composition Roofs

EXTERIOR DOORS

FRONT DOOR - MAIN ENTRY	6' 8"- Solid Wood Door - Stain or Paint Per Color Palette
TEMPORARY CONSTRUCTION DOOR	6' 8"-Construction Door used w/ Wood Front Door
REAR DOOR	6' 8"-Therma-Tru Fiberglass-Smooth, Full Lite Integrated Glass Insert (clear)

WEATHERSTRIPPING / THRESHOLD

FRONT DOOR	Weather-stripped w/ Aluminum Threshold
OTHER EXTERIOR DOORS	Weather-stripped w/ Aluminum Threshold
ATTIC ACCESS DOORS (Not Disappearing Staircase)	Weather-stripped w/ Aluminum Threshold (Per Plan)

WINDOWS

TYPE	Vinyl - Double Pane - Low E
FRAME COLOR	Clay - Inside and Outside Frame - Per Color Palette Sandstone - Inside and Outside Frame - Per Color Palette Colonial White - Inside and Outside Frame - Per Color Palette
WINDOW PATTERN	Per Plan / Elevation
MASTER BATH WINDOW	1 Lite -Obscure

GRAND VISTA 45

ASPIRE STANDARD SPECIFICATIONS SERIES

BRICK / STONE / CAST STONE / STUCCO / SIDING

COVERAGE	Brick Standard on Front Elevation with Wrap on side (Per Plan, Per Developer Guideline) Stucco Elevations - Natural Stone- Standard as drawn on Stucco Elevations
BRICK	Standard per Exterior Color Palettes Painted Brick Per Exterior Color Palette
REAR BRICK	Siding standard unless brick is shown standard on plan or Developer Required per Lot
STONE	Optional Natural Stone (Per Plan and Exterior Color Palette)
STONE MORTAR	Natural Stone is Standard as drawn on Stucco Elevations Only
BRICK MORTAR	White
CAST STONE	3/8" Tooled Joint Gray Per Exterior Color Palette
ADDRESS PLAQUE	Per Plan / Elevation; Khaki
STUCCO (per plan)	Cast Stone on Traditional and International Elevation with Stone at Entry Per Exterior Color Palette Stucco Lathe - Per Exterior Color Palettes

GARAGE DOORS

GARAGE DOOR	Raised Steel Panel (No Straps) Non-Insulated
GARAGE DOOR OPENER	Pre-Wire Only

PLUMBING

Selected at Design Studio	
FAUCETS	MOEN
KITCHEN	Camerist Pull Out Faucet with Spray - Chrome- 7545C
WATER FILTRATION AT MAIN KITCHEN SINK	Dupure- Ultra Filter Single Stage with Classic Spigot in Chrome
MASTER BATH	Chateau 8" Widespread; Chrome; 4945
MASTER BATH SHOWER	Chateau Shower; Chrome; TL182+2520
MASTER BATH TUB	Optional Per Plan
POWDER BATH VANITY	Chateau 8" Widespread; Chrome; 4945
SECONDARY AND HALF BATH VANITY	Chateau 4" Centerset; Chrome; 4925
SECONDARY BATH TUB (per plan)	Chateau Tub/Shower; Chrome; TL183+2363
SINKS	
KITCHEN SINK	50/50 Undermount Stainless Steel - Mirado 209
KITCHEN GARBAGE DISPOSAL	1/3 HP Badger
MASTER VANITY SINK	Under Mount; Mirado 1519
SECONDARY AND HALF BATH SINK	Under Mount; Mirado 1519
POWDER BATH SINK (per plan)	Pedestal Sink Base - Square - Proflow-Marbella MIRKW350
TUBS / SHOWER PAN	
MASTER BATH TUB	Option - Deep Oval- Per Plan
MASTER SHOWER	Acrylic shower pan - sized per plan
SECONDARY BATH TUB / SHOWER	White Vikrell; Sterling-Performa
SECONDARY BATH SHOWER ILO OF TUB (Per Plan)	Acrylic shower pan - sized per plan (optional recessed pan must be selected at Design Studio)
COMMODE	
MASTER BATH	Elongated; White; PROFLO PF5112HEWH
POWDER BATH	Elongated; White; PROFLO PF5112HEWH
SECONDARY AND HALF BATHS	Elongated; White; PROFLO PF5112HEWH
GENERAL	
WATER SUPPLY LINES	Uponor PEX - Multi-Port Connections in attic, No Manibloc
HOSE BIBS	2 hose bibs
WATER HEATER	1 Rinnai Tankless Gas Water Heater 75i Series (Located in garage)
GAS STUBOUTS- INTERIOR	Water Heater
FLASHING PANELS	Furnace
TUBS / SHOWER PAN FLASHING	Cook top / Range
	All exterior penetrations include Quick Flash Panel
	Triton

Pedestal

ROUND-

HVAC

EQUIPMENT	Lennox
SIZING	Designed and engineered per plantp RESNET and current ORC Energy Codes
SEER	14 ACX 15 Seer Performance
FURNACE	EL296UHxE Sealed combustion
DUCTING	R-6 Flex Duct; Supply in all rooms and walk-in closets; No supply to pantry. Supply and Return in Attic
RETURN AIR BALANCE	All Rooms Balanced
THERMOSTAT	Programmable thermostat - Lennox M30
EXHAUST FAN	Broan 80-CFM with back draft damper
DEHUMIDIFIER	Ultra-Aire or Honeywell Unit Per Engineered Specifications
FILTER	F-100 Media - 1 per system
MAKE UP AIR	Per Code Required for hood vents with 400 CFMs or greater
FRESH AIR INTAKE	As required per code and ASHRAE (American Society of Heating, Refrigerating and Aire-Conditioning Engineers) Standards
FLASHING PANELS	All exterior penetrations include Quick Flash Panel

GRAND VISTA 45

ASPIRE STANDARD SPECIFICATIONS SERIES

ELECTRICAL

WIRING
PANEL MAKE
PANEL LOCATION
APPLIANCE WIRING

Per Plan w/ exceptions listed below
Square D- 150 Amp Service Panel
Outside Garage Per Developer Guidelines
Dish Washer (110V)
Cook top or Range top - Gas (110V)
Oven - Electric (220V)
Microwave (110V)
Vent hood (110V) - (Optional)
Washer (110V)
Dryer - Electric (220V)
Rinnai Water Heater - Gas (110V) GFCI
Irrigation- Panel-(110V) GFCI - Per Developer Guideline
Garage Door Opener - Pre-Wire
Security Panel-(110V)
Front door button w/chime per exterior palette
Outlets on kitchen backsplash installed horizontal
All outlets on GFCI, Recessed- covered patios/porches ; "Bubble" cover installed in uncovered areas
All outlets on GFCI

DOORBELL
INTERIOR OUTLETS
EXTERIOR OUTLETS
GARAGE OUTLETS

MISC ELECTRICAL FIXTURES

SWITCHES
SMOKE/CO DETECTORS
FLASHING PANELS

Toggle
Per Code
All exterior penetrations include Quick Flash Panel

LIGHT FIXTURES / CEILING FANS

MANUFACTURER
PACKAGE CHOICES
(Per Program chosen at Design Studio)
WALK IN PANTRY
MASTER WALK-IN CLOSET(S)
OTHER WALK-IN CLOSET(S)
HALLS
GARAGES - In Ceiling
KITCHEN
BEDROOM - Master
BEDROOM - Secondary
MASTER BATH - In Ceiling
SECONDARY BATH - In Ceiling
POWDER ROOM - In Ceiling
UTILITY ROOM
EXTERIOR COACH LIGHT(Location/Qty per plan and Ext
Palette)

Kichler Lighting - Ala Carte Fixtures available at Design Studio
Jolie Brushed Brushed Nickel or Bronze Finish - Package includes Entry, Dining, and Bedroom fixtures per plan.
Additional packages available at Design Studio
LED Disc light (Kichler 43846 WHLED30)
(1) 4' ft LED Per Plan (651082)
LED Disc light (Kichler 43846 WHLED30)
LED Disc light (Kichler 43846 WHLED30)
(1) 4' ft LED Per Plan (651082) Per two car garage
LED Disc light (Kichler 43846 WHLED30)
Flush Mount (Per Light Package) w/Ceiling Fan Pre-wire
Flush Mount (Per Light Package)
LED Disc light (Kichler 43846 WHLED30) Except on Slope Ceilings (Per Plan 3 Bulb Fixture)
LED Disc light (Kichler 43846 WHLED30) QTY PER PLAN
LED Disc light (Kichler 43846 WHLED30)
(1) 4' ft LED Per Plan (651082)
Garage Front Entry - Wall Mounted, Garage Access/Rear
Traditional & Historical Elevations -Courtyard, International Elevations-Allenbury, Modern Elevation- Seaside
Entry-Wall Mounted
Traditional & Historical Elevations -Courtyard, International Elevations-Allenbury, Modern Elevation- Seaside
Small Wall Mount 9611 BK
Optional at Structured Wiring Meeting
Per Exterior Palette

PORCH/PATIO LIGHT
FLOOD LIGHTS
DOORBELL

CEILING FANS
FAN INSTALLED
FAN BLOCK & PREWIRE
COLLECTION
REAR PATIO

1 Location - (Family Room) Includes LED lighting and wall control switch
Master Only
Kichler Stark
Block & Wire Ceiling Fan (Included in Optional Covered Patio)

STRUCTURED WIRING

SECURITY
PHONE/CABLE/DATA (buyer choice to equal total)

Security - Includes Pre-wire for security panel , siren and 3 keypads (front, garage entry, backdoor)
Structured Wire Panel - (1) 30" Wifi Transparent Wiring Enclosure Panel
Structured Wire Panel - 3 Drops (Cat 5 or RG6)
Structured Wire Panel - (1) Service Pull (1 CAT5 x 1 RG6 x 1" Conduit)
All exterior penetrations include Quick Flash Panel

FLASHING PANELS

INSULATION

ATTIC - ROOF DECK
ATTIC - GABLE WALLS
COLD FLOORS
EXTERIOR WALLS
EXT PLATE, PENETRATIONS & WINDOWS
ENERGY PROGRAM

R-20 open cell foam
R-13 open cell foam
R-14 closed cell foam
R-13 open cell foam
Poly-Seal Foam
Individually Tested and RESNET Certified using performance path criteria

DRYWALL

INTERIOR MATERIAL
GARAGE WALL AND CEILING MATERIAL
CORNERS
TEXTURE

1/2" Sheetrock
Attached - 5/8" Firerock
Square
Walls - Medium Splatter / Light Drag; Ceiling - Medium Splatter / Light Drag

GRAND VISTA 45

ASPIRE STANDARD SPECIFICATIONS SERIES

PAINT

INTERIOR & ATTACHED GARAGE

WALLS & CEILINGS
DOORS & TRIM
ACCENT COLOR
OTHER TRIM ELEMENTS PER PLAN OR OPTION

EXTERIOR

TRIM
GARAGE DOOR
FRONT DOOR PER PLAN
ACCESS DOOR / SHUTTERS (excluding front door)
TRIM ELEMENTS PER PLAN OR OPTION

Sherwin Williams - Builder Solution Formula

Two-tone interior color scheme ~ Walls & Ceilings: color #1; Trim: color #2
Finish: Latex / Flat; Color: Std. interior color chart (selected at Design Studio)
Finish: Acrylic / Semi-Gloss enamel ; Color: Std. interior color chart (selected at Design Studio)
N/A
BEAMS & MANTELS - Stain Selected at design studio
STAIR TREAD/HAND RAILS - Stain and Finish (Selected at design studio)
Choice of Exterior color scheme per elevation.
Finish: Exterior Acrylic Satin; Selection: Per exterior color scheme (chosen at sales office)
Finish: Exterior Acrylic Satin; Selection: Per exterior color scheme (chosen at sales office)
Finish: Stain and Finish; Selection: Per exterior color scheme (chosen at sales office)
Finish: Exterior Acrylic; Selection: Per exterior color palette (chosen at sales office)
Finish: Paint; Selection: Per exterior color palette (chosen at sales office) Includes fireplace mantel, corbels, shutters, etc.

INTERIOR DOORS & TRIM

INTERIOR DOORS

STYLE
1st FLOOR HEIGHT
1st FLOOR DENSITY
2nd FLOOR HEIGHT
2nd FLOOR DENSITY
HOUSE-TO-GARAGE -- Attached Garage
STUDY DOORS (per plan)
HINGES (Interior Doors)

Smooth Square Top - Choice of 3 designs selected at Design Studio
6' 8"
Hollow Core
6' 8"
Hollow Core
Solid Core - Height Per Plan
Full Door (One Light) w/T-Astercal
Painted

INTERIOR TRIM

BASE, CASING, & SHOE MOULD
BASEBOARD MATERIAL-Downstairs
BASEBOARD MATERIAL-Upstairs
BASEBOARD-Attached Garage
CASING MATERIAL-Door Applications
SHOE MOULD

CW19 - 3.5" MDF
CW19 - 3.5" MDF
N/A
RS19 - 2.5" MDF
1/4 round shoe mould along baseboards to coordinate with Engineered Wood flooring where installed. Where tile installed shoe mould to coordinate with cabinets.

CROWN MOLDING MATERIAL / LOCATIONS

CROWN MATERIAL
LOCATION:

Optional - Choose style and location at Design Studio CCMP1000 (4 1/4")

NONE

CLOSET MATERIAL (Layout Per Plan)

SHELVING
SHELVING SUPPORTS
SIDE CLEATS
REAR SUPPORT
CLOSET ROD

1x12 Paint Grade
1x12 Paint Grade
1x4 Paint Grade
1x2 Paint Grade
Natural Wood

PANTRY / LINEN CLOSETS / UTILITY

SHELVING
SIDE CLEATS
REAR SUPPORTS

1x12 / 1x16 / 1x18 Paint Grade (Per Plan); Top shelf always 12" Paint Grade
1x2 Paint Grade
1x2 Paint Grade
Shelf and Wood Rod

UTILITY

WINDOW

WINDOW STOOL
MASTER BATH WINDOW STOOL
BOX WINDOW SEAT / PLANT SHELVES

Bullnose - Paint Grade
Paint Grade Wood Trim
3/4 Paint Grade

ATTIC ACCESS STAIRS

DISAPPEARING ATTIC STAIRS -INTERIOR /GARAGE

Marwin Aluminum Attic Stair

STAIR PARTS

APRON & SKIRT

BALUSTERS
PRIMARY STAIR / STARTER STEP
END CAP & RISER
HANDRAIL (and wall rail in interior staircases per plan)

MDF Painted
All half walls with wall mount stained wood handrails Per Plan - Options available at Design Studio
Transitional or Classic Chosen at Design Studio
3092 - 3 1/4" with carpet
MDF Painted
Oak 6010 (2-1/4")
Stained Wood (Selected at Design Studio)
Oak 3 1/4" pyramid top box

NEWELS

GRAND VISTA 45

ASPIRE STANDARD SPECIFICATIONS SERIES

<u>FIREPLACE</u>	<u>Per Plan Only</u>
INTERIOR -SIZE / TYPE	36" Square Gas Burning (Optional Per Plan)
FIREPLACE MANTEL / SURROUND (INTERIOR)	Cast Stone Mantel / Hearth / Surround for Square Fireplace Only (selected at Design Studio)
ELECTRIC FIREPLACE	Optional Interior Electric Fireplace Selected at Design Studio - Location to be specified at Pre-Con Meeting Optional Tile Surround - Selected at Design Studio
<u>CABINETS</u>	<u>Selected at Design Studio</u>
SUPPLIER	Timberlake - Tahoe - Maple
COLORS	Choice of Stain Colors Finalized at Design Studio
LAYOUT	Plans - per Interior Elevation Sheet(s) or Manufacturer's Sheets (Finalized at Design Studio)
KITCHEN/DINING (per plan)	
TYPE / FINISH	Maple - Flat Panel
DOOR STYLE	Square
HEIGHT OF UPPERS	42"
UPPER	Above Microwave
END PANELS	Drywall (per plan)
ISLAND	Kitchen island with drywall finish
REFRIGERATOR CABINET ABOVE WITH SURROUND	Optional
TOP OF CABINETS	Unfinished
DRAWER GUIDES	Epoxy Drawer Guides
STACKED UPPERS	Optional
<u>OPTIONAL KITCHENETTE/GOURMET (per option/per plan)</u>	Maple - Flat Panel
<u>MASTER BATH</u>	
TYPE / FINISH	Maple -Raised 34" with knee space per plan
DOOR STYLE	Square
LINEN	Optional ; Doors -Flat Panel or with Clear Glass Inserts (per plan)
POWDER BATH (per plan)	
TYPE / FINISH (per plan)	Porcelain Pedestal Sink - See Plumbing for model #
SECONDARY / HALF BATHS	
TYPE / FINISH	Maple - Tahoe - Raised 34"
DOOR STYLE	Square
UTILITY	
UPPERS ABOVE LAUNDRY	Shelf and Wood Rod
OTHERS (per plan)	Optional per plan
<u>WET BAR (per plan)</u>	Optional as drawn on plan
PLANNING CENTER /FOYER (per plan)	
TYPE / FINISH	Optional per plan
TYPE / FINISH	Optional per plan
OPTIONAL LOCKERS	Optional per plan
<u>COUNTERTOPS</u>	
KITCHEN	Granite - Level 1 3 CM - Square Edge
OPTIONAL KITCHENETTE /GOURMET (per option/per plan)	Granite - Level 1 3 CM - Square Edge
MASTER BATH	Engineered Stone (Marlana) - Level 1 includes 1/2 wall, shower cap/seat per plan
POWDER BATH (per plan)	Porcelain Pedestal Sink (Per Plan)
SECONDARY AND HALF BATH	Engineered Stone (Marlana) - Level 1
UTILITY (per plan)	Optional Per Plan
PLANNING CENTER (per plan)	Optional as drawn on plan
COMPUTER NICHE / LOFT (per plan)	Optional as drawn on plan
<u>APPLIANCES</u>	<u>Selected at Design Studio</u>
COLOR/FINISH	Stainless Steel
COOKTOP / RANGETOP	GE 30" Free-Standing Gas Range - JGB635REKSS; Stainless Steel
MICROWAVE	GE 1.6 cf Over-the-Range Microwave Oven / JVM3162RJSS; Stainelss Steel
DISHWASHER	GE Dishwasher with Front Controls - GSD3360KSS; Stainless Steel

GRAND VISTA 45

ASPIRE STANDARD SPECIFICATIONS SERIES

SURROUNDS / SHOWER PAN

Selected at Design Studio

BACKSPLASH	Tile - Level 1
KITCHEN	Tile - Level 1
OPTIONAL KITCHENETTE / GOURMET KITCHEN	4" Splash of Countertop Material
UTILITY (per plan - if sink chosen or standard)	
WALL / SHOWER TILE	
MASTER SHOWER SURROUND (WALLS)	Tile - Level 1 (To Ceiling) with Triton Board and Triton waterproofing membrane The top of shower half walls, windows and seats to be capped with bath countertop selection (per plan) Soap / Shampoo Niche Recessed in Wall - location finalized at Pre-Con meeting
MASTER SHOWER PAN	Acrylic Pan
MASTER SHOWER 1/2 WALL CAP	Same as countertop
MASTER SHOWER SEATS (Per Plan)	Same as countertop
MASTER BATH TUB SURROUND (SPLASH)	Optional - Tile - Level 1 (Up to 20" Vertical from Tub Deck)
MASTER BATH TUB DECK	Optional - Tile - Level 1
MASTER TUB SKIRT	Optional - Tile - Level 1 -Per Tub Design- Straight
SECONDARY SHOWER SURROUND (WALLS)	Tile - Level 2 - 84" with Triton Board and Triton waterproofing membrane 1 Soap Dish per shower head -recessed if stand alone shower or corner shelf in tub/shower combination

FLOORING

Selected at Design Studio

ENTRY/ EXTENDED ENTRY (Includes Closet if on Plan)	Tile - Level 1
KITCHEN / BREAKFAST (Includes Pantry)	Tile - Level 1
OPTIONAL KITCHENETTE/GOURMET (per option/per plan)	Tile - Level 1
UTILITY	Tile - Level 1
MASTER BATH (includes water closet)	Tile - Level 1
POWDER BATH (Per Plan)	Tile - Level 1
SECONDARY AND HALF BATHS	Tile - Level 1
DINING ROOM (Per Plan)	Carpet - Level 1 over 3/8" Pad
FAMILY	Carpet - Level 1 over 3/8" Pad
STUDY (per plan)	Carpet - Level 1 over 3/8" Pad
STANDARD CARPET AREAS (Bedrooms and Hall)	Carpet - Level 1 over 3/8" Pad

HARDWARE

Selected at Design Studio

<u>DOOR HARDWARE</u>	<u>SCHLAGE</u>
FINISH	Brushed Nickel
FRONT DOOR	Plymouth Exterior w/ Single Cylinder Deadbolt; Cove Knob Interior
EXTERIOR DOORS	Plymouth Knob - Keylock w/ Single Cylinder Deadbolt
HOUSE TO GARAGE	Plymouth Knob - Keylock
WALK OUT ATTIC ACCESS (per plan)	Plymouth Knob - Keylock
BATHS, BEDROOMS, & STUDY (per plan)	Plymouth Knob - Privacy
<u>ALL OTHER DOORS (per plan)</u>	Plymouth Knob - Passage / Dummy
DOOR STOPS	Heavy Duty Flex Stop
<u>BATH HARDWARE</u>	<u>Taymore - Chrome</u>
MASTER BATH	Towel Bar - 24" (2)
	Towel Ring (Per Vanity)
	Paper Holder (1)
FINISH	Chrome
POWDER BATH	Towel Ring (1)
	Paper Holder (1)
FINISH	Chrome
SECONDARY BATHS	Towel Bar - 24" (1)
	Towel Ring (1)
	Paper Holder (1)
FINISH	Chrome

MIRRORS & SHOWER DOOR

<u>MIRRORS</u>	
MASTER BATHROOM	Polished Straight Edge
POWDER BATHROOM	Rectangle - Straight Edge
SECONDARY BATHS	Polished Straight Edge
<u>SHOWER DOOR</u>	
MASTER SHOWER (per plan)	Clear Glass w/ Chrome Trim
HEIGHT	80"

LANDSCAPING / FENCE

SOD COVERAGE	Front & Sides (**areas not enclosed by fence**) Backyard- Per Developer Requirements (reference full developer guidelines for lot specific requirements)
LANDSCAPING PACKAGE	Per Developer Requirements (reference full developer guidelines for lot specific requirements)
TREES	Per Developer Requirements (reference full developer guidelines for lot specific requirements)
IRRIGATION	Front & Sides (**areas not enclosed by fence**)
FENCE	Per Developer Requirements (reference full developer guidelines for lot specific requirements)

EXTERIOR SPECIALTIES

MAILBOXES	Cluster Boxes per Local Post Office Requirements
-----------	--

Interior Paint
No choice needed

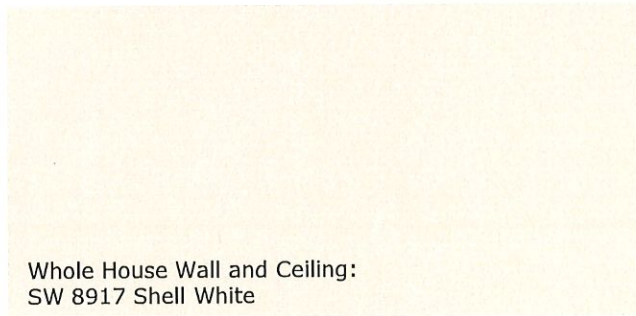

Whole House Wall and Ceiling:
SW 917 Shell White

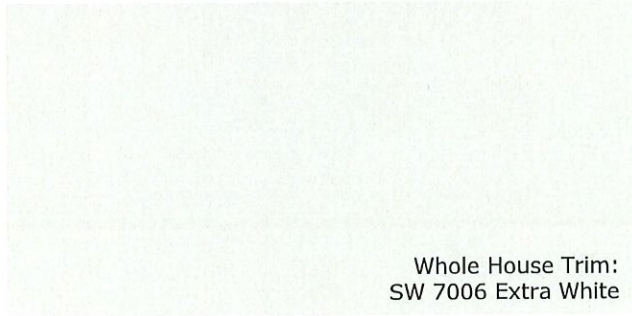

Whole House Trim:
SW 7006 Extra White

Main Floor
No choice needed



Wood
Pioneer Retreat Hickory 5" – Dust Path
Locations: Entry, Family, Dining, Kitchen,
Breakfast, Powder, all adjacent halls.

Carpet
No choice needed

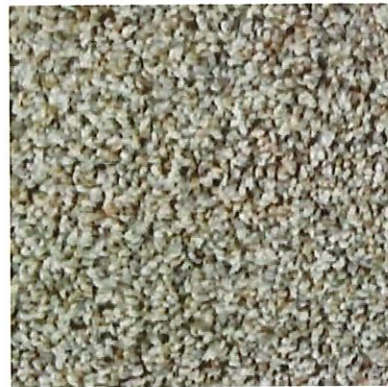

Carpet
Notable – 719 Dewkist

Whole House Blinds
No choice needed



Cordless 2" Capri
Designer White
Note: Does not include
2nd story attic, garage
Family volume
windows or front door.

Kitchen Cabinet
No choice needed

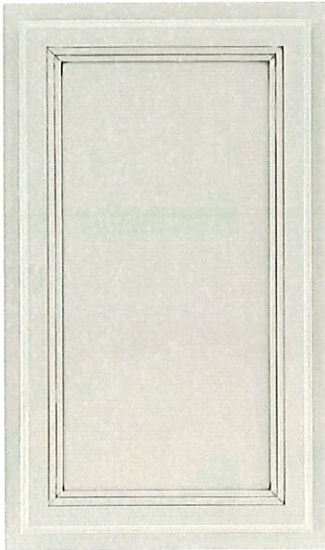

Timberlake
Tahoe Painted Ember Glaze
Note: Add pull-out trash drawer GWST0001C.

Kitchen Countertop
No choice needed



Omegastone
Zebrino
Edge: Square edge

Kitchen Backsplash
Choose option 1, 2 or 3



Option 1
Tile
Modern Formation Mixed Chevron
Mosaic (12x13 Mesh) –
MF03 Canyon Taupe
Grout: #940 Antique White
Pattern: Full Mosaic Vertical
(as shown above)

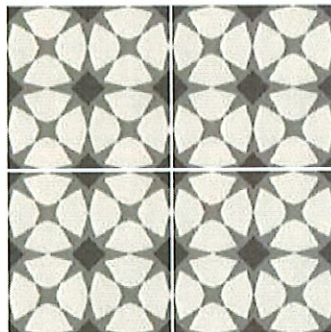

Option 2
Tile
D'Segni Deco 8x8 – MOUS
Chalk/Mud/Midnight/Sand Blend
Grout: #909 Sterling
Pattern: Straight Lay
(as shown above)



Option 3
Tile
Logique Fletching Mosaic
(11x12 Mesh) – 09 Taupe
Grout: #909 Sterling
Pattern: Full Mosaic Vertical
(as shown above)

Master Bath Cabinet
No choice needed

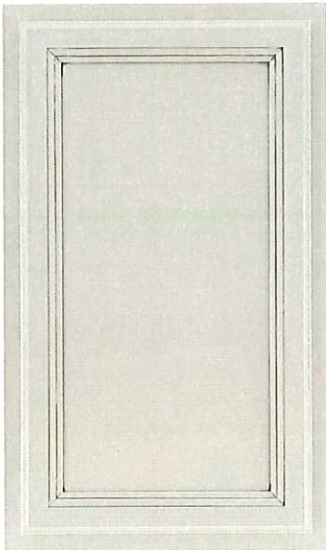

Timberlake
Tahoe Painted Ember Glaze

Master Bath Countertop
No choice needed

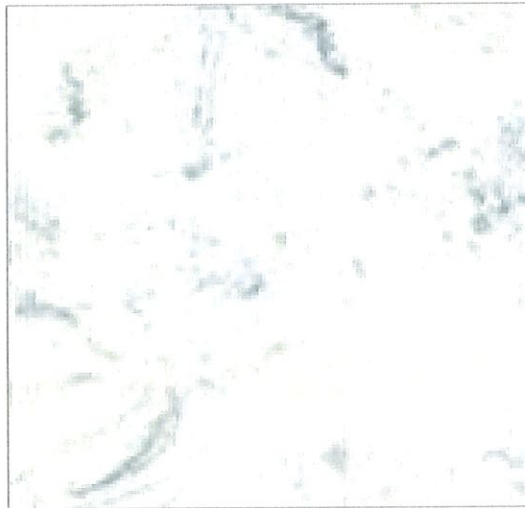

Marlana
Symphony
Edge: Square Edge

Master Bath Tile
No choice needed

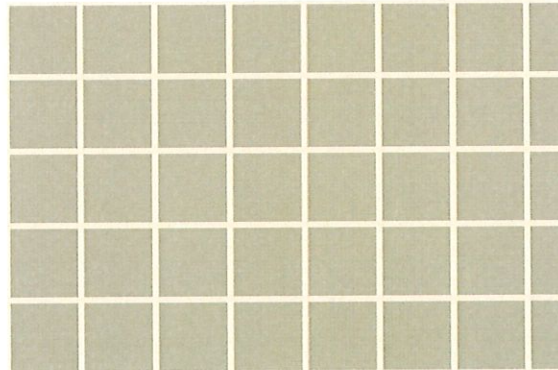

Tile
Cabris 18x18 – CS20 Buff
Grout: #988 Pearl
Pattern: Straight Lay
Note: Use same tile at fireplace.

Secondary Baths Cabinet
No choice needed

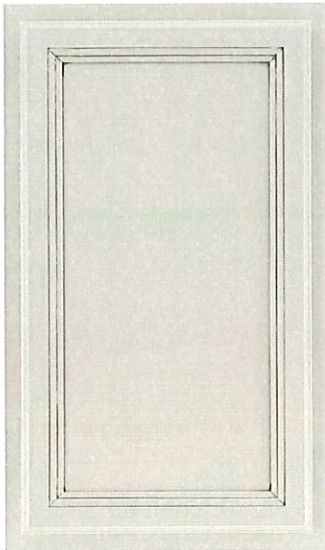

Timberlake
Tahoe Painted Ember Glaze

Secondary Baths Countertop
No choice needed

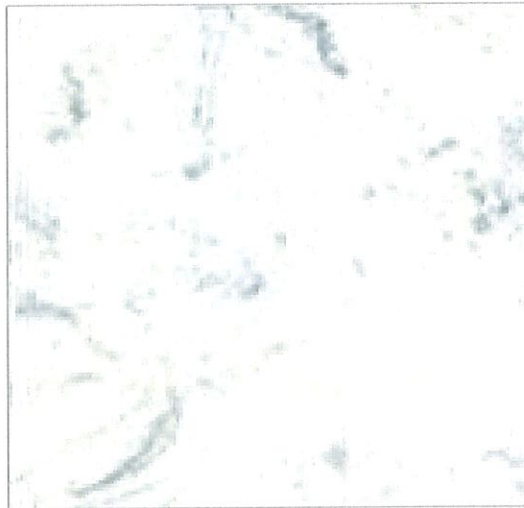

Marlana
Symphony
Edge: Square edge

Secondary Baths Tile
No choice needed

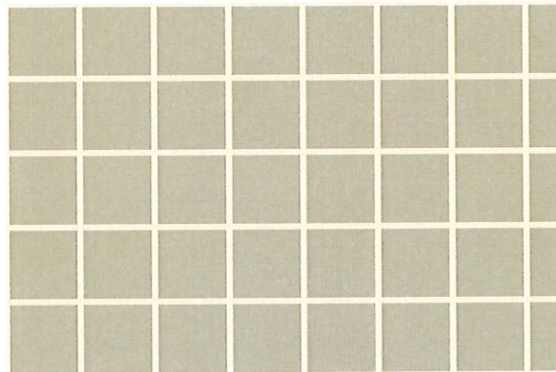

Tile
Belclaire 12x12 – BL44 Beige
Grout: #909 Sterling
Pattern: Straight Lay
Note: Use same tile at Utility.

Kitchen Appliance Package
No choice needed

Standard
GEAP – 0201 –
0208
Slide-In Stainless
Steel
4 Burner Range



Model#: JGB635REKSS
GE® 30" Free-Standing Gas
Range

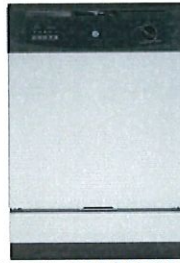

Model#: GSD3360KSS
GE® Built-In Dishwasher



Model#: JVM3162RJSS
GE® 1.6 Cu. Ft. Over-the-Range
Microwave Oven

A La Carte Upgrades
Choose desired options



GE Energy Star 4.4 Cu. Ft.
Stainless Steel Capacity Washer
White
GE | GTW490ACJWS



GE Energy Star 25.3
Cu. Ft.
Side by Side
Refrigerator
Stainless Steel
GE | GSE25GSHSS

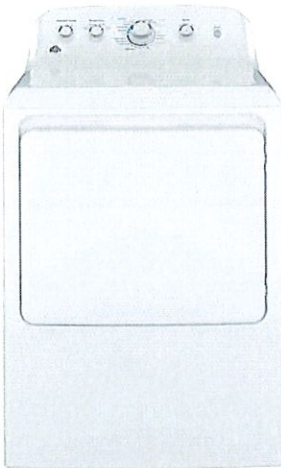

GE 7.2 Cu. Ft.
Capacity
Aluminized Alloy
Drum
Electric Dryer
White
GE |
GTD42EASJWW

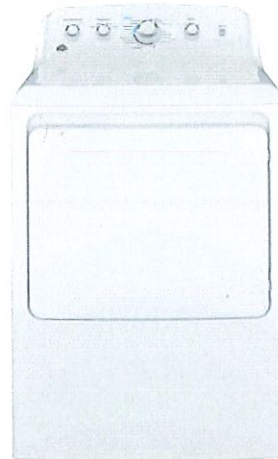

GE 7.2 Cu. Ft.
Capacity
Aluminized Alloy
Drum
Gas Dryer
White
GE |
GTD42GASJWW

Kitchen Sink and Faucet
No choice needed

Mirado® 209
 #18 gauge T-304 stainless steel, welded construction

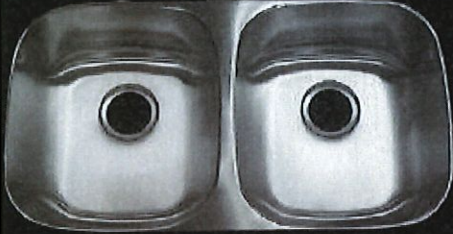

Outside Length: 32 1/4"
 Inside Length: 14 1/2"
 (for each bowl)

Outside Width: 18 1/2"
 Inside Width: 16 1/2"

Bowl Depth: 9"
 (for each bowl)

Mirado 209 Sink – Stainless Steel



Align Spring Faucet
 5923 – Chrome

Baths Sinks and Plumbing
No choice needed

Mirado® A2115
 (Available in White & Biscuit)



Outside Length: 21"
 Inside Length: 18 1/2"

Outside Width: 15"
 Inside Width: 12 1/4"
 Bowl Depth: 6 1/2"

Master and Secondary Baths
 Mirado A2115 Sink – White



Powder Pedestal Sink
 Mirabelle MIRKW350WH/MIRK



Chateau 4" Low Arc
 Bathroom Faucet
 Chrome

Bath Hardware
No choice needed



Taymor 24" Towel Bar TA7924
 Chrome



Taymor Paper Holder TA7908
 Chrome



Taymor Towel Ring TA7904
 Chrome

Interior Door
No choice needed

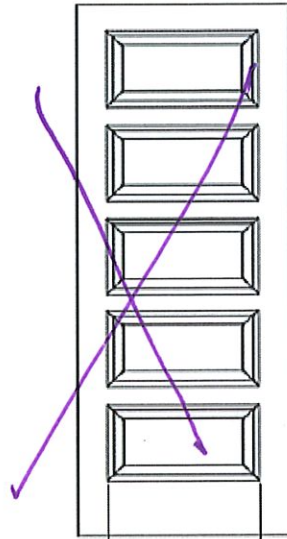

Discontinued

Rockport Door
Paint Color: SW 7006 Extra White

Door Hardware
No choice needed



Barcelona Front Door Handleset
Satin Nickel



Stratus Interior Door Knob
Satin Nickel

Pendant Light Options
 Choose Option 1, 2, 3, 4 or 5 if desired. All pendants include the wiring and switch.

- | | | | | |
|---|---|---|--|---|
|  |  |  |  |  |
| <input type="checkbox"/> Option 1
Circolo
42878OZ
Olde Bronze
(3 at island) | <input type="checkbox"/> Option 2
Crosby
43996NI
Brushed Nickel
(3 at island) | <input type="checkbox"/> Option 3
Missoula
78200
Bronze
(2 at island) | <input type="checkbox"/> Option 4
Everly
42046CH
Chrome
(2 at island) | <input checked="" type="checkbox"/> Option 5
Hatteras Bay 8"
2665PN
Polished Nickel
(2 at island) |

Required Interior Ceiling Fan
 No choice needed



330016NI 52" Basics Pro Premier Fan
 Locations: Family + 1 additional location

Optional Interior Ceiling Fan
 Choose if desired. Notate locations.



402NI7 52" Basics Premier Fan
 Location(s): Master Bedroom

Optional Exterior Ceiling Fan
 Choose if desired



339516TZP 52" Renew Patio Fan

Optional Technology Packages
Choose Option 1, 2 or 3 if desired

- Option 1
Livin' Up at Home
Wire for Home Entertainment Package
- 5.1 Surround Sound Speaker Package Bronze
 - 5.1 Speaker Prewire
 - 1 Room Audio w/VC Bronze

- Option 2
Safe and Secure
Security and Automation Ready Package
- Qolsys IO2+ Panel
 - Qolsys Take Over Module
 - Single Cat5 Camera Prewires
 - Skybell Slim Vidow Doorbell

- Option 3
Well Connected
WIFI and Video Monitoring Ready Package
- 20" Panel to 30" Panel
 - Upgrades to base Pkg Cat6 (3) + Demarc
 - Cat6 Camera Prewires
 - Upgrade Cameras to Cat6
 - Skybell Slim Video Doorbell
 - TV Mount Prep/Conduit
 - Interior Duplex 110V (TM electrical item)

A La Carte Technolgy Options
Choose Option 1, 2, 3 or 4 if desired

- Option 1
TV Mount Pre/Conduit Run up to 10'
- Option 2
Combo (1) Cat5, (1) RG6 Connection
- Option 3
Single Cat6 Camera Prewires
- Option 4
1 Room Audio Prewire