

# Building Sketch

Borrower	Kenross Properties LLC			
Property Address	2527 Rosefield			
City	Houston	County	Harris	State TX Zip Code 77080
Lender/Client	[REDACTED]			

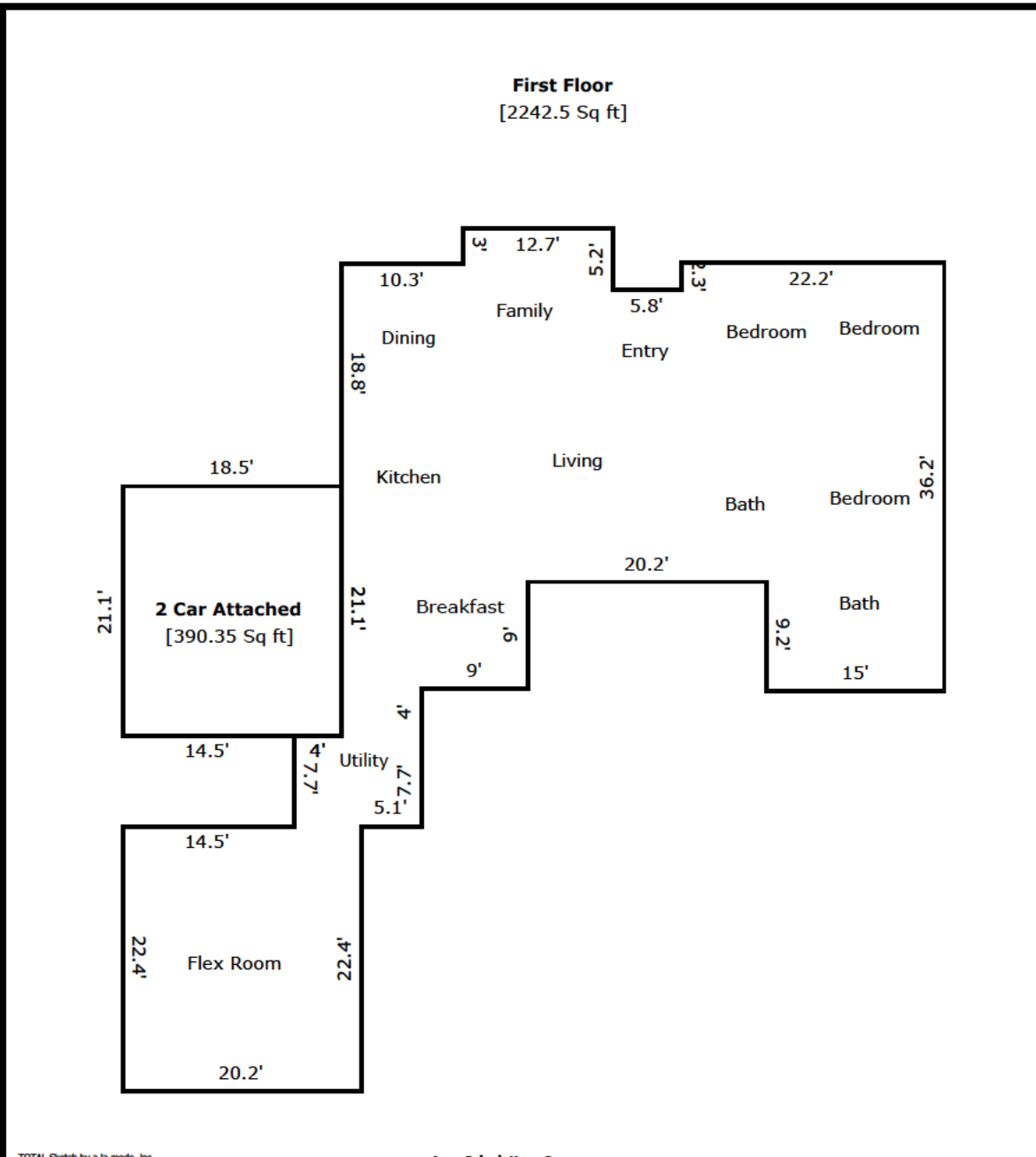

Living Area		Area Calculations Summary	Calculation Details
First Floor	2242.5 Sq ft		20.2 × 22.4 = 452.48 10.8 × 7.7 = 83.16 6.8 × 4 = 27.2 15 × 9.2 = 138 27 × 22.2 = 599.4 15.8 × 9 = 142.2 28.8 × 24.7 = 711.36 5.2 × 12.7 = 66.04 10.3 × 2.2 = 22.66
<b>Total Living Area (Rounded):</b>		<b>2243 Sq ft</b>	
<b>Non-living Area</b>			
2 Car Attached	390.35 Sq ft		18.5 × 21.1 = 390.35