

SCALE: 1" = 40'

ADDRESS: 11314 CLAYMORE ROAD
HOUSTON, TEXAS 77024
BORROWER:

LOT 4, BLOCK 1 CLAYMORE ESTATES

AN ADDITION IN HARRIS COUNTY, TEXAS
ACCORDING TO THE MAP OR PLAT THEREOF RECORDED
IN VOLUME 151, PAGE 132 OF THE MAP RECORDS
OF HARRIS COUNTY, TEXAS

NOTE: THIS SURVEY WAS PREPARED WITHOUT A TITLE COMMITMENT.
OTHER EASEMENTS AND/OR BUILDING LINES MAY AFFECT THIS TRACT.



THIS PROPERTY DOES NOT LIE WITHIN THE
100 YEAR FLOOD PLAIN AS PER FIRM
PANEL NO. 48201C 0645 L
MAP REVISION: 06/18/2007
ZONE X
BASED ONLY ON VISUAL EXAMINATION OF MAPS.
INACCURACIES OF FEMA MAPS PREVENT EXACT
DETERMINATION WITHOUT DETAILED FIELD STUDY.

A SUBSURFACE INVESTIGATION
WAS BEYOND THE SCOPE OF THIS SURVEY

D.C.L. = DIRECTIONAL CONTROL LINE
RECORD BEARING: VOL. 151, PG. 132, H.C.M.R. DRAWN BY: RE

I HEREBY CERTIFY THAT THIS SURVEY WAS MADE
ON THE GROUND, THAT THIS PLAT CORRECTLY
REPRESENTS THE FACTS FOUND AT THE
TIME OF SURVEY AND THAT THERE ARE NO
ENCROACHMENTS APPARENT ON THE GROUND,
EXCEPT AS SHOWN HEREON. THIS SURVEY IS
CERTIFIED FOR THIS TRANSACTION ONLY.

JAMES P. WALKOVIK
PROFESSIONAL LAND SURVEYOR
NO. 5971
JOB NO. 17-05089
MAY 15, 2017

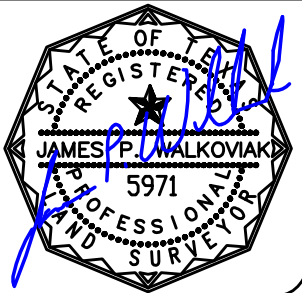

TITLE HOUSTON
KELLI BEDNARZ
713-589-9800



PRECISION
surveyors

1-800-LANDSURVEY
www.precisionurveyors.com
281-496-1586 FAX 281-496-1867 210-829-4941 FAX 210-829-1555
950 THREADNEEDLE STREET SUITE 150 HOUSTON, TEXAS 77079 1777 NE LOOP 410 SUITE 600 SAN ANTONIO, TEXAS 78217
FIRM NO. 10063700