

PICKLING LANE  
(50' R.O.W.)

*SD*

NOTES:

1. SUBJECT TO APPLICABLE RESTRICTIVE COVENANTS LISTED IN ITEM NO. 1, SCHEDULE "B" OF TITLE COMMITMENT ISSUED BY TITLE RESOURCES GUARANTY COMPANY UNDER G.F. NO. 1456-09-2706.
2. ALL BEARINGS SHOWN HEREON ARE BASED ON THE RECORDED PLAT.
3. BLANKET ESMT. FOR CENTERPOINT PER C.F. NO. X596032.
4. BUILDING LINES (5' SIDES) PER C.F. NO. V413993.
5. AGREEMENT FOR UNDERGROUND ELECTRICAL SERVICE PER C.F. NO. 20080188331.
6. SHORT FORM BLANKET ESMT. FOR CERTAIN UTILITIES PER C.F. NO. 20080266711.
7. BLANKET ESMT. WITH CENTERPOINT PER C.F. NO. X596032.

FLOOD MAP:

THIS PROPERTY LIES IN ZONE "X" AS DEPICTED ON COMMUNITY PANEL No. 48201 C 0755L 0765L, DATED: 06-18-07

"THIS INFORMATION IS BASED ON GRAPHIC PLOTTING. WE DO NOT ASSUME RESPONSIBILITY FOR EXACT DETERMINATION"

PLAT OF SURVEY  
SCALE: 1" = 20'

© 2009, ALLPOINTS SERVICES, CORP., All Rights Reserved. This original work is protected under copyright laws, Title 17 U.S. Code Sections 101 & 102. All violators will be prosecuted to the extent of the law. This survey is being provided solely for the use of the recipients and no license has been created, express or implied, to copy the survey except as is necessary in conjunction with the original transaction.

FOR: SUSAN DAGLEY  
ADDRESS: 8014 PICKLING LANE  
ALLPOINTS JOB #: LL21934 JP  
G.F.: (1456-09-2706)

LOT 36, BLOCK 3,  
SPRINGFIELD ESTATES SUBDIVISION, SEC. 8,  
FILM CODE No. 625038, MAP RECORDS,  
HARRIS COUNTY, TEXAS.

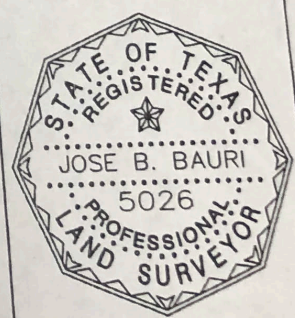

I HEREBY CERTIFY THAT THIS PLAT REPRESENTS THE RESULTS OF A SURVEY MADE ON THE GROUND, ON THE 3RD DAY OF DECEMBER, 2009.

*Jose B. Bauri*



**ALLPOINTS SERVICES CORP**  
PHONE: 713-468-7707  
FAX: 713-827-1861

ALLPOINTS SERVICES CORP. · COMMERCIAL/BUILDER DIVISION · 1515 WITTE ROAD · HOUSTON, TEXAS 77080