

FRONT & SIDE BUILDING LINES PER RESTRICTIONS: V.300 P.536

BASIS OF BEARINGS:
 THE WEST BOUNDARY LINE OF LOT 8 OF BLOCK 3
 SUBDIVISION PLAT CALL - N 11°43'35" E 120.03'
 FOUND 1/2" PIPE (SWC) & SPIKE IN TREE (NWC) 120.03' APART.

**MORTGAGE LOAN SURVEY
 FOR
 LINDA D. DENSON**

THE STATE OF TEXAS §
 COUNTY OF ANGELINA §

"TO WHOM IT MAY CONCERN"

I, R.F. (Rick) Freeman, Registered Professional Land Surveyor, do hereby certify that the attached plat is a true and correct plat showing Lot No. 7 of Block No. 3 of BRIAR MEADOW ADDITION, a subdivision in the City of Lufkin, Texas, as recorded in Cabinet A on Slide 98-B of the Map and Plat Records of Angelina County, Texas.

The undersigned does hereby certify that this survey was this day made on the ground of the property legally described hereon and is correct, and there are no visible discrepancies, conflicts, shortages in area, boundary line conflicts, encroachments, overlapping of improvements, easements, or rights-of-way, except as shown hereon.

EVERETT GRIFFITH, JR. & ASSOCIATES, INC.
 Engineering and Surveying

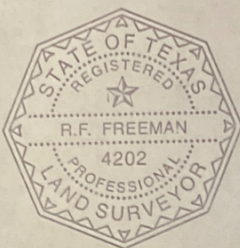

R.F.F.
 R.F. (Rick) Freeman (Signature in blue ink)
 Registered Professional Land Surveyor No. 4202
 Texas Surveying Firm No. 10029100
 408 North Third Street
 Lufkin, Texas 75901
 (936) 634-5528
 July 20, 2020