

SUBJECT TO :

- © 2018 Everything In Christ Services, Inc., All Rights Reserved.
- Survey is valid only if print has original Seal and signature of surveyor on it. Declaration is made to original purchaser of this survey. It is not transferable to additional institutions or subsequent owners.
- See Corresponding Field Notes .
- Fences as shown .
- Unlocated Pipeline granted to Humble Pipeline Company recorded in Volume 428 , Page 415 H.C.D.R. (No visible evidence crossing Subject Property) .

This Property Lies in Zone "X"
 Outside the 100 Year Flood Plain
 Per Graphic Scaling according to
 Community Panel No.4802870405M
 having an effective date 10-16-2013
 Job No. 18 - 101 - 02
 Scale 1" = 40'
 Date 03 - 05 - 2018
 Drawn By: AH
 Revised : 03-08-2018 to change
 the Title Company

Purchaser MICHAEL SHANE MCLAUGHLIN
 Address 18409 CYPRESS CHURCH ROAD
 Lot _____, Block _____, Section _____
 Survey HENRY RADZ, A 675
 Area 3.559 AC. TRACT
 Subdivision _____
 Volume _____, Page _____, Records _____
HARRIS County, Texas

I, Craig A. Laney, a Registered Professional Land Surveyor in the State of Texas, RPLS No. 4507, do hereby certify to FRONTIER TITLE COMPANY and Purchaser(s) that based upon information provided by said Title Company under G.F. No. 1837362 that this survey was this day made under my supervision on the ground of the above described property and the above plat or drawing reflects the findings on the ground of this property at this time. I have shown or noted all easements reflected in said Title Company's report. This Survey conforms to the minimum standards of practice as approved by the Texas Board of Professional Land Surveying. Effective February 2014, last revised 02-2014.

The basis of bearing is S89°27'16"E ALONG THE NORTH LINE OF SUBJECT TRACT PER PRIOR DEED
 A Division of Everything in Christ Services, Inc.

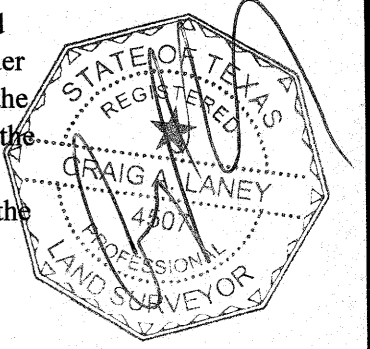

Seal