

NOTES:
 NO RECORDS SEARCH CONTRACTED. RECORD EASEMENTS, RESTRICTIONS, ROADWAYS, RIGHTS-OF-WAY, BUILDING LINES, ENCUMBRANCES, ETC. BY COMMON KNOWLEDGE ONLY.
 CLIENT HOLDS TLTS, INC. HARMLESS FROM RESPONSIBILITY FOR SAME

- Restrictions as per recorded plat unless otherwise noted
- True ground distances shown
- Bearings assumed as platted
- Survey monuments reconciled w/numerous previous surveys

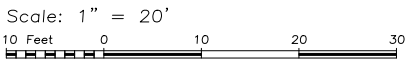

LAND TITLE SURVEY OF A TRACT OF LAND being Lot 217, of BEACHSIDE VILLAGE, SECTION 3, a subdivision in Galveston County, Texas according to the map or plat thereof recorded in Plat Record 2013A, Map No. 14 in the Office of the County Clerk of Galveston County, Texas.

Subject property: 11438 Sea Butterfly Galveston County, Texas

This survey is certified for this transaction only and may only be relied on by Walter Lee Riley, Jr., Anne Vallot Goodman Riley and Bay Point Builders. This survey is only valid if print has original seal and signature of surveyor.

I hereby certify that this survey was made on the ground under my direct supervision and that this plat correctly represents the facts found at the time of the survey.

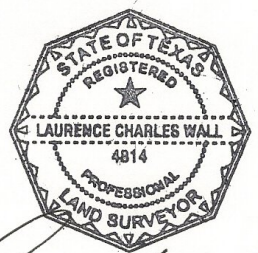

Laurence C. Wall

Laurence C. Wall
 RPLS #4814
 July 17, 2017

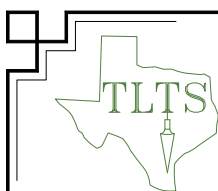

TLTS, Inc.
 TEXAS LAND TITLE SURVEYORS
 1801 Moody Avenue
 Galveston, Texas 77550
 (409) 765-8883