

FLOORPLAN SKETCH

Client: Scott & Diana Onstott File No.: 12944 Lake Parc Bend Dr
 Property Address: 12944 Lake Parc Bend Dr Case No.:
 City: Cypress State: Tx Zip: 77429

Sketch

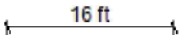
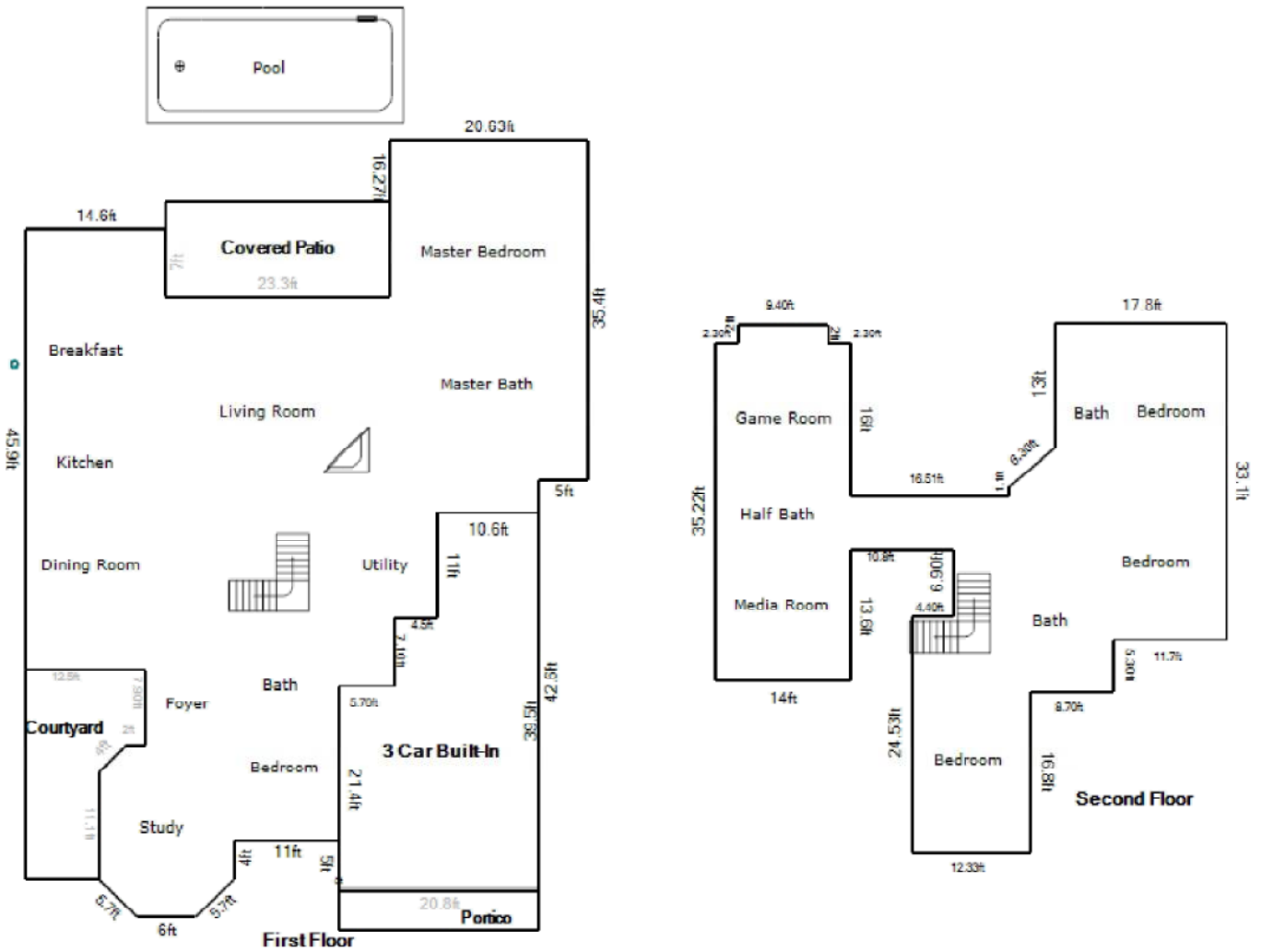

Living Area		Area Calculation			
First Floor	3592.14 ft ²	First Floor			x 1.00 = 3592.14 ft ²
3 Car Built-In	-668.93 ft ² □	12.5ft x 45.9ft x	1.00 =	573.75 ft ²	
Second Floor	1663.70 ft ² Δ	6ft x 5.7ft x	0.35 =	12.09 ft ²	
Nonliving Area		5ft x 20.8ft x	1.00 =	104 ft ²	
Courtyard	209.60 ft ² Δ	2.34ft x 5.31ft x	0.45 =	5.57 ft ²	
Portico	83.20 ft ² Δ	6ft x 5.7ft x	0.35 =	12.09 ft ²	
Covered Patio	233 ft ² Δ	18.47ft x 37.6ft x	0.50 =	347.31 ft ²	
		2ft x 4ft x	0.35 =	2.83 ft ²	
		5.60ft x 5.10ft x	0.43 =	12.31 ft ²	
		10.81ft x 4ft x	0.46 =	20.06 ft ²	
		10.81ft x 12.85ft x	0.48 =	66.49 ft ²	
		9.28ft x 14.20ft x	0.46 =	60.57 ft ²	
		13.56ft x 13.33ft x	0.37 =	66.15 ft ²	
		1.10ft x 24.65ft x	0.46 =	13.03 ft ²	
		43.38ft x 4.76ft x	0.60 =	103.29 ft ²	
		25.13ft x 41.89ft x	0.50 =	526.49 ft ²	
		43.64ft x 41.37ft x	0.47 =	848.77 ft ²	
		2.34ft x 1.03ft x	0.45 =	1.08 ft ²	
		5.97ft x 2.10ft x	1.00 =	12.53 ft ²	
		5ft x 28.14ft x	0.34 =	47.82 ft ²	
		23.3ft x 43.38ft x	0.22 =	222.05 ft ²	
		28.14ft x 19.13ft x	0.37 =	197.33 ft ²	
		16.27ft x 20.63ft x	1.00 =	335.72 ft ²	
		3 Car Built-In			x -1.00 = -668.93 ft ²
		20.8ft x 21.4ft x	1.00 =	445.12 ft ²	
		4.5ft x 7.10ft x	1.00 =	31.95 ft ²	
		10.6ft x 18.1ft x	1.00 =	191.86 ft ²	
		Second Floor			x 1.00 = 1663.70 ft ²
		16.8ft x 12.33ft x	1.00 =	207.19 ft ²	
		2ft x 9.40ft x	1.00 =	18.8 ft ²	
		35.22ft x 14ft x	1.00 =	493.11 ft ²	
		10.8ft x 6.62ft x	1.00 =	60.72 ft ²	
		5.30ft x 21.03ft x	1.00 =	111.47 ft ²	
		17.8ft x 33.1ft x	1.00 =	589.18 ft ²	
		4.40ft x 2.43ft x	1.00 =	10.69 ft ²	
		10.53ft x 14.95ft x	1.00 =	157.47 ft ²	
		4.05ft x 6.30ft x	0.38 =	9.77 ft ²	
Total Living Area (rounded):	4587 ft² □	1.1ft x 4.83ft x	1.00 =	5.31 ft ²	