

GUADALUPE COUNTY, TEXAS

Sur. 20

198.62 Acres
Marvin Neumann &
Richard Neumann, Jr.
to
Walter C. Anderson,
III, et ux
January 23, 1991
Vol. 941,
Pg. 708, D.R.

20.03 ACRES
TRACT 7
THIS DAY SURVEYED

49.75 Acres
Walter C. Anderson, III
& Carol N. Anderson
to
W C Anderson Family,
Ltd.
December 26, 2012
Vol. 4169, Pg. 728, D.R.

M. CHERINO
21.68 ACRES

TRACT 5

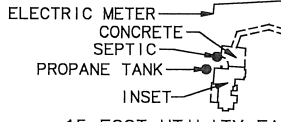

20.01 ACRES
TRACT 3
THIS DAY SURVEYED

699.00 Acres
Branch Family
Limited Partnership
to
Gaskin Ranch No 5 LLC
March 21, 2018
Doc #201899006441, O.P.R.
surveyed March 5, 2018

15-FOOT UTILITY EASEMENT

20.00 ACRES
TRACT 6
THIS DAY SURVEYED

60-FOOT ROAD &
UTILITY EASEMENT
THIS DAY SURVEYED

15-FOOT UTILITY EASEMENT

14.93 ACRES
TRACT 4
THIS DAY SURVEYED



abs⁺
10

SCALE 1" = 300'

BEARINGS SHOWN HEREON
ARE FROM GPS OBSERVATIONS
TEXAS COORDINATE SYSTEM
NAD (83).

THIS SURVEY WAS COMPLETED
WITHOUT THE BENEFIT OF A
TITLE COMMITMENT.

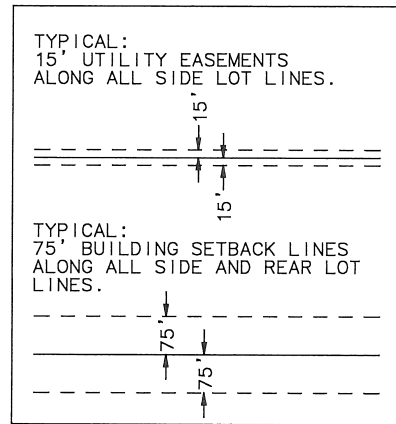
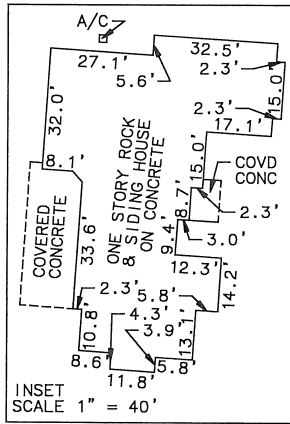

PREPARED FOR: GASKIN RANCH NO 5 LLC

SURVEYED ON THE GROUND: APRIL 12, JULY 5, & JULY 25, 2018

**A Plat of a 21.68 Acre Tract (Tract 5)
situated about 8.4 miles N 19° E of
Seguin in Guadalupe County, Texas.**

- LEGEND:
- E — OVERHEAD ELECTRIC LINE
 - xx — FENCE LINE
 - o — SET 5/8" IRON PIN
 - POB POINT OF BEGINNING
 - BSL BUILDING SETBACK LINE
 - D.R. DEED RECORDS GUADALUPE COUNTY, TEXAS
 - O.P.R. OFFICIAL PUBLIC RECORDS GUADALUPE COUNTY, TEXAS

I HEREBY CERTIFY THAT THE FOREGOING PLAT AND ACCOMPANYING FIELD NOTE DESCRIPTION WERE PREPARED FROM AN ACTUAL SURVEY PERFORMED ON THE GROUND, UNDER MY SUPERVISION, AND THAT THEY ARE TRUE AND CORRECT TO THE BEST OF MY KNOWLEDGE AND BELIEF. HOWARD SURVEYING, LLC ACCEPTS RESPONSIBILITY FOR THIS PLAT ONLY TO THE ORIGINAL CLIENTS FOR WHICH IT WAS PREPARED.

THIS THE 18TH DAY OF OCTOBER 2018.

Keith Howard
KEITH HOWARD, R.P.L.S. NO. 5949
HOWARD SURVEYING, LLC
TBPLS FIRM NO. 10125700
402 STATE HWY 173 SOUTH
HONDO, TEXAS 78861
830-426-4776



IMPROVEMENTS SURVEYED: AUGUST 18, 2020