

NOTES :

- 1.) BEARINGS FOR THIS SURVEY ARE BASED ON THE 0.333 ACRE TRACT RECORDED IN VOL. 924, PAGE 24 OF THE OFFICIAL RECORDS OF POLK COUNTY, TEXAS.
- 2.) PROPOSED BORROWER : MAMIE ADAMS MANDOT and ANITA MANDOT HICKMAN
- 3.) GF NO. OR FILE NO. : 9913083

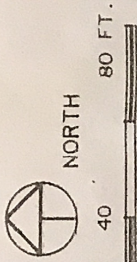

CHARLES F. HOUSE and wife
 KIM M. HOUSE
 S. 884 AC.
 V. 595, P. 95
 P.C.O.R.

REQUIRE OF
 BETTIE DAVIS
 V. 434, P. 535
 P.C.O.R.

LESIE B. & PHYLLIS J. SUTHERLAND
 0.333 AC. - V. 803, P. 510 - POLK COUNTY
 OFFICIAL RECORDS

113

S 86°00'00" E - 166.02'
 FND. 1/2" IRON ROD

70.28'

80.74'

GRAVEL PARKING

CONCRETE

86.49'

S 04°00'00" W

15.0'

ELECTRIC LINE

15'

5'

FND. 1/2" IRON ROD

OVERHEAD

ELEC. SERV. LINES

114
 (0.333 AC.)

WOODEN DECK

SLABS

COVERED PARKING

FRAME HOUSE WITH 7/8" SIDING

WOODEN DECK

74.53'

N 86°00'00" W - 149.33'

FND. 1/2" IRON ROD

59.82'

ESCAPE'S INC.
 RESIDUE OF 15.164 AC.
 VOL. 726, PG. 501
 POLK COUNTY OFFICIAL RECORDS

115
 WALLACE & CAROL JENNINGS
 0.666 AC.
 VOL. 805, PG. 724 - POLK COUNTY OFFICIAL RECORDS

15 FT. ROAD
 EASEMENT & 5 FT. UTILITIES EASEMENT
 (V. 924, P. 724)

ESCAPE'S INC.
 RESIDUE OF 15.164 AC.
 VOL. 726, PG. 501
 POLK COUNTY OFFICIAL RECORDS

SURVEY PLAT

SHOWING 0.333 ACRE OF LAND SITUATED IN THE STATE OF TEXAS, COUNTY OF POLK, A PART OF THE A. VIESCA SURVEY, A-77, AND BEING KNOWN AS LOT ONE HUNDRED FOURTEEN (114) RAINBOW'S END, AN UNRECORDED SUBDIVISION IN POLK COUNTY, TEXAS AND BEING THE SAME LAND DESCRIBED IN DEED TO GORDON E. THRANE AND MARJORIE R. THRANE, TRUSTEES OF THE THRANE FAMILY TRUST AS RECORDED IN VOLUME 924, PAGE 724, OFFICIAL RECORDS, POLK COUNTY, TEXAS.

1 ft = 1.2"

DATA ANITA LAND \ Sometimes Ann Plat & Report edit