

**FLOOR PLAN**

SCALE 1/8" = 1'-0"

AREAS	
LIVING	2,056 SQ. FT.
AUTO STORAGE	479 SQ. FT.
COVERED PORCH	42 SQ. FT.
COVERED PATIO	151 SQ. FT.
<b>TOTAL UNDER ROOF</b>	<b>2,728 SQ. FT.</b>

**NOTE:**  
Any specific additional items not called out on this plan that are desired is as per owner! Builder to verify!

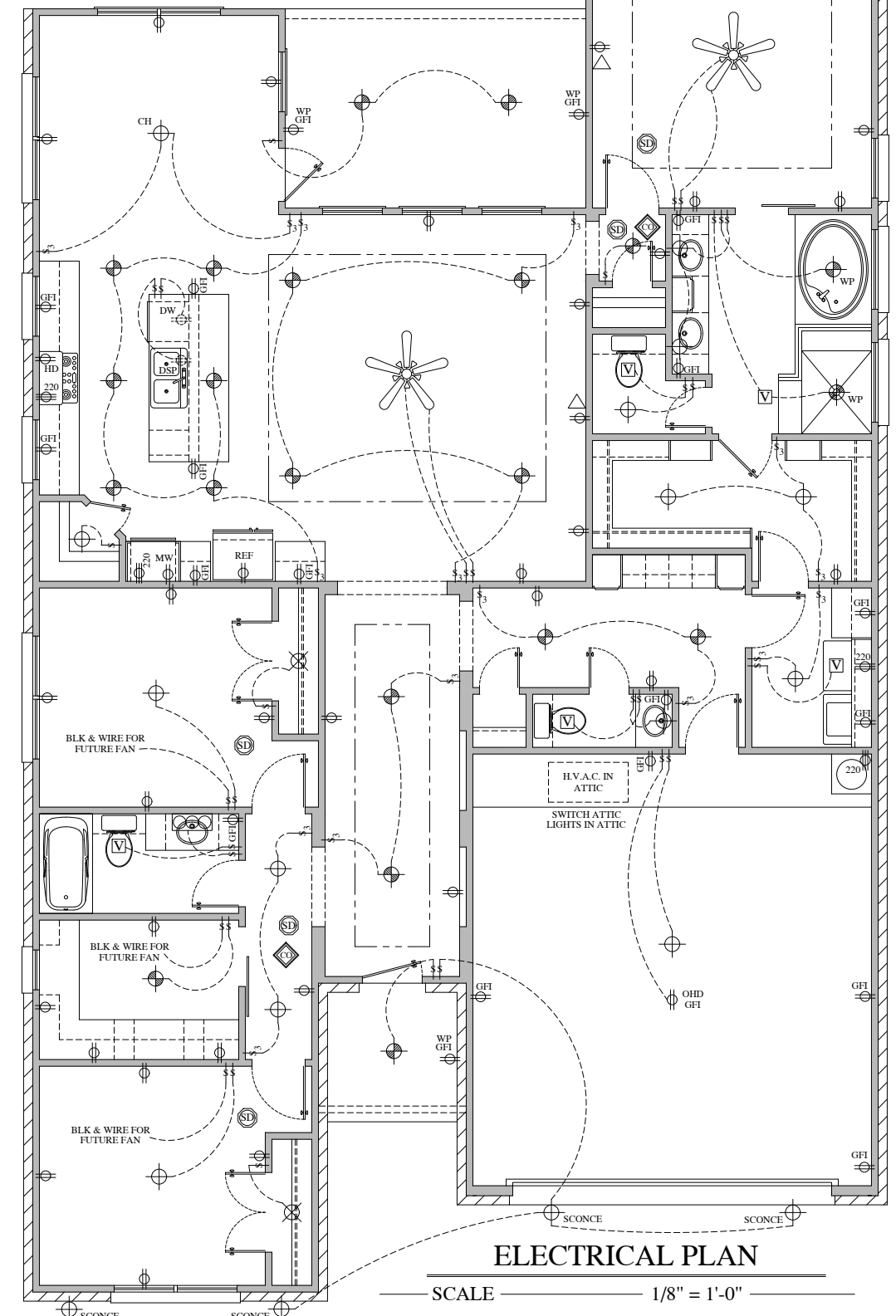

**ELECTRICAL PLAN**

SCALE 1/8" = 1'-0"

- NOTE:** Location of beams subject to change as per framer.
- NOTE:** Foundation, framing package, & windstorm by other.

**GENERAL NOTES**

- SMOKE DETECTORS are required in all dwellings units and must be installed in accordance with the International Building Code. These detectors must receive their primary power via direct wiring into the house current and be equipped with a battery back-up & interconnected.
- In each utility room and bathroom, a window must be operable or a mechanical vent is required.
- IN EVERY BEDROOM, a window must be operable NET CLEAR OPENING WIDTH IS 20 INCHES NET CLEAR OPENING HEIGHT IS 24 INCHES NET CLEAR OPERABLE AREA IS 5 SQ. FT. 1ST FLOOR NET CLEAR OPERABLE AREA IS 8.7 SQ. FT. 2ND FLOOR
- WALLMOUNT BREAKERS REQUIRED ON ALL HOBS AS PER THE INTERNATIONAL PLUMBING CODE.
- Pilot light must be 18 inches above finish floor
- Heating unit installed in attic may not be more than 20 feet from attic access.
- 240-24 LOCATION IN OR ON PREMISES Not in vicinity of easily ignitable material. Overcurrent device shall not be located in the vicinity of easily ignitable material such as clothes closets.
- Required separation between the residence and garage must consist of one-half (1/2) inch gypsum board installed on the garage side and a tight fitting, weather-stopped, solid core wood door at least six and three-quarter (6-3/4) inches in thickness at any point. A labeled fire assembly having a 20 minute fire protection rating may be used in lieu of the solid core door.
- Regulations for interior and exterior window and door safety glazing are set forth by IRC 2006 R308.4

**ELECTRICAL LEGEND**

	FAN
	FAN WITH LIGHT
	CHANDELIER
	LIGHT FIXTURE
	MOTION LIGHT
	RECESSED LIGHT
	EYEBALL FIXTURE
	LIGHT SWITCH
	3-WAY LIGHT SWITCH
	SMOKE DETECTOR
	CARBON MONOXIDE ALARM
	LIGHT
	VENT
	HEATER
	PLUG LOCATED BY OWNER
	110 PLUG ARCH-FAULT, TAMPER RESISTANT
	220 PLUG
	GROUND FAULT PLUG
	110 FOUR PLEX ARCH-FAULT, TAMPER RESISTANT
	WATER PROOF PLUG
	CABLE FOR TELEVISION
	PHONE JACK
	BAR LIGHT
	ROPE LIGHT
	UNDER, ABOVE AND IN CABINET LIGHTING

- NOTE:** Any additional electrical is as per owner/builder.
- NOTE:** Placement of t.v. and phone outlets is as per owner.
- NOTE:** Ethernet access points are as per builder!
- NOTE:** Electrical to be verified by owner before start.
- NOTE:** Master shower to be dropped 6"

**Copyright ©**  
This plan is for construction of one building only and is not to be reproduced, stored in a retrieval system, or transmitted in any form or by any means, without the written permission of Freeman Custom Home Design.

**NOTE:**  
Questions concerning initial layout or framing should be directed to Freeman Custom Home Design. Freeman Custom Home Design is not responsible for framing discrepancies that deviate from this plan, if not called before completion framed. See Above.

**REVISIONS**

NO.	DESCRIPTION

Freeman Custom Home Design assumes no liability for any structure built from these plans. Before construction, the purchaser, builder, or contractor must verify all dimensions, verify compliance with all building codes, and incorporate site conditions. Only a qualified designer, architect, or structural engineer should be permitted to alter these plans. All written releases of Freeman Custom Home Design.

**A New Home By:**  
**Manley Homes**  
**9111 Anna St.**

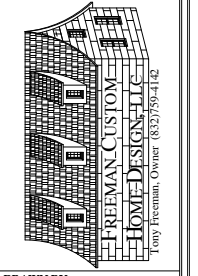

**DRAWN BY:** TLF  
**DATE:** OCT. 2020  
**SHEET:** 1 OF 4  
**PLAN NO.:** 2056