

unless otherwise noted

- CARPET FLOORS
- GYP. BOARD WALLS AND CEILING
- 10'-0" CLG. HT. AT FIRST FLOOR
- 8'-0" CLG. HT. AT SECOND FLOOR
- ALL ANGLES TO BE 45 DEGREES
- 1 3/4" S.C. DOORS
- 8'-0" DOOR HT. AT FIRST FLR.
- 6'-8" DOOR HT. AT SECOND FLR.
- SINGLE HUNG VINYL WINDOWS ( DIVIDED LTS. WHERE OCCURS )
- 8'-0" HEADER HT. AT FIRST FLR.
- 7'-0" HEADER HT. AT SECOND FLR.
- ALL BEDROOM WINDOWS TO BE 44" A.F.F. (MAX.)
- 24" HIGH X 20" WIDE (MIN) OPENING WITH 5.7 SQ. FT. (MIN) NET CLEAR OPENING
- WHEN DOORS ARE USED FOR EMERGENCY EGRESS, IT SHALL BE OPERATIONAL FROM THE INSIDE WITHOUT THE USE OF KEYS OR TOOLS.
- ALL GLAZING WITHIN HAZARDOUS LOCATIONS SHALL HAVE SAFETY GLASS IN COMPLIANCE WITH R308 (IRC 2006)
- ALL EGRESS DOORS & WINDOWS SHALL HAVE LOCKS ALLOWING EGRESS WITHOUT THE USE OF A KEY AND MEET R310 & R311.
- SMOKE DETECTORS REQUIRE 10V CONNECTION TO HOUSE WIRING AND BATTERY BACKUP. LOCATIONS TO COMPLY WITH R315 (IRC 2006). MULTIPLE UNITS SHALL BE INTERCONNECTED TO ACTIVATE ALL ALARMS. CONSULT MANUF. RECOMMENDATIONS FOR DISTANCE FROM R/A.
- LOCATE GAS WATER HEATER IN ATTIC ABV. LOAD BEARING PARTITION IN PAN WITH RELIEF DRAIN LINE TO OUTSIDE. INSTALLATION MUST COMPLY WITH MANUF. INSTRUCT. AND ALL APPL. CODES.
- PROVIDE VENTILATION AT ALL BATHS AND UTILITY ROOMS THROUGH NATURAL OR MECH. MEANS AND COMPLY WITH R303 (IRC 2006)
- CHIMNEYS TO BE 3'-0" MIN. ABV. THE HIGHEST POINT WHERE THEY PASS THROUGH THE ROOF AND AT LEAST 2'-0" MIN. HIGHER THAN ANY PORTION OF THE ROOF WITHIN A 10'-0" RADIUS
- ALL PREFAB FIREPLACES TO BE UL. & IRC 2006 APPROVED & A COPY OF THE MANUF. INSTALLATION MANUAL SHALL BE AVAILABLE @ JOB SITE FOR INSPECTOR'S REVIEW
- A CARBON MONOXIDE DETECTOR SHALL BE INSTALLED IN BEDROOMS WHEN A GAS FIREPLACE IS INSTALLED.
- STAIRWAYS SHALL COMPLY WITH R311 (IRC 2006) SEE DETAIL SHT.
- HANDRAILS TO BE 34" TO 38" ABV. NOSE OF TREAD
- ALL GUARDRAILS AND HANDRAILS SHALL COMPLY WITH R311 (IRC 2006)
- GUARDRAILS TO BE 36" A.F.F. (MIN) WITH BALUSTERS AT 4'-0" MAX. PER R311 & R312 (IRC 2006) SEE DETAIL SHT.
- HANDRIPING PORTION OF HANDRAILS SHALL BE NOT LESS THAN 1 1/4" NOT MORE THAN 2" IN CROSS SECTIONAL DIMENSION OR THE SHAPE SHALL PROVIDE AND EQUIV. GRIPPING SURFACE PER R311 (IRC 2006)
- ENCLOSE UNDERSIDE OF STAIRWELL WITH 5/8" TYPE "X" FIRE CODE GYP. BOARD
- SIZE AND NUMBER OF NAILS CONNECTING WOOD MEMBERS SHALL COMPLY WITH IRC 2006 TABLE R602.3 (1) & (2) (OR EQ.) REFER TO STANDARD DETAIL SHEET
- DISAPPEARING STAIRS TO BE MIN. 22" X 30" CLEAR OPENING (30" X 34" R.O.) & SHALL COMPLY WITH R307 (IRC 2006). INDIVIDUAL STAIR TREADS SHALL BE DESIGNED FOR UNIFORMLY DISTRIBUTED LIVE LOAD OR A 350 LB CONCENTRATED LOAD ACTING OVER AN AREA OF 4 SQ. INCHES, WHICHEVER PRODUCES THE GREATEST STRESS
- ATTIC ACCESS/DISAPPEARING STAIRS IN THE GARAGE CLG. MAY BE INSTALLED PROVIDED THE EXPOSED PANEL IS NOT LESS THAN 3/8" THICK FIRE RETARDANT TREATED PLYWOOD, 1/2" SHEET ROCK OR COVERED W/ A MIN. OF 16ga SHEET METAL. ROUGH OPENING SHALL NOT BE LESS THAN 22"X30" AS PER IRC 2006 SECTION R807.1. COMPLY W/ R304.2.

bath schedule

- TILE FLOORS (AT WET AREAS)
- TILE WALLS AT TUB (SECONDARY BATHS)
- TILE FULL AT SHOWER
- SOLID SURFACE COUNTER TOPS AND SPLASHES
- ALL GLASS AT TUBS AND SHOWERS SHALL BE TEMPERED SAFETY GLASS AND MUST COMPLY WITH R308 (IRC 2006)
- SHOWER STALLS AND TUB (WITH SHOWER HEADS) WALLS TO BE FINISHED WITH NON ABSORBENT SURFACE TO A HT. OF NOT LESS THAN 12" ABV. DRAIN INLET OVER CONCRETE BACKERBOARD R301.
- ALL PLUMBING FIXTURES SHALL BE SPACED PER R301.2 (IRC 2006)

SULLIVAN HENRY OSSERO & ASSOC., INC. IS A PROFESSIONAL BUILDING DESIGN FIRM. IT IS NOT AN ENGINEERING FIRM. WE ARE NOT QUALIFIED TO NOR LICENSED TO DESIGN STRUCTURAL FRAMING OR FOUNDATIONS. A LICENSED PROFESSIONAL ENGINEER SHOULD BE CONSULTED REGARDING THE FRAMING AND FOUNDATION. SHOULD AN ENGINEER'S SEAL BE PRESENT ON THESE DRAWINGS, THE "ENGINEER OF RECORD" SHALL BEAR THE RESPONSIBILITY FOR THE STRUCTURAL DESIGN. SULLIVAN HENRY OSSERO & ASSOC., INC. WILL NOT BE HELD RESPONSIBLE FOR THE STRUCTURAL DESIGN IN ANY WAY AND/OR ANY PROBLEMS WHICH MAY ARISE.

square footage

FIRST FLOOR	1897
SECOND FLOOR	1242
<b>LIVING AREA</b>	<b>3139</b>
PORCH	80
2 CAR GARAGE	442
COVID PATIO	144
<b>TOTAL COVERED AREA</b>	<b>3855</b>

first floor plan

SCALE: 1/4" = 1'-0"

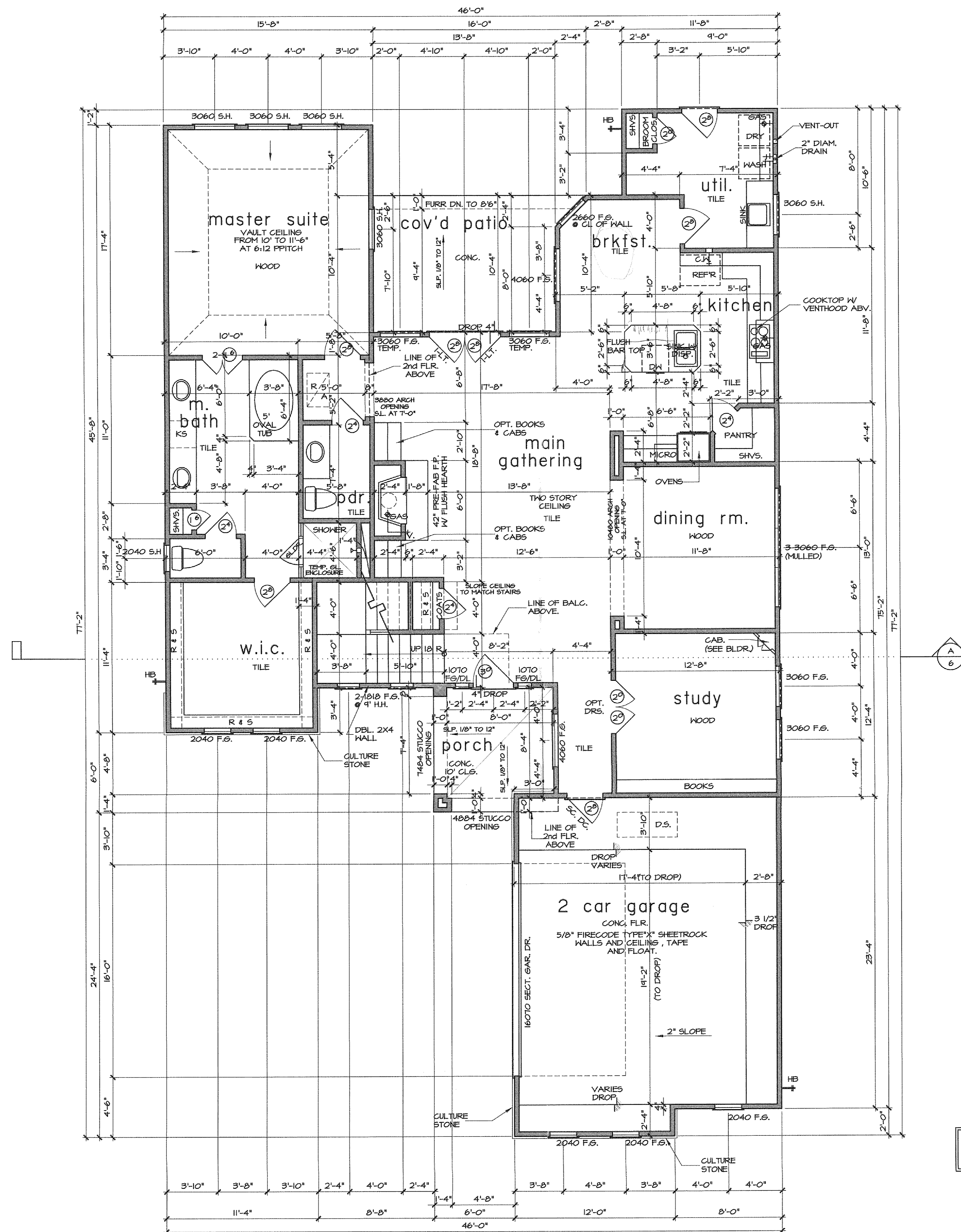

ALL INTERIOR ARCHES AND FLOOR FINISHES SHALL BE AS PER BUILDER SPECIFICATIONS

I:\Builder\Archives\Kicker\Drawings\3134\3134\_01.dwg, 6/26/2013 3:51:14 PM, Addba.rvt  
 B01044