



ROLLER
REALTY



28403 Evergreen Cove Lane • Cross Creek Ranch

STUNNING



Huge lot with tons of PRIVACY and MASSIVE BACKYARD is home to this extraordinary 2-Story. Eye catching exterior with soaring gable roofs, perfect blend of tumbled brick and Austin Stone, accent shutters and a metal shed roof. Dramatic light and bright floor plan is calming and finely appointed with designer granites, 8' doors, wrought iron, crown molding, custom paint, lots of tile floors and impressive 10' ceilings upstairs. Stunning, extended Foyer with 22' ceiling. Large Study (or Media Room) has custom ceiling fan. Gas log fireplace in 2-story Family Room. Gas cooktop, DOUBLE OVENS, large walk-in Pantry and fine cabinetry in spacious Island Kitchen. Fabulous Eating Area well suited for casual or formal dining. Master offers tray ceiling, lots of privacy and vista views while Bath has His & Her vanities, clear glass shower and stylish sunken tub. 2-BEDROOMS DOWN and 2-up; along with a large Gameroom with raised ceiling. Secret Closet. Covered back Porch and oversized 3-car Garage.

For a high-tech, 3-D tour of this home. Please scan the QR. In doing so, you will be able to see the actual floor plan along with a "dollhouse" view of the home. You will also be able to navigate thru the home with your mouse; going from room to room at your leisure with 360-degree views and from floor-to-ceiling. This enables you to take a complete tour of the home, from anywhere in the world. Amazing!

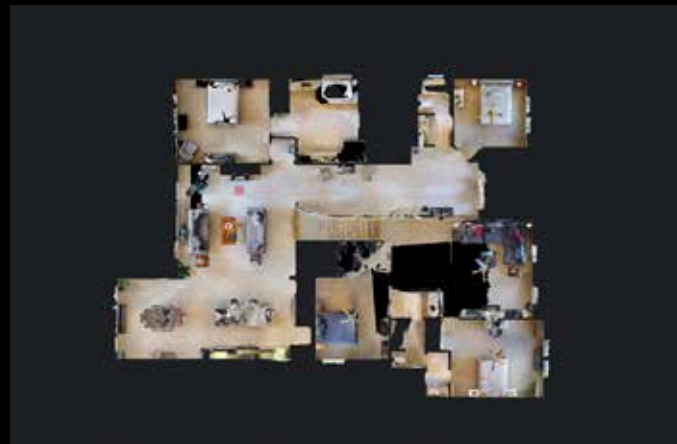



FOYER

Guests enter the home and witness an impressive, open Foyer that is finely finished with designer tile floors and 22' ceilings. The front door with its two French-paned sidelights and the large arched transom window overhead provides streams of sunlight that pour into the space.

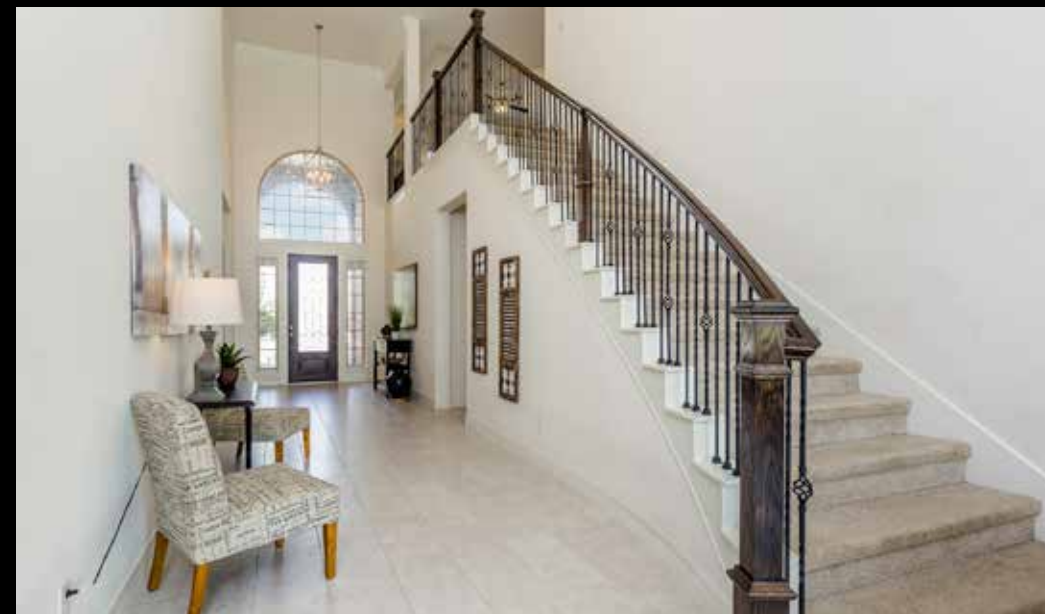

STUDY

The Private Study is large enough and has plenty of wall space for the furniture of any home office, or a quiet sitting room. This well-designed space can serve the needs of any lifestyle, topped with detailed crown molding and a flush mount ceiling fan.



STAIRCASE

The curving staircase is a masterpiece in design, meticulously finished with custom molding and decadent trim, washed in pale white paint, which makes the contrasting banister and stair rails in warm wood tones and iron stand out richly.



FAMILY ROOM

Spacious enough for several oversized sofas and armchairs or a large sectional, the Family Room is well-designed for relaxation and leisure, perfect for evenings spent watching flames dance in the fireplace, or enjoying a movie night in the comfort and relaxed atmosphere of this beautiful space. A trio of windows provides plenty of light and views of the entire backyard. The Stacked Stone Fireplace set in custom wood work is the centerpiece of this Family Room wall; freshly painted with an accent color, a focal point to be enjoyed and appreciate all year long. Gas log flames flicker gently, filling the Family Room with soft comfort. The Family Room is regarded as the "heart" of the home and this one also offers the simple sophistication and welcoming laid back style that fits so well. Notice how the room transitions seamlessly and openly to the Kitchen.

KITCHEN

There is no substitute for style and class and this Kitchen has it all. The rich tones of the Custom Cabinetry are truly a masterpiece to behold. Loads of cabinet-space and seas of smooth glistening granite stand ready to serve. The Central Island features an under mount Kitchen Sink and stainless steel dishwasher, ideally located for the home chef to work and still maintain conversation with guests or time with the family. This Kitchen is a dream! An oversized Island is the centerpiece topped by a pair of elegant pendants. GE stainless-steel appliances including a whisper-quiet dishwasher, double convection oven, 5 burner gas stove and custom built-in range hood and microwave. Tall cabinetry is topped with crown molding, and upgraded granite countertops with a custom backsplash finish the space.

BREAKFAST

Located just off the Kitchen, this Breakfast Room is simply stunning with a wall of windows, and convenient door that beckons to extend that morning cup of coffee to the privacy of the back Patio.





MASTER SUITE

This Master Bedroom marries style with purpose. The tray ceiling and custom crown molding add drama while the soft color palette soothes. Featuring wall-to-wall carpet for comfort and warmth give this spacious room an added touch of luxury and pleasure. There is also a Sitting Area set in front of a trio of tall windows that span the width of the room. The Master is not only beautiful; it is also grand in size with plenty of room for dressers and armoire's. This also provides a look at the double doors that open to the beautiful En-Suite Bath.

The Master Bath is a step into luxury, with His and Her separate vanities bathed in designer level granite with under-mount sinks and a mirror above, featuring a framed glass shower enclosure and oversized garden tub. Starting and finishing each day here will be a joy. Melt the cares of the day away within this large Garden Tub, perfect for soaking. It sits beneath a trio of windows with privacy-glass which fill the room with soft and filtered light, adding additional bright rays to bounce endlessly off the glistening finishes of this finely appointed Master Bath.

GAME ROOM

The Game Room is as versatile as it is comfortable. With room for a game table or an additional TV viewing room, the room is light and bright, sunny and spacious. With an upgraded ceiling fan, tray ceiling and two very large windows, this is a great space for fun. Conveniently located upstairs, the enormous Gameroom easily accommodates a pool table or serves as a play area for the kids. Lovely views, and a balcony that overlooks the Foyer gives this room that something special.

SECRET ROOM

This house offers a Secret Room upstairs off the Game Room and accessed through a hidden door that is a bookcase.

BED & BATH

Nestled privately away, is a welcomed downstairs Guest Bedroom that is beautifully appointed with wall to wall carpet, a custom ceiling fan and lovely views out the front of the home. The Downstairs bathroom has Rich wooden cabinets are topped with granite and an under mount sink and upgraded faucet beneath a large mirror. The tub and shower is lined with upgraded tile, demonstrating the consistency in fine finishes that fill this entire home. The two upstairs Bedrooms are truly charming. Spacious enough for children's rooms or guest rooms with large furniture pieces, the architectural details are delightful with plush neutral carpet for added comfortable and appeal. The Jack and Jill Bath with two separate vanities, each finely finished with fine cabinetry, gorgeous granite, stainless hardware and custom mirrors.





PORCH

Accessible from the Breakfast Room, The Covered Back Porch with inset lighting and a ceiling fan easily fits seating for the family, enhancing the outdoor living experience this home offers. There is room for a grill, outdoor dining, and a fire pit for chilly fall evenings.

BACKYARD

The large Back Yard spreads along the length of the entire home, offering more than enough room to throw a football or play fetch with the dog. This yard is ready for hosting guests for outdoor cookouts and dining el fresco. This Back Yard hosts plenty of space for a lawn games of leisurely enjoyment, a game of fetch with the dog, and quiet afternoons spent sitting on the Back Porch with a favorite book. The house backs up to green space so you will never have back neighbors. This huge back yard is a blank slate waiting for you to create your personal oasis. Add custom landscaping, a children's playscape or a swing set, bringing this Back Yard full circle from relaxing outdoor space to the perfect place for memories to be made.





DRAMATIC

28403 Evergreen Cove Lane • Cross Creek Ranch



Scan this QR code
to take a
virtual tour



ROLLER
REALTY

NO ONE DOES MORE



RollerRealty.net 281-346-0222



KAREN DAVIS



MIKE ROLLER



JORDYN ROLLER