

1/4" FLOOR PLAN

UNIT 283E FOUR LEAF TOWERS

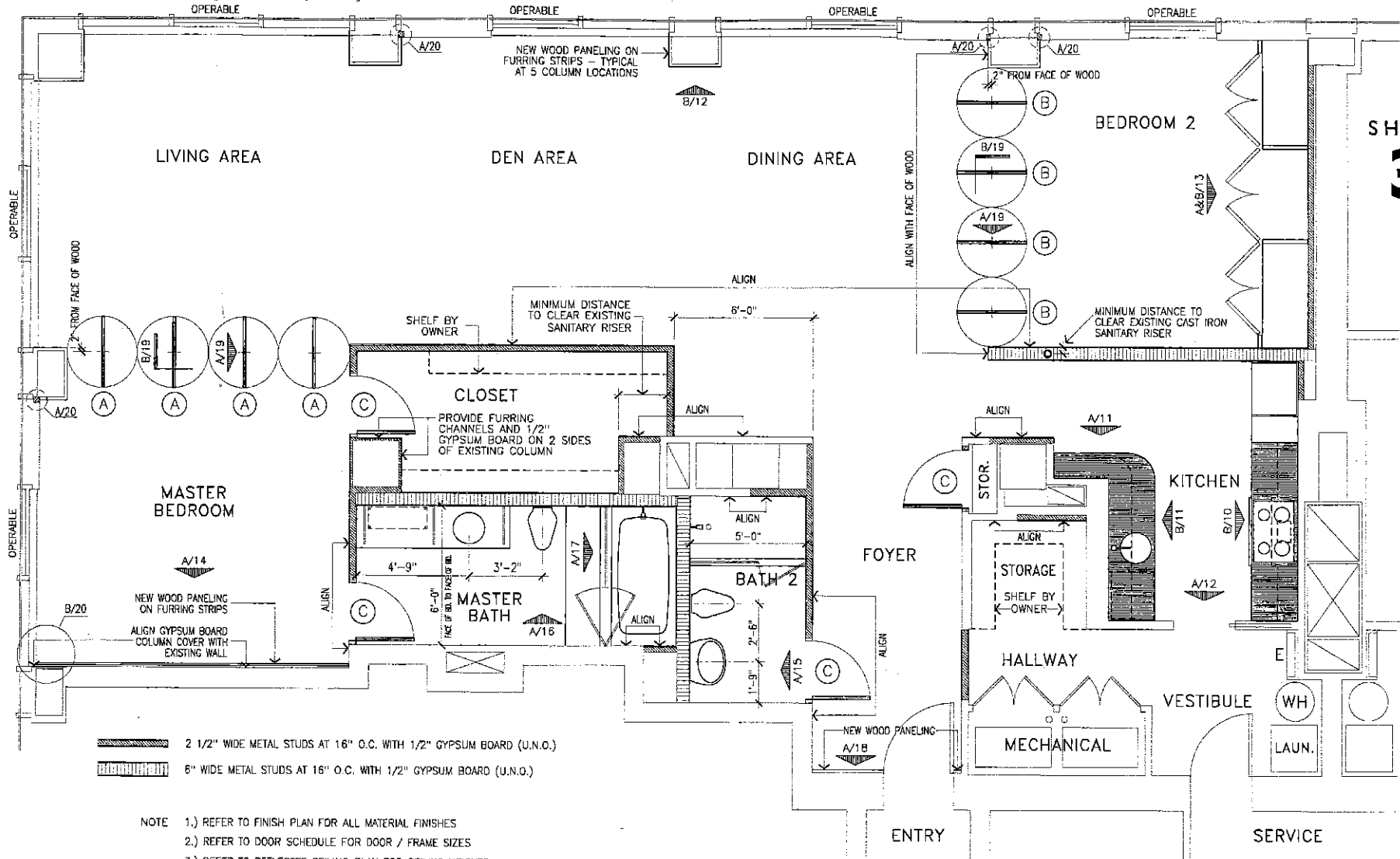

REVISION #1 - 20 MARCH 1998, REVISION #2 - 19 APRIL 1998, REVISION #3 - 25 APRIL 1998



SHEET
3

- 2 1/2" WIDE METAL STUDS AT 16" O.C. WITH 1/2" GYPSUM BOARD (U.N.O.)
- 6" WIDE METAL STUDS AT 16" O.C. WITH 1/2" GYPSUM BOARD (U.N.O.)

- NOTE
- 1.) REFER TO FINISH PLAN FOR ALL MATERIAL FINISHES
 - 2.) REFER TO DOOR SCHEDULE FOR DOOR / FRAME SIZES
 - 3.) REFER TO REFLECTED CEILING PLAN FOR CEILING HEIGHTS
 - 4.) UTILIZE 1/2" THICK CEMENT BOARD FOR WALLS IN MASTER BATH AND BATH 2