

Bob Salley Real Estate Company, Inc.  
 Remainder of 30.21 Ac.  
 Vol. 526, Pg. 476

N 30° 51' 34" E 150.24' Meas.  
 N 31° 11' 40" E 150.00' Plat

Scale: 1" = 30'  
 Base bearing for this  
 Survey is the common  
 line of Lots 6 & 7,  
 S 58° 48' 20" E

Lot 7  
 Bob Salley Real Estate  
 Section 1  
 A. Smith Survey, A-834  
 Leon County, Texas  
 1.003 Ac.  
 Recorded in Volume 4, No. 133,  
 Envelope 171-A, Map Records,  
 Leon County, Texas  
 Charlie E. Carrigan  
 Vol. 797, Pg. 584

I, Donald B. Spence, Registered Professional  
 Land Surveyor, do hereby certify that the plat  
 as shown hereon, represents the results of  
 an on the ground survey, made under my direction,  
 and is true and correct to the best of my  
 knowledge. Surveyed Nov. 7, 1998

Donald B. Spence  
 Registered Professional Land Surveyor

N 58° 48' 20" W 291.00' Plat  
 N 58° 48' 20" W 290.58' Meas.

3 58° 48' 20" E 291.09' Plat  
 5 58° 48' 20" E 291.00' Plat

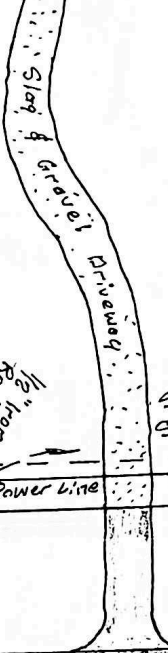
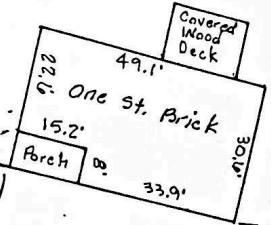

Note: Water Meters  
 on all tracts indicate  
 water line in area.

Lot 6  
 Michael W. Wood  
 Vol. 888, Pg. 779

Lot 8  
 Benny R. Talbott  
 Vol. 894, Pg. 716

150.00' Plat  
 150.59' Meas.

S 31° 11' 40" W 150.00' Plat  
 S 31° 03' 22" W 150.24' Meas.

100.00' Plat  
 99.52' Meas.

U.S. HIGHWAY 79

JEWETT

BUFFALO

**PLAT OF SURVEY**

Lot 7, Bob Salley Real  
 Estate, Section 1, A.  
 Smith Survey, A-834,  
 Leon County, Texas

Donald B. Spence  
 Registered Professional  
 Land Surveyor  
 PO Box 53  
 Centerville, Texas 75833  
 903-536-2766