

LOT 47

LOT 46

LOT 45

FND 5/8"
I.R.

FND 5/8"
I.R.

S 58° 04' 47" W 72.05'

8' U.E.

5' x 20' A.E.

LOT 40

S 30° 45' 13" E 116.76'

N 30° 45' 13" W 116.76'

LOT 38

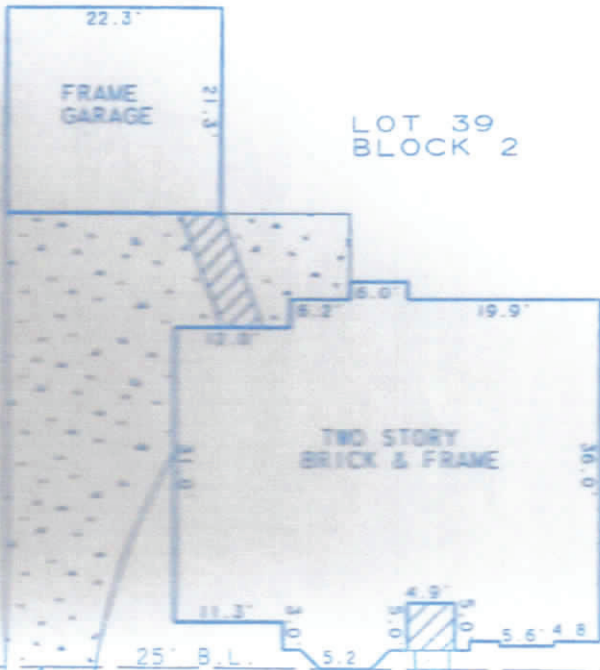

FND 5/8"
I.R.
(100%)

N 58° 04' 47" E 72.05'

FND 1/2"
I.R.
(DCM)

DANETTE COURT

(60' ROW)

Survey based on address per
Mapbook provided by title co.
Agreement with F.L.C. P. Copy # 7-7524

PLANNING INFORMATION

ZONE TR
 PANEL NO. 48201C-0245J
 DATE 11-6-96
 OF NO. 205-124162
 JOB NO. 98215710
 SCALE 1" = 20'

Purchaser WILLIAM C. IJEN & NANCY P. IJEN
 Address 8014 DANETTE COURT SPRING, TEXAS 77379
 Lot 39 Block 2 Sec. 1
 Survey _____
 Area _____
 Subd MEMORIAL NORTHWEST ESTATES
 Vol. 274 Page 6 MR. HARRIS COUNTY, TEXAS

To FIRST AMERICAN TITLE COMPANY, WASHINGTON MUTUAL