

### Building Sketch

Borrower	Sean M Doran				
Property Address	21307 Russell Chase Dr				
City	Porter	County	Montgomery	State	TX
Zip Code	77365				
Lender/Client	Navy Federal Credit Union / VA				

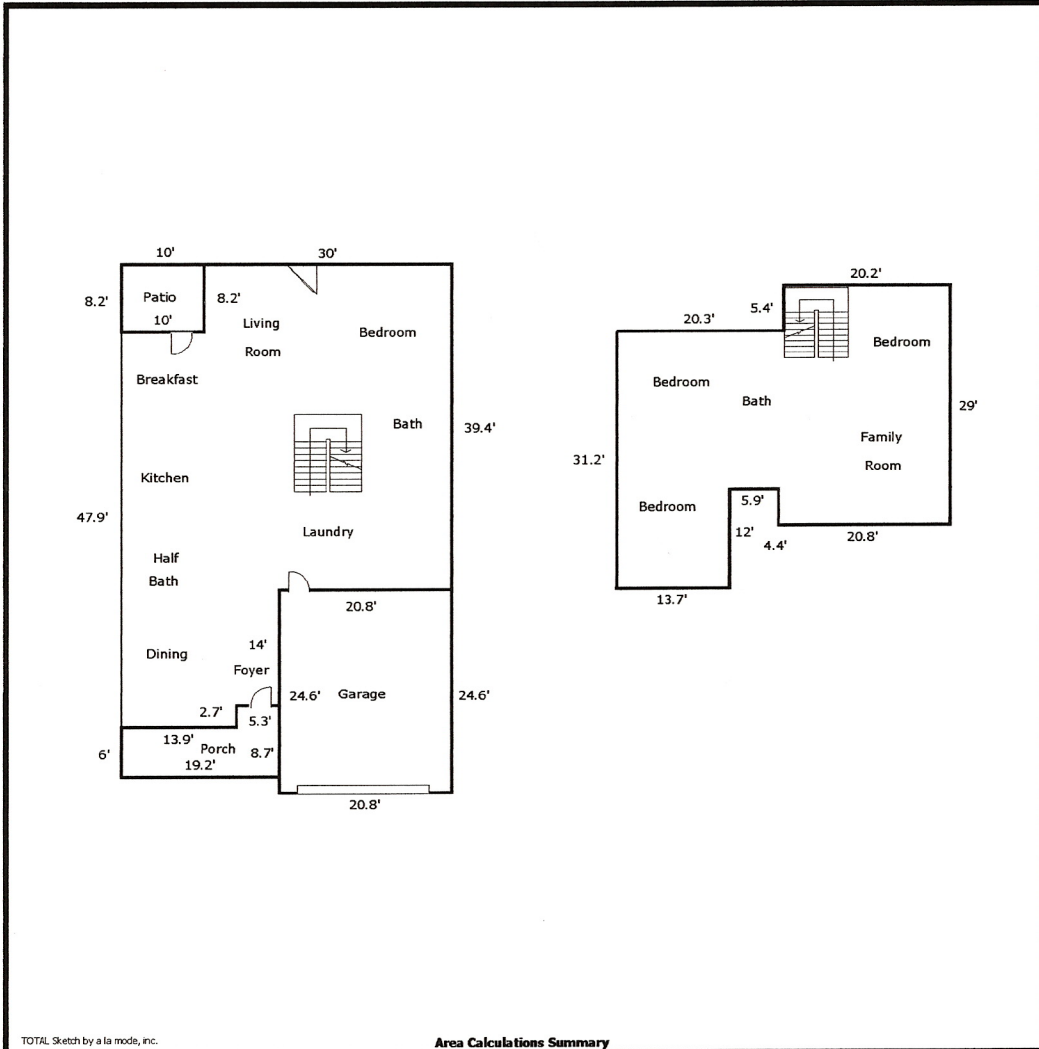

TOTAL Sketch by a la mode, inc.

#### Area Calculations Summary

Living Area		Calculation Details
<b>First Floor</b>	1800 Sq ft	$39.4 \times 20.8 = 821.2$ $9.2 \times 8.2 = 74.9$ $45.2 \times 5.2 = 237.6$ $47.9 \times 13.9 = 666$ $0.5 \times 47.9 \times 0 = 0.4$
2 Car Attached	512.2 Sq ft	$20.8 \times 24.6 = 512.2$
<b>Second Floor</b>	1140.4 Sq ft	$29 \times 20.2 = 584.8$ $23.6 \times 0.7 = 15.7$ $19.2 \times 5.9 = 113.4$ $31.2 \times 13.7 = 425.9$ $0.5 \times 31.2 \times 0 = 0.5$
<b>Total Living Area (Rounded):</b>	<b>3453 Sq ft</b>	
<b>Non-living Area</b>		
Covered Porch	128.9 Sq ft	$8.7 \times 5.2 = 45.5$ $13.9 \times 6 = 83.4$
Covered Patio	81.5 Sq ft	$8.2 \times 10 = 81.5$