

HOME ENERGY RATING

A Home Energy Rating is the projected energy performance of a home based on a review of the construction plans. A lower score on the HERS® Index scale means a more energy efficient plan.

Use the scale below to see where the construction plan for your model falls on the Home Energy Rating scale.

HERS INDEX

Typical existing home**

Typical new home*

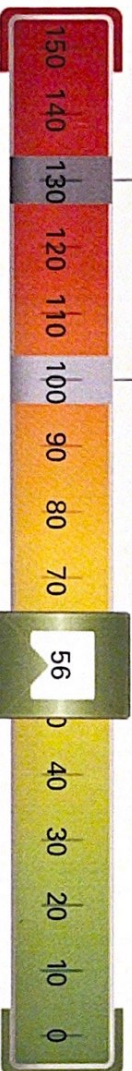

HERS INDEX SCORE FOR THIS PLAN

56

The lower the rating on the scale, the more energy efficient the home.

DIAMOND Program Level	HERS Index Score	65 or lower	Minimum Energy Efficiency Improvement Over Code Compliant Home*	35% or more			
Builder	DAVID WEEKLEY HOMES	Community	TOWNE LAKE	Address	10810 SLUMBERING FALLS LN,...	Plan	4802

MASCO
HomeServices

DavidWeekleyHomes.com

*2006 International Energy Conservation code compliant home ** Typical existing home per U.S. Department of Energy's EnergySmart Home Scale™. The HERS Index score is a scoring system established by Residential Energy Services Network (RESNET), a third party, in which a score of 100 is what a standard new home built to IECC 2006 would score, while a score of 0 is a new home that has net-zero energy use. The HERS Index score shown is calculated for the home plan as designed, not as built, using software approved by RESNET. This software assumes certain conditions and requires inputs specified by RESNET. The actual energy efficiency of your home as built, and your energy use, will vary depending on, among other things, occupancy, location, orientation, and specific as-built features and characteristics, and may be higher or lower than the HERS Index score shown above. Masco Home Services, Inc. does not guarantee the actual HERS Index score for the home as built. The HERS® Index is a registered trademark of RESNET.



Green is Good in Houston

Check it out — you decide...

WHAT?	WHY?	David Weekley EnergySaver™ Home	10-year Old Home	Competition
SEER Rating HVAC System	Higher number = More efficient This means less energy dollars out of your pocket.	16	10	
Ultra Efficient 2-Stage HVAC System	Usually an upgrade with builders; helps de-humidify the home by running at slower speeds, which also saves on your pocketbook.	YES!	NO	
Vinyl Windows and Low-E2 Glass	Windows are a huge energy drain. Vinyl-framed, Low-E2 windows deflect much more of the Texas sun, resist sweating and humidity, and don't radiate heat like metal windows.	YES! and YES!	NO and NO	
WaterSense® Commodes, Showerheads and Vanity Faucets	Less water usage equates to a lower water bill.	YES!	NO	
R-Value Ceiling Insulation	Higher number = Less outside heat comes into your home Less outside heat means less use of your air conditioning, saving you money.	38	30	
R-Value Wall System	Higher number = Less outside heat comes into your home Again, you can save energy by keeping outside heat where it belongs — outside!	22	11	
Air Conditioning Filters	Higher = Better filtration A higher number indicates a more efficient filtering of the air in your home.	11	3	
Mold Resistant Shower and Tub Walls	HardieBacker® Cement Board and anti-fracture coatings (No drywall or greenboard allowed in wet areas.)	YES! and YES!	NO and NO	
Fresh Air System	Better air quality. Air can become stale. In tighter environments with reduced drafts, a fresh air system helps you live better in your home.	YES!	NO	
Draft Elimination	The amount of air that leaks through your walls, doors and ceiling on an hourly basis. (Lower number is better — the less air that leaks, the less you need to stabilize the temperature with your HVAC system.)	25%	50%	
Formaldehyde-free Insulation	A better, less toxic insulation for your home.	YES!	NO	
Inspection	Uses an infrared camera to certify that the insulation in your new home is in place correctly and has not fallen down. This camera also ensure there have been no leaks in your walls.	YES!	NO	

David Weekley Homes
EnergySaver

David Weekley EnergySaver™ Homes is a trademark of Weekley Homes, LLC, which describes certain features and criteria designed to reduce energy consumption and the resulting environmental impact. It does not infer sponsorship, approval, or affiliation with any other program or green building certification other than those specifically stated in the product features, warranty or contract. Environment For Living® is a registered service mark of Masco Home Services, Inc. Allelectric homes may not currently qualify for Environment For Living certification or the heating and cooling usage guarantee. U.S. Department of Energy. ENERGY STAR® and the ENERGY STAR mark are registered U.S. marks. ENERGY STAR is a registered mark owned by the U.S. government. See a David Weekley Homes Sales Consultant for details. Prices, plans, dimensions, features, specifications, materials, and availability of homes or communities are subject to change without notice or obligation. Illustrations are artist's depictions only and may differ from completed improvements. Copyright © January 2014 David Weekley Homes - All Rights Reserved. Houston, TX (HOUF54785)





Green is Good!

Advanced Framing in Houston

"Advanced Framing, as the name implies, is the intelligent use of lumber in wood framing. This unique application saves on lumber, supports better insulation and reduces the occurrence of drywall cracking - giving you a stronger, more energy-efficient home."

- Joseph Lstiburek, Ph.D., P. Eng., Building Science, Inc.

Other Builder's Typical Framing

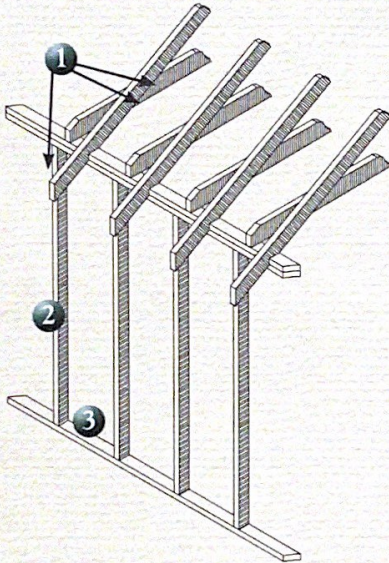

1. **Old-fashioned Engineering**
Framing members do not align, resulting in uneven load or weight distribution.
2. **2x4 Wall Framing**
Customary framing offers less space for insulation.
3. **Wall Insulation**
4" insulation cavity only allows for maximum of R-13 rated wall insulation.

Advanced Framing

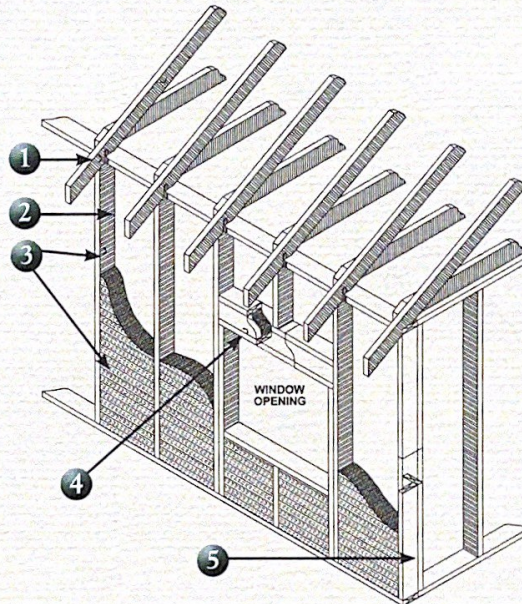

1. **Stacked Framing**
The components of the frame align on top of each other which efficiently transfers the load or weight down to the foundation, increasing the home's strength.
2. **Drywall Clips**
Used throughout the frame of the home to improve stability and minimize drywall cracking.
3. **Durable 2x6 Wall Framing/Increased Wall Insulation**
The thickness of the wall is increased by 50%, enabling us to add almost 50% more insulation to improve the home's energy efficiency. In addition, it also decreases the sound that comes through your wall: thicker insulation = a quieter home.
4. **Enhanced Window Header**
The "C-shaped" headers on exterior walls allow us to install insulation in areas that we've never been able to insulate before, which makes the home tighter and can lower utility costs.
5. **Innovative 2-stud Cornering**
Allows for insulating corners not found in standard framing.

David Weekley Homes
Energy Saver



"David Weekley EnergySaver™ Homes" is a trademark of Weekley Homes, LLC, which describes certain features and criteria designed to reduce energy consumption and the resulting environmental impact. It does not infer sponsorship, approval, or affiliation with any other program or green building certification other than those specifically stated in the product features, warranty or contract. Environments For Living® is a registered service mark of Masco Home Services, Inc. All electric homes may not currently qualify for Environments For Living certification or the heating and cooling usage guarantee. U.S. Department of Energy. ENERGY STAR® and the ENERGY STAR mark are registered U.S. marks. ENERGY STAR is a registered mark owned by the U.S. government. See a David Weekley Homes Sales Consultant for details. Prices, plans, dimensions, features, specifications, materials, and availability of homes or communities are subject to change without notice or obligation. Illustrations are artist's depictions only and may differ from completed improvements. Copyright © August 2013 David Weekley Homes - All Rights Reserved. Houston, TX (HSTO51432)



An ENERGY STAR[®] Qualified Home

This certifies that the home built at

10810 SLUMBERING FALLS LN, CYPRESS, TX 77433

by **DAVID WEEKLEY HOMES**

and verified by **ENVIRONMENTS FOR LIVING**

meets ENERGY STAR guidelines for energy efficiency as established by the U.S. Environmental Protection Agency.

ENERGY STAR qualified homes protect the environment by using less energy.

Hers 56

March 10, 2015

www.energystar.gov



Going Green

Never has it made more sense.

Just about everything. But here are some big differences.

Environments For Living® Diamond Level Program

ENERGY STAR® 3.0 Certified

Home Energy Rating System (HERS®)

The HERS Index is a scoring system established by the Residential Energy Services Network (RESNET®) that measures the energy performance of a home, and is used to compare the relative energy efficiency of different homes. The lower your home's HERS Index, the more energy efficient it is. A David Weekley EnergySaver home in Houston averages a 58 on the HERS Index!

Radiant Barrier

Our radiant barrier decking (under shingled roofs) keeps your attic cooler by deflecting heat from the sun. A cooler attic environment improves the operating efficiency of your air conditioning system.

This helps lower your utility usage.

Infrared Scan

Like an MRI, this identifies hidden moisture or energy efficiency issues affecting your home.

Energy-efficient Lighting

Compact Fluorescent Lighting (CFL) uses approximately 75% less energy, produces about 25% of the heat of a standard light bulb and lasts about six times longer.

Third-party Inspections

The more eyes, the better. We perform unbiased inspections on your wall insulation, thermal envelope and HVAC ductwork prior to drywall installation. As part of the inspection process, your home will receive an *Environments For Living* energy audit which utilizes a thermal bypass inspection, a duct blaster and blower door test. The duct blaster test is performed on your HVAC's ductwork before drywall is installed to verify duct leakage is equal to or less than 3%, one of the key components ensuring your home qualifies for *Environments For Living* Energy-Efficient Certification. A blower door test is done after drywall is installed to check the air tightness of the home.