

- IF CONSTRUCTION OR A DIVISION OF SUBJECT TRACT IS PROPOSED AND IF TRACT LIES IN THE CITY OF HOUSTON OR ITS EXTRATERRITORIAL JURISDICTION, PLATING AND OTHER REQUIREMENTS MAY APPLY PER CITY OF HOUSTON ORDINANCES.
 - THE SURVEYOR HAS NOT ABSTRACTED THE SUBJECT PROPERTY.
 - ALL BEARINGS SHOWN ARE REFERENCED PER RECORDED PLAT OF SAID SUBDIVISION.

| | | | | | |
|---|----------------|---|--|---------------|---------------|
| LEGAL: LOT 6 | | BLOCK: 3 | SUBDIVISION: REPLAT OF WINDSOR PARK ESTATES | | SECTION: 1 |
| COUNTY: HARRIS | STATE TEXAS | RECORDATION: VOLUME 345 PAGE 57 H.C.M.R. | SURVEY: FIELD WORK: 8-8-00/PD | SCALE: 1"=30' | |
| PURCHASER: KENNETH P. KRAMER and MARI LEE KRAMER | | | DRAFTING: 8-11-00/BB | KEY MAP: 486H | |
| ADDRESS: 1610 CAMBRIDGE OAKS CIRCLE, HOUSTON, TEXAS | | | | | |

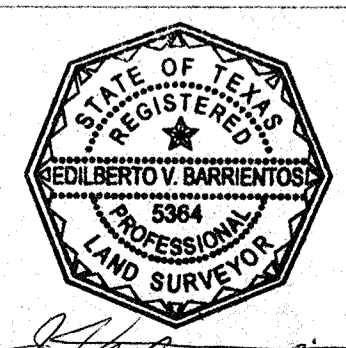

ALITEX
 REALTY SERVICES
 REAL ESTATE SURVEY DIVISION
 9610 LONGPOINT, SUITE 150
 HOUSTON, TEXAS 77055
 TEL: (713) 468-7707
 FAX: (713) 468-8815



* SUBJECT PROPERTY - IS NOT - LOCATED IN A FEDERAL INSURANCE ADMINISTRATION DESIGNATED FLOOD HAZARD AREA ZONE "X" AS PER MAP 480287 PANEL 0615J DATED: NOV. 6, 1996

* This information is based on graphic plotting only. We do not assume responsibility for exact determination.

I DO HEREBY CERTIFY THAT THIS SURVEY WAS THIS DAY MADE ON THE GROUND OF THE PROPERTY LEGALLY DESCRIBED HEREON IS CORRECT AND THERE ARE NO ENCROACHMENTS UNLESS SHOWN HEREON.

| | |
|------------|--------------------|
| MORT. CO.: | MILESTONE MORTGAGE |
| TITLE CO.: | CHICAGO TITLE CO. |
| C.F. No.: | 259135 |
| JOB No.: | 00-31245 |
| REV. DATE: | - |

NOTES:
 1.) RESTRICTIVE COVENANTS AS SET OUT IN SCHEDULE "B", ITEM 1, OF TITLE REPORT.
 2.) H.L. & P. COMPANY AGREEMENT BY H.C.C.F. NO. J759001.