

SKETCH ADDENDUM

Borrower or Owner	Phillip & Valerie Judd		
Property Address	1 Strawberry Ln.		
City	Montgomery	County	Montgomery
		State	TX
		Zip Code	77356
Client	Phillip & Valerie Judd		

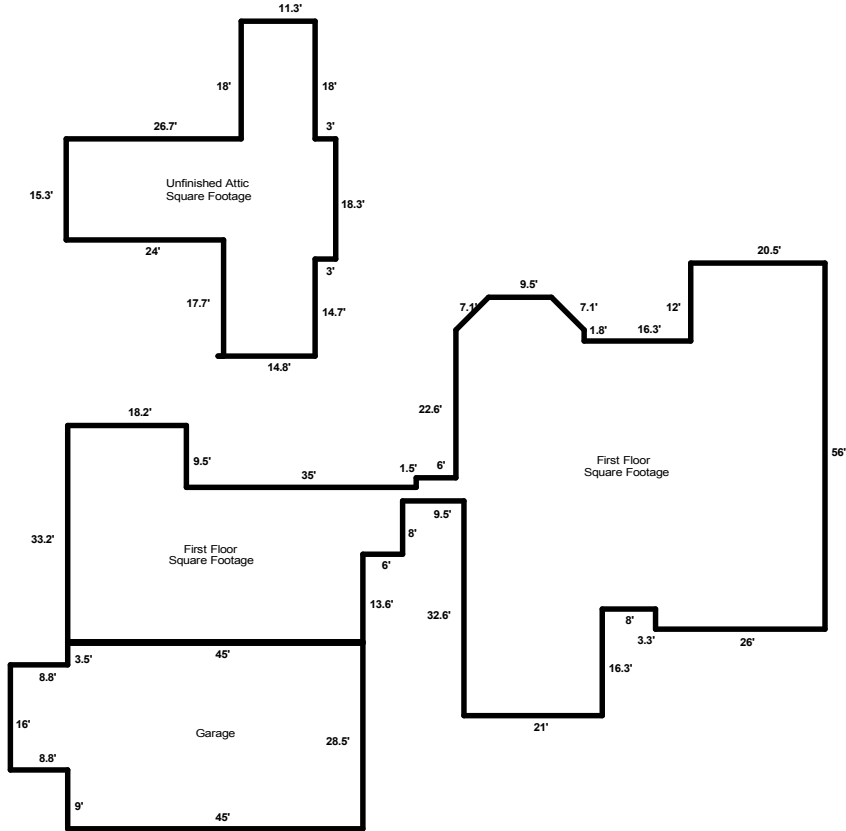

SUMMARY	SQ FT AREA	PERIMETER	AREA CALCULATION DETAILS
Living Area			First Floor
First Floor	4378	446	20.5 X 12.0 = 246.0
			14.5 X 5.0 = 72.5
Other			19.5 X 1.8 = 35.1
Unfinished Attic	1087	186	56.3 X 20.8 = 1171.0
			18.2 X 9.5 = 172.9
Garage/Carport			62.3 X 1.5 = 93.4
Attached Garage	1423	165	115.5 X 2.1 = 242.5
			55.0 X 16.3 = 896.5
			51.0 X 8.0 = 408.0
			45.0 X 13.6 = 612.0
			26.0 X 3.3 = 85.8
			21.0 X 16.3 = 342.3
			Total 4378.0